



BAYLIGHTER®

EBY 150 SERIES



ENCLUSED HIGH BAY LUMINAIRE

ORDERING INFO SYSTEM DATA DRIVER OPTIONS SENSOR OPTIONS PHOTOMETRIC DATA

INTERACTIVE BUTTONS

JOB	
TYPE	
DATE	

WWW.LALIGHTING.COM
626-454-8300

SURFACE / SUSPENSION / PENDANT MOUNTED HIGH BAY LED LUMINAIRE



APPLICATIONS

- Commercial, Industrial, Warehouse

FEATURES

- High (HT) Ambient temperature version available for extreme temperature ranges
- 0-10V dimming driver standard
- Supports California Title 24 compliance
- Safety cables attached to door frame and LED gear tray

OPTIONS

- Customization available upon request
- Additional lumen packages and color temperatures
- (Wireless) Controls and sensors
- Variety of Lenses
- Custom Housing Colors
- Emergency battery pack
- 11 ga. wire guard available
- Cable suspension systems and pendant mounting adapter available
- Hub and fixture stabilizer

SPECIFICATIONS

CONSTRUCTION

- 22 ga. cold rolled steel housing with louvered vents for heat removal (20 ga. C.R.S. and 0.040 aluminum housing available as specified)
- 20 ga. cold rolled steel door frame secured by T-hinges and positive spring loaded latches
- One-way polyurethane gasket standard

FINISH

- Baked white polyester finish (powder coated finish available) / minimum reflectance 86%

OPTICAL

- Clear prismatic acrylic lens standard

ELECTRICAL

- High efficiency drivers coupled with long-life LEDs
- Service life tested at 50,000 hours (L70)
- Universal voltage 120V through 277V (347V / 480V available)
- Power Factor (PF) ≥ 0.9
- Total Harmonic Distortion (THD) $\leq 20\%$

LISTING

- UL USA and Canada listed / suitable for damp locations

WARRANTY

- 5-year limited warranty, 10-year limited warranty available



Los Angeles Lighting Mfg. Co.
 Contact Us
 T: 626-454-8300 10141 Olney Street
 F: 626-454-8399 El Monte, CA 91731
 www.lalighting.com Made in the USA



Due to continued product improvements and enhancements, Los Angeles Lighting Manufacturing Company reserves the right to alter specifications, dimensions, data, and/or materials without notice. Please visit our website to view the most current information.

© 2022 LOS ANGELES LIGHTING MANUFACTURING CO. ALL RIGHTS RESERVED.

Revised 11/11/20



ORDERING INFORMATION

EXAMPLE: EBY150-16-4L-PA2-BPL1.5-DRDM-UNV-2/850HT

[BACK TO TOP](#)

SERIES	LED LUMEN PACKAGE	EFFICACY	NOMINAL LENGTH	COLOR	OPTICAL / DOOR FRAME	MECHANICAL	ELECTRICAL	DRIVER	VOLTAGE	# OF LED ROW	CRI / CCT	AMBIENT TEMP.
EBY150									UNV			HT
EBY150 • Enclosed High Bay LED Luminaire	4-foot lengths 8 Nom. 8000lm 12 Nom. 12000lm 16 Nom. 12000lm *Additional Lumen Packages Available	(Blank) • Standard HE • High Efficacy Available Lumen Packages 4-foot only • 8000lm • 12000lm *HE cannot be combine with HT systems	4L • 4-foot	(Blank) • Standard White Housing BLK • Black Housing BZ • Bronze Housing	PA • Clear Prismatic Acrylic PA2 • Clear Prismatic Acrylic Nom. 0.125 FPA2 • Frosted Prismatic Acrylic Nom. 0.125 XX • No Door & Lens Assembly	GSKNx • Neoprene Gasket PAF • Painted After Fabrication HUB • Aluminum Die Cast Hub (Safety Cable Set Included) SMA • Pendant Mounting Adapter (Safety Cable Set Included) STA • Fixture Stabilizer *Leave Blank if Not Specified	BPL1.5 • Emergency Battery Pack, Constant Nom. 15000 lm MSxx • Motion Sensor *Leave Blank if Not Specified	DRDM • 0-10V Dimming Driver	UNV • 120V-277V	1 • 1 LED Rows 8000lm 2 • 2 LED Rows 12000lm - 16000lm	830 • 80+CRI / 3000K Color Temp. 835 • 80+CRI / 4000K Color Temp. 840 • 80+CRI / 4000K Color Temp. 850 • 80+CRI / 4000K Color Temp.	HT • High Ambient Temp. *HT cannot be combine with HE systems

MECHANICAL OPTIONS

ELECTRICAL OPTIONS

DRIVERS OPTIONS

SENSOR OPTIONS

OPTICAL OPTIONS

INTERACTIVE BUTTONS

CUSTOM COLORS

BLK - Matte Black

CS - Camaro Silver

BZ - Statuary Bronze

Variety of RAL colors available upon request.



DIMENSIONS

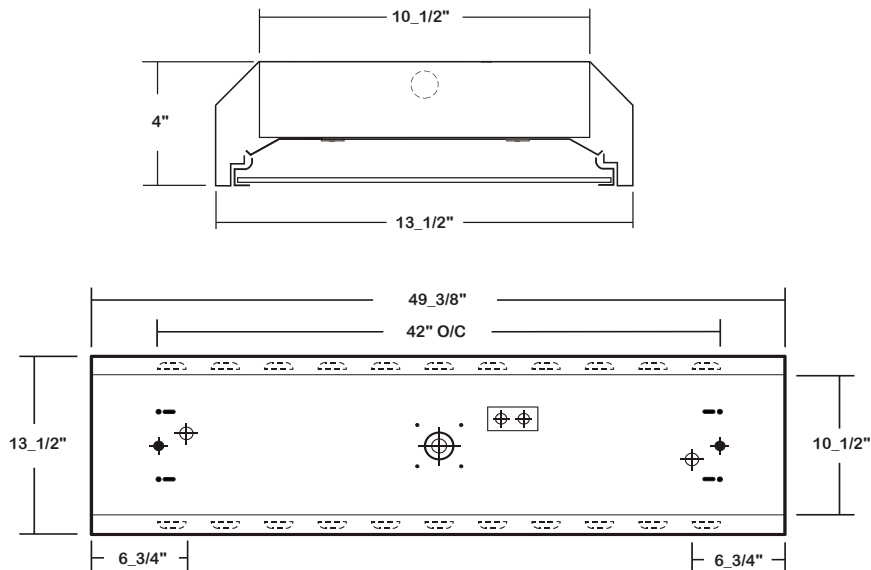

- ⊕ ACCESS PLATE
- ◆ 11/16" STEM MTG. K.O.
- ⊕ 2" K.O.
- ⊕ 7/8" OFFSET K.O.
- V-HOOK
- 3/16" K.O.



Los Angeles Lighting Mfg. Co.
 Contact Us
 T: 626-454-8300
 F: 626-454-8399
 www.lalighting.com
 10141 Olney Street
 El Monte, CA 91731
 Made in the USA



Due to continued product improvements and enhancements, Los Angeles Lighting Manufacturing Company reserves the right to alter specifications, dimensions, data, and/or materials without notice. Please visit our website to view the most current information.

© 2022 LOS ANGELES LIGHTING MANUFACTURING CO. ALL RIGHTS RESERVED.

Revised 11/11/20



4' - LED LUMEN PACKAGE	NORMAL AMBIENT TEMPERATURE PRODUCT CODE	DELIVERED LUMENS	SYSTEM WATTS	LUMINAIRE EFFICACY	AMBIENT TEMP.	FLUORESCENT EQUIVALENT	IES FILES
8000 Lumens (Nominal)	EB150-8-4L-PA-DRDM-UNV-1/850	6975	53.8	129.7 lm/W	-20°C / 35°C (-4°F / 95°F)	4-F32T8, 2-F54T5HO 175W MH	*
8000 Lumens (Nominal)	EBY150-8-4L-XX-DRDM-UNV-1/850	8231	53.8	153.0 lm/W	-20°C / 35°C (-4°F / 95°F)	4-F32T8, 2-F54T5HO 175W MH	*
12000 Lumens (Nominal)	EBY150-12-4L-PA-DRDM-UNV-2/850	9997	88.9	112.4 lm/W	-20°C / 35°C (-4°F / 95°F)	6-F32T8, 3-F54T5HO 250W MH	*
12000 Lumens (Nominal)	EBY150-12-4L-XX-DRDM-UNV-2/850	11797	88.9	132.6 lm/W	-20°C / 35°C (-4°F / 95°F)	6-F32T8, 3-F54T5HO 250W MH	*
16000 Lumens (Nominal)	EBY150-16-4L-PA-DRDM-UNV-2/850	13950	107.6	129.7 lm/W	-30°C / 50°C (-22°F / 122°F)	8-F32T8, 4-F54T5HO 400W MH	*
16000 Lumens (Nominal)	EBY150-16-4L-XX-DRDM-UNV-2/850	16463	107.6	153.0 lm/W	-30°C / 50°C (-22°F / 122°F)	8-F32T8, 4-F54T5HO 400W MH	*

4' - LED LUMEN PACKAGE	NORMAL AMBIENT TEMPERATURE (HIGH EFFICACY) PRODUCT CODE	DELIVERED LUMENS	SYSTEM WATTS	LUMINAIRE EFFICACY	AMBIENT TEMP.	FLUORESCENT EQUIVALENT	IES FILES
8000 Lumens (Nominal)	EBY150-8HE-4L-PA-DRDM-UNV-2/850	7142	51.8	137.8 lm/W	-20°C / 35°C (-4°F / 95°F)	4-F32T8, 2-F54T5HO 175W MH	*
8000 Lumens (Nominal)	EBY150-8HE-4L-XX-DRDM-UNV-2/850	7028	51.8	162.6 lm/W	-20°C / 35°C (-4°F / 95°F)	4-F32T8, 2-F54T5HO 175W MH	*
12000 Lumens (Nominal)	EBY150-12HE-4L-PA-DRDM-UNV-2/850	10595	79.3	133.7 lm/W	-20°C / 35°C (-4°F / 95°F)	6-F32T8, 3-F54T5HO 250W MH	*
12000 Lumens (Nominal)	EBY150-12HE-4L-XX-DRDM-UNV-2/850	12503	79.3	157.7 lm/W	-20°C / 35°C (-4°F / 95°F)	6-F32T8, 3-F54T5HO 250W MH	*

4' - LED LUMEN PACKAGE	HIGH AMBIENT TEMPERATURE PRODUCT CODE	DELIVERED LUMENS	SYSTEM WATTS	LUMINAIRE EFFICACY	AMBIENT TEMP.	FLUORESCENT EQUIVALENT	IES FILES
8000 Lumens (Nominal)	EBY150-8-4L-PA-DRDM-UNV-1/850HT	7153	51.8	138.0 lm/W	-30°C / 55°C (-22°F / 131°F)	4-F32T8, 2-F54T5HO 175W MH	*
8000 Lumens (Nominal)	EBY150-8-4L-XX-DRDM-UNV-2/850HT	8395	51.8	161.9 lm/W	-30°C / 55°C (-22°F / 131°F)	4-F32T8, 2-F54T5HO 175W MH	*
12000 Lumens (Nominal)	EBY150-12-4L-PA-DRDM-UNV-2/850HT	10612	79.3	133.9 lm/W	-30°C / 55°C (-22°F / 131°F)	6-F32T8, 3-F54T5HO 250W MH	*
12000 Lumens (Nominal)	EBY150-12-4L-XX-DRDM-UNV-2/850HT	12454	79.3	157.1 lm/W	-30°C / 55°C (-22°F / 131°F)	6-F32T8, 3-F54T5HO 250W MH	*
16000 Lumens (Nominal)	EBY150-16-4L-PA-DRDM-UNV-2/850HT	14246	107.6	137.9 lm/W	-30°C / 55°C (-22°F / 131°F)	8-F32T8, 4-F54T5HO 400W MH	LA-T3132
16000 Lumens (Nominal)	EBY150-16-4L-XX-DRDM-UNV-2/850HT	16394	107.6	152.4 lm/W	-30°C / 55°C (-22°F / 131°F)	8-F32T8, 4-F54T5HO 400W MH	*
24000 Lumens (Nominal)	EBY150-24-4L-PA-DRDM-UNV-2/850HT	21223	151.4	140.2 lm/W	-30°C / 55°C (-22°F / 131°F)	6-F54T5HO 400W MH	LA-T3128
24000 Lumens (Nominal)	EBY150-24-4L-XX-DRDM-UNV-2/850HT	20938	151.4	164.5 lm/W	-30°C / 55°C (-22°F / 131°F)	6-F54T5HO 400W MH	LA-T3127
32000 Lumens (Nominal)	EBY150-32-4L-PA-DRDM-UNV-2/850HT	29731	205.5	136.0 lm/W	-30°C / 55°C (-22°F / 131°F)	8-F54T5HO	LA-T3134
32000 Lumens (Nominal)	EBY150-32-4L-XX-DRDM-UNV-2/850HT	32789	205.5	159.6 lm/W	-30°C / 45°C (-22°F / 113°F)	8-F54T5HO	*

NOTE:

Actual performance may differ as a result of end-user environment and application.

HT: High Ambient Operating Maximum 55°C (48000 lumens, No Lens)

Normal: This fixture has been tested and listed in accordance with UL Standards. L.A. Lighting certifies that it will operate safely when installed properly, and within an ambient temperature range from -20°C to 35°C.

Additional lumen packages and color temperatures available.

DesignLights Consortium (DLC):

Due to constant updates on this product, please visit the [DLC QPL Website](#) for the most accurate system data and information

System data is based on 120V input voltage. DLC system data based on DLC testing parameters. Actual performance may differ as a result of the end-user environment and application.

Current DLC Listed Luminaires:



Los Angeles Lighting Mfg. Co.
 Contact Us
 T: 626-454-8300
 F: 626-454-8399
 www.lalighting.com
 10141 Olney Street
 El Monte, CA 91731
 Made in the USA



Due to continued product improvements and enhancements, Los Angeles Lighting Manufacturing Company reserves the right to alter specifications, dimensions, data, and/or materials without notice. Please visit our website to view the most current information.

© 2022 LOS ANGELES LIGHTING MANUFACTURING CO. ALL RIGHTS RESERVED.

Revised 11/1/20



DRIVER OPTIONS

BATTERY PACK OPTIONS

[BACK TO TOP](#)

PLEASE CONSULT FACTORY TO SEE IF YOUR SELECTED DRIVER OPTION WORKS WITH THIS FIXTURE.

PLEASE CONSULT FACTORY TO SEE IF YOUR SELECTED BATTERY PACK OPTION WORKS WITH THIS FIXTURE.

LED EMERGENCY BATTERY PACKS
(Operate for 90 minutes unless otherwise specified)

DRDM () UNV

VOLTAGE

- 120V** 120 Volt
- 277V** 277 Volt
- UNV** Universal 120-277 Volt *
- 347V** 347 Volt
- 480V** 480 Volt

TY

TY 10-Years Limited Warranty

DRIVER TYPE

- DRDM** 0-10V Dimming Driver *
- DRDM1** 0-10V Dimming Driver, 1% Dimming
- DRDM2C** 2-Channel 0-10V Dimming Driver (for Color Tunable White)
- DR2W** 2-Wire Phase Dimming Driver
- DRDA** Digital Addressable DALI Dimming Driver
- DRDA2C** Digit Digital Addressable DALI Type8 2-Channel Driver (for Color Tunable White)
- DRDA2.0** Digital Addressable DALI 2.0 Dimming Driver
- DRDA2.02C** Digital Addressable DALI 2.0 Type8 2-Channel Driver (for Color Tunable White)
- DRSD** Step Dimming Driver
- DR(LTEA2W)** Lutron® 2-Wire 1% Dimming Driver (120V Forward Phase only)
- DR(LDE1)** Lutron® EcoSystem 1% Soft-On, Fade-to-Black™ Dimming Driver
- DR(LDE5)** Lutron® EcoSystem 5% Dimming Driver
- DR(PEQ0E)** Lutron® EcoSystem 0.1% Soft-On, Fade-to-Black Dimming Driver
- DR(PSQ020)** Lutron® T-Series Digital 1% Dimming 2-Channel Driver (for Color Tunable White)
- DRCR** Control Ready Driver
- DRCR(DXL)** Osram Dexal Driver
- DRCR(SR)** Philips Sensor Ready Driver

BPL 1.5 (2H)

NOTE

2H 2 hours

LUMEN PACKAGE

- 0.7** Nominal 750 Lumens
 - 1.5** Nominal 1500 Lumens *
 - 3.0** Nominal 3000 Lumens
- *Additional lumen packages available*

TYPE

- (Blank)** Normal Ambient Temp. / Standard Operation
 - C** Cold Environment (-20°C)
 - F** With Flex for Remote Mounting
 - SL** Slim Casing
 - ST** Self Test / Diagnostic
- * Normal Stock Item*



Los Angeles Lighting Mfg. Co.
 Contact Us
 T: 626-454-8300 10141 Olney Street
 F: 626-454-8399 El Monte, CA 91731
 www.lalighting.com Made in the USA



Due to continued product improvements and enhancements, Los Angeles Lighting Manufacturing Company reserves the right to alter specifications, dimensions, data, and/or materials without notice. Please visit our website to view the most current information.

© 2022 LOS ANGELES LIGHTING MANUFACTURING CO. ALL RIGHTS RESERVED.

Revised 11/11/20



SENSOR OPTIONS

[BACK TO TOP](#)

DRY AND DAMP LOCATIONS - HIGH / LOW AISLE MOUNTING APPLICATIONS - END MOUNT

MS - Motion Sensor

- Turns light ON/OFF based on motion detection
- Fixture mounting height 8-45'
- Universal Voltage (120V-277V)
- 480V available

MSSD - Motion Sensor – Step Dimming

- Step-dims light to desired preset level (based on motion detection)
- Used in conjunction with 0-10V Ballast/Driver
- Fixture mounting height 8-45'
- Universal Voltage (120V-277V)

MSPC - Motion Sensor & Photocell

- Holds lights OFF when sufficient daylight is present regardless of motion detection
- Fixture mounting height 8-45'
- Universal Voltage (120V-277V)

MSPCD(ADC) - Motion Sensor & PhotoCell Dimming (Auto Dim Control)

- Variably dims output to desired preset footcandle level through photocell ON/OFF with motion detection
- Used in conjunction with 0-10V Ballast/Driver
- Fixture mounting height 8-45'
- Universal Voltage (120V-277V)

MSPCD(ANL) - Motion Sensor & Photocell Dimming (Auto Night Light)

- Variably dims output to desired footcandles through photocell
- Low setting when unoccupied (full on with motion)
- For 24 hour use
- Used in conjunction with 0-10V Ballast/Driver
- Fixture mounting height 8-45'
- Universal Voltage (120V-277V)

MSPCDR - Motion Sensor & Photocell Dimming (Setup with Remote Control)

- Field adjustable dimming sensor capabilities:
 - Step Dim (HIGH/LOW output)
 - Auto Dim Control (dim to desired footcandles, ON/OFF with motion)
 - Auto Night Light (dim to desired footcandles, LOW without motion)
- Used in conjunction with 0-10V dimming Ballast /Driver
- Holds lights OFF when sufficient daylight is present regardless of motion detection
- Adjustable ramp up and fade down time
- Fixture mounting height 8-40'
- Universal Voltage (120V-277V)
- Remote setup and adjustment with handheld wireless tool (sold separately)

PCS - Photocell Sensor

- Turns light ON/OFF based on light levels
- Fixture mounting height 8-45'
- Universal Voltage (120V-277V)

PCD - Photocell Dimming

- Dims output to desired footcandles through photocell
- Used in conjunction with 0-10V Ballast/Driver
- Fixture mounting height 8-45'
- Universal Voltage (120V-277V)

ACCESSORIES

[BACK TO TOP](#)

V6

- 6" Leg Height V-Hook
- Two (2) per fixture



WG11-HBN200

- 11 ga. Wire Guard
- Chrome epoxy powder coated finish

SMA

- Pendant Mounting Adapter
- 20 ga. die formed galvanized steel construction
- Die cast aluminum hub for 3/4" pipe pre-installed
- Designed for single point pendant mount applications

Note: Must request pre-punched holes from factory.

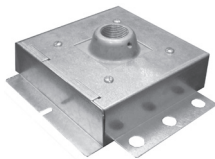

Cable Suspension System

- See [Mechanical Options](#) for additional Cable Suspension Systems

YTCS10

- Y-Toggle-End / Cable Suspension System

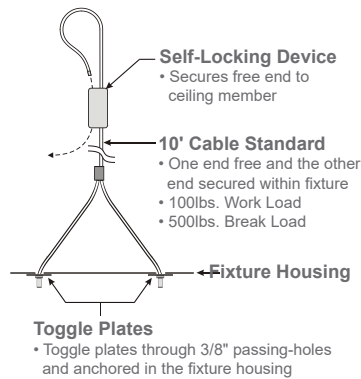

V6CS10

- V-Hook / Cable Suspension System
- Cable set with V6 hooks

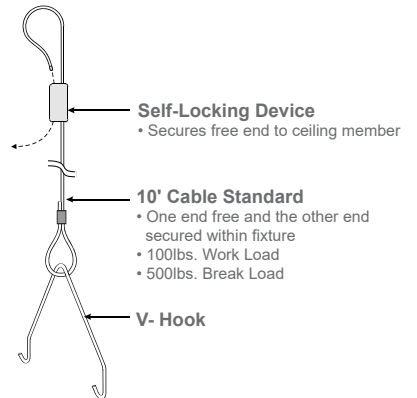

STA

- Fixture Stabilizer
- 18 ga. die formed cold rolled steel stabilizer for 3/4" pipe
- Designed for single point pendant mount applications to keep fixture body at a even level
- Works in conjunction with HUB and SMA
- Baked white powder coated finish



HUB

- Aluminum die cast hub with set screw for 3/4" pipe
- Safety cable included
- One (1) per fixture

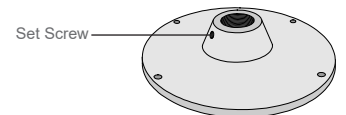

Los Angeles Lighting Mfg. Co.
 Contact Us
 T: 626-454-8300 10141 Olney Street
 F: 626-454-8399 El Monte, CA 91731
 www.lalighting.com Made in the USA



Due to continued product improvements and enhancements, Los Angeles Lighting Manufacturing Company reserves the right to alter specifications, dimensions, data, and/or materials without notice. Please visit our website to view the most current information.

© 2022 LOS ANGELES LIGHTING MANUFACTURING CO. ALL RIGHTS RESERVED.

Revised 11/11/20



PHOTOMETRIC DATA - EBY150 SERIES

EBY150-16-4L-PA-DRDM-UNV-2/850HT

TEST NO. = LA-T3132
 LED TYPE = 144 LED MODULE
 NO. OF MODULE = 2
 SYSTEM WATT (W) = 103.3
 CRI ≥ 80
 L70(Hrs.) ≥ 50,000
 PHOTOMETRY TYPE = C

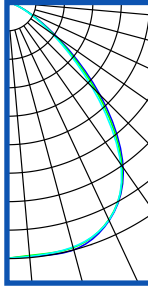

CANDLEPOWER			
ANGLE	END	45	CROSS
0	7143	7143	7143
5	7115	7093	7117
15	7154	7088	7070
25	6719	6696	6705
35	5630	5574	5516
45	3659	3512	3321
55	1698	1593	1514
65	627	605	577
75	179	174	169
85	26	26	23
90	1	1	1
95	0	0	0
105	0	0	0
115	0	0	0
125	0	0	0
135	0	0	0
145	0	0	0
155	0	0	0
165	0	0	0
175	0	0	0
180	0	0	0

ZONAL LUMEN SUMMARY			
DEGREES	LUMENS	% LAMP	% FIXTURE
0-30	5794	33.9	40.7
0-40	9295	55.4	65.2
0-60	13442	78.6	94.4
0-90	14246	83.3	100
90-120	0.3	0.0	0.0
90-150	0.3	0.0	0.0
90-180	0.3	0.0	0.0
0-180	14246	83.3	100.0

Luminaire Output = 14246 lumens
 Luminaire Efficacy = 137.9 lm/W
 Luminaire Efficiency = 83.3%

SPACING CRITERION	
ALONG	ACROSS
1.31	1.31

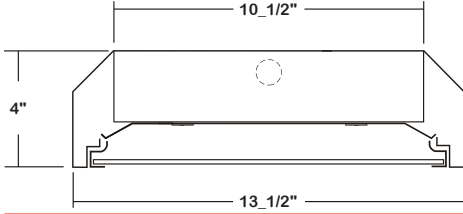

EBY150-24-4L-PA-DRDM-UNV-2/840HT

TEST NO. = LA-T3128
 LED TYPE = 144 LED MODULE
 NO. OF MODULE = 4
 SYSTEM WATT (W) = 151.4
 CRI ≥ 80
 L70(Hrs.) ≥ 50,000
 PHOTOMETRY TYPE = C

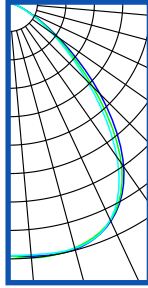

CANDLEPOWER			
ANGLE	END	45	CROSS
0	10733	10733	10733
5	10798	10870	10783
15	10834	10773	10792
25	10230	10182	10176
35	8489	8313	7991
45	5470	5041	4688
55	2544	2354	2193
65	928	885	832
75	267	254	247
85	40	38	34
90	2	1	1
95	0	0	0
105	0	0	0
115	0	0	0
125	0	0	0
135	0	0	0
145	0	0	0
155	0	0	0
165	0	0	0
175	0	0	0
180	0	0	0

ZONAL LUMEN SUMMARY			
DEGREES	LUMENS	% LAMP	% FIXTURE
0-30	8810	33.9	41.5
0-40	14009	53.9	66.0
0-60	20046	77.2	94.4
0-90	21224	81.7	100.0
90-120	0.4	0.0	0.0
90-150	0.4	0.0	0.0
90-180	0.4	0.0	0.0
0-180	21224	81.7	100.0

Luminaire Output = 21224 lumens
 Luminaire Efficacy = 140.2 lm/W
 Luminaire Efficiency = 81.7%

SPACING CRITERION	
ALONG	ACROSS
1.31	1.31

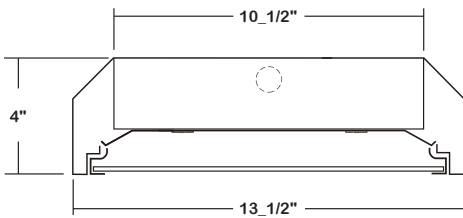

EBY150-32-4L-PA-DRDM-UNV-2/840HT

TEST NO. = LA-T3439
 LED TYPE = 144 LED MODULE
 NO. OF MODULE = 4
 SYSTEM WATT (W) = 205.5
 CRI ≥ 80
 L70(Hrs.) ≥ 50,000
 PHOTOMETRY TYPE = C

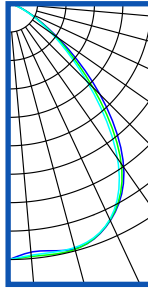

CANDLEPOWER			
ANGLE	END	45	CROSS
0	14342	14342	14342
5	13980	14226	14157
15	14225	14262	14156
25	13418	13382	13347
35	11195	10959	10587
45	7203	6639	6168
55	3326	3098	2907
65	1215	1157	1097
75	354	332	317
85	53	49	47
90	2	2	1
95	0	0	0
105	0	0	0
115	0	0	0
125	0	0	0
135	0	0	0
145	0	0	0
155	0	0	0
165	0	0	0
175	0	0	0
180	0	0	0

ZONAL LUMEN SUMMARY			
DEGREES	LUMENS	% LAMP	% FIXTURE
0-30	11578	33.9	41.5
0-40	18441	53.9	66.0
0-60	26388	77.2	94.5
0-90	27930	81.7	100.0
90-120	0.5	0.0	0.0
90-150	0.5	0.0	0.0
90-180	0.5	0.0	0.0
0-180	27931	81.7	100.0

Luminaire Output = 27931 lumens
 Luminaire Efficacy = 135.9 lm/W
 Luminaire Efficiency = 81.7%

SPACING CRITERION	
ALONG	ACROSS
1.31	1.31

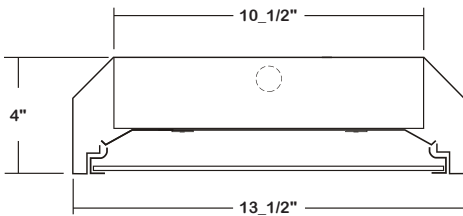

Los Angeles Lighting Mfg. Co.
 Contact Us
 T: 626-454-8300
 F: 626-454-8399
 www.lalighting.com
 10141 Olney Street
 El Monte, CA 91731
 Made in the USA



Due to continued product improvements and enhancements, Los Angeles Lighting Manufacturing Company reserves the right to alter specifications, dimensions, data, and/or materials without notice. Please visit our website to view the most current information.

© 2022 LOS ANGELES LIGHTING MANUFACTURING CO. ALL RIGHTS RESERVED.

Revised 11/11/20

