

**Climax Metal Products Company**

8141 Tyler Boulevard

Mentor, Ohio 44060

USA

Toll free: 800-542-6552

Phone: 440-585-0300

Fax: 800-860-5553

Email: sales@climaxmetal.comWebsite: www.climaxmetal.com

ITEM # G2SCC-050-037, TWO-PIECE INDUSTRY STANDARD CLAMPING COUPLINGS G2SCC-SERIES

Black Oxide Steel Two-Piece Industry Standard Clamping Coupling. High axial load & torque capacity. Does not mar the shaft.



[Drawing](#) | [Specifications](#) |

Drawing

Dimensional Drawing

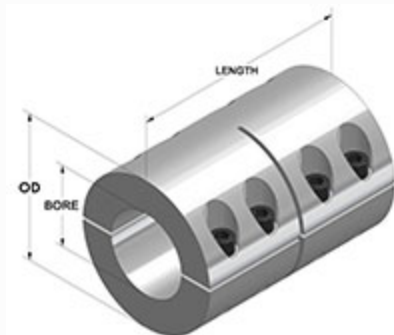

Two-Piece Industry Standard Clamping Coupling

Specifications

Bore	1/2 in
2nd Bore	3/8 in
OD	1 1/8 in
Length	1 3/4 in
Style	Two-Piece Clamp
Material	Steel, ASTM A108
Finish	Black Oxide
Clamp Screw	Hex Socket Cap Screw, 3A Thread, Steel, ASTM A574: 8-32 x 1/2
Approximate Weight	5.70 oz
UPC Code	044861040348

Competitor Part Number

Alternate Part Number	105463969 2478346 2CCF-1/2-3/8 8563169 G2SCC050037
------------------------------	--