



Climax Metal Products Company

8141 Tyler Boulevard
Mentor, Ohio 44060
USA

Toll free: 800-542-6552

Phone: 440-585-0300

Fax: 800-860-5553

Email: sales@climaxmetal.com

Website: www.climaxmetal.com

ITEM # G2SCC-075-050KW, TWO-PIECE INDUSTRY STANDARD CLAMPING COUPLINGS W/KEYWAY G2SCC-SERIES

Black Oxide Steel Two-Piece Industry Standard Clamping Coupling with Keyway. High axial load & torque capacity. Does not mar the shaft.



[Drawing](#) | [Specifications](#) |

Drawing

Dimensional Drawing

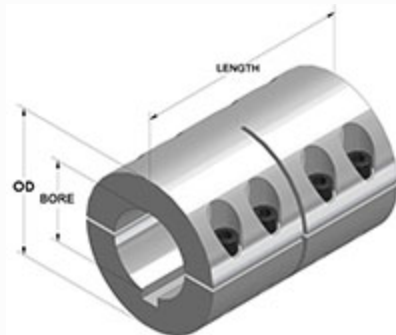

Two-Piece Industry Standard Clamping Coupling with Keyway

Specifications

Bore	3/4 in
2nd Bore	1/2 in
OD	1 1/2 in
Length	2 1/4 in
Style	Two-Piece Clamp
Keyway Size	3/16 x 3/32 in
Material	Steel, ASTM A108
Finish	Black Oxide
Clamp Screw	Hex Socket Cap Screw, 3A Thread, Steel, ASTM A574: 1/4-28 x 5/8
Approximate Weight	12.20 oz
UPC Code	044861040522

Competitor Part Number

Alternate Part Number	101480273 2CCF-3/4-1/2-K 8563184 G2SCC075050KW
------------------------------	---------------------------------------------------------