

PROJECT: _____	UNIT TAG: _____	QUANTITY: _____
REPRESENTATIVE: _____	TYPE OF SERVICE: _____	DATE: _____
ENGINEER: _____	SUBMITTED BY: _____	DATE: _____
CONTRACTOR: _____	APPROVED BY: _____	DATE: _____
	ORDER NO.: _____	DATE: _____



CR 32-3-2

Vertical, multistage centrifugal pump with suction and discharge ports on the same level. The pump head and base are in cast iron. All other wetted parts are in stainless steel (EN 1.4301)(AISI 304)

Product photo could vary from the actual product

Conditions of Service	Pump Data	Motor Data
Flow: 142 US gpm	Max pressure at stated temperature: 232 psi / 194 °F	Rated power - P2: 10 HP
Head: 192.1 ft	Liquid temperature range: 32 .. 194 °F	Rated voltage: 230 V
Efficiency: _____	Maximum ambient temperature: 104 °F	Main frequency: 60 Hz
Liquid: Water	Shaft seal: KUBV	Insulation class: F
Temperature: 68 °F	Product number: 29Z53047	Motor protection: CONTACT
NPSH required: 7.41 ft		Motor type: Baldor, TEFC
Viscosity: _____		Motor_efficiency: 85.5 %
Specific Gravity: 1.000		

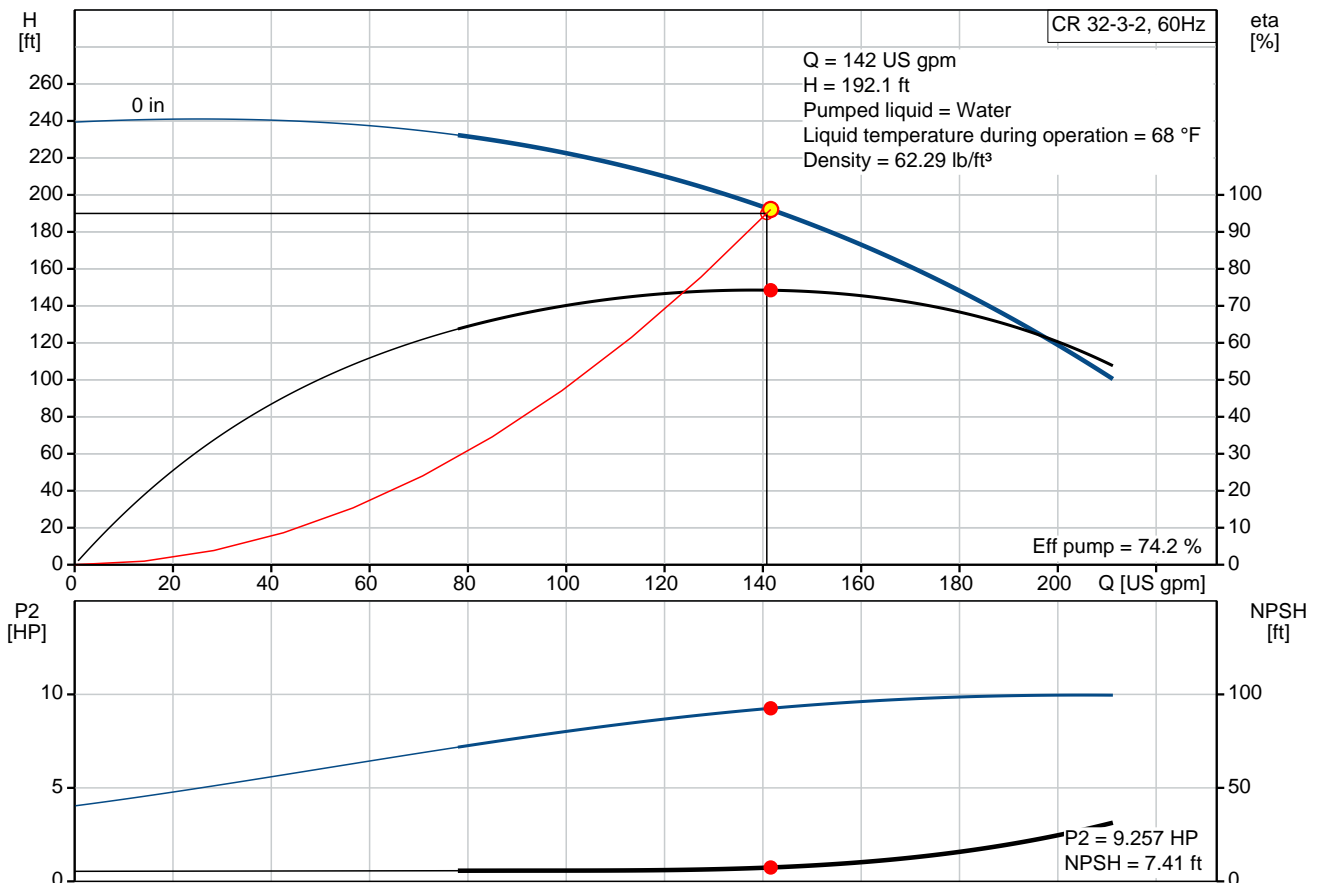

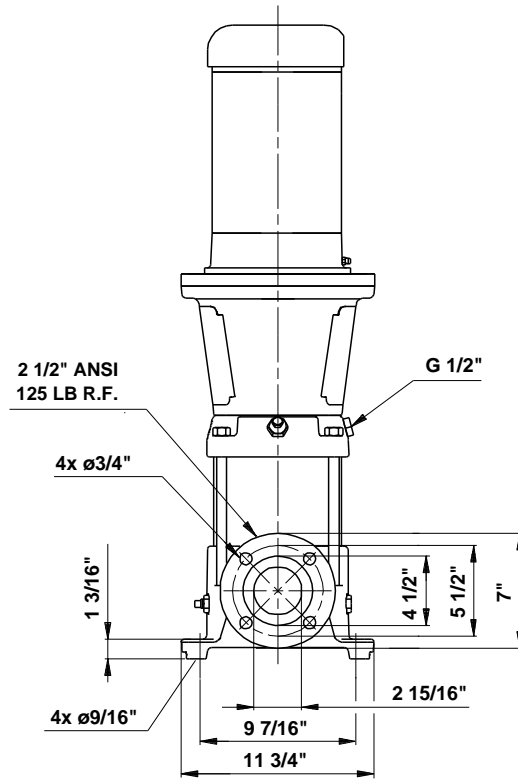
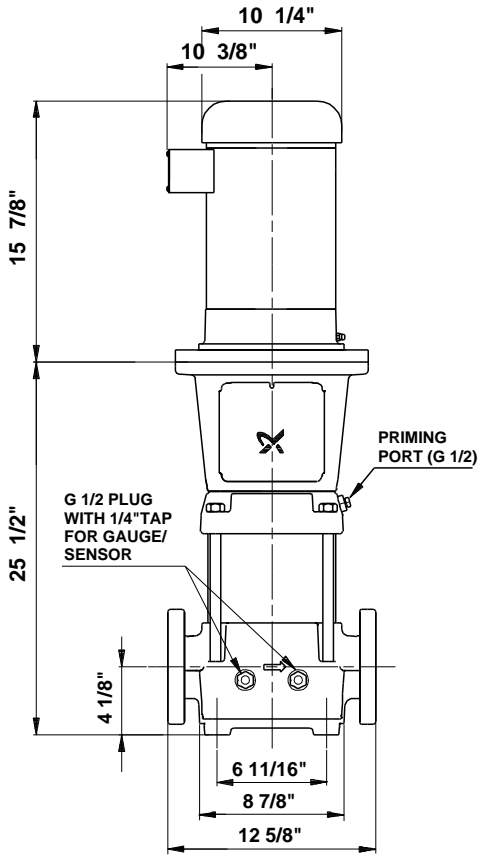

Materials:

- Base: Cast iron
EN-JS1050
80-55-06
- Impeller: Stainless steel
AISI 304
EN 1.4301
- Material code: A
- Code for rubber: V

Tender Text



Product No.: [29Z53047](#)

CR 32-3-2 U-G-A-V-KUBV

Vertical, non-self-priming, multistage, in-line, centrifugal pump for installation in pipe systems and mounting on a foundation.

The pump has the following characteristics:

- Impellers and intermediate chambers are made of
- The shaft seal has assembly length

according to EN 12756.

- Power transmission is via cast iron split coupling.

The motor is a 1-phase AC motor.

Liquid:

Pumped liquid: Water
Liquid temperature range: 32 .. 194 °F
Liquid temperature during operation: 68 °F
Density: 62.29 lb/ft³

Technical:

Actual calculated flow: 142 US gpm
Rated flow: 141 US gpm
Resulting head of the pump: 192.1 ft
Code for shaft seal: KUBV

Materials:

Base: Cast iron
EN-JS1050
80-55-06
Impeller: Stainless steel
EN 1.4301
AISI 304

Installation:

Maximum ambient temperature: 104 °F
Max pressure at stated temperature: 232 psi / 194 °F
Type of connection: ANSI
Size of suction port: 2 1/2" inch
Size of outlet port: 2 1/2" inch
Pressure rating: 125 Lb.
Flange size for motor: 213TC

Electrical data:

Motor type: Baldor, TEFC
Rated power - P2: 10 HP
Main frequency: 60 Hz



Company name:

Created by:

Phone:

Date:

2/20/2018

Rated voltage: 1 x 230 V
Service factor: 1,15
Rated current: 40 A
Cos phi - power factor: 0,97
Rated speed: 3525 rpm
Motor efficiency at full load: 85.5 %
Insulation class (IEC 85): F

Others:

Gross weight: 366 lb
Shipping volume: 12.7 ft³

Position	Count	Description
	1	<p>CR 32-3-2 U-G-A-V-KUBV</p>  <p>Product No.: 29Z53047 Vertical, non-self-priming, multistage, in-line, centrifugal pump for installation in pipe systems and mounting on a foundation.</p> <p>The pump has the following characteristics:</p> <ul style="list-style-type: none"> - Impellers and intermediate chambers are made of - The shaft seal has assembly length according to EN 12756. - Power transmission is via cast iron split coupling. <p>The motor is a 1-phase AC motor.</p> <p>Liquid: Pumped liquid: Water Liquid temperature range: 32 .. 194 °F Liquid temperature during operation: 68 °F Density: 62.29 lb/ft³</p> <p>Technical: Actual calculated flow: 142 US gpm Rated flow: 141 US gpm Resulting head of the pump: 192.1 ft Code for shaft seal: KUBV</p> <p>Materials: Base: Cast iron EN-JS1050 80-55-06 Impeller: Stainless steel EN 1.4301 AISI 304</p> <p>Installation: Maximum ambient temperature: 104 °F Max pressure at stated temperature: 232 psi / 194 °F Type of connection: ANSI Size of suction port: 2 1/2" inch Size of outlet port: 2 1/2" inch Pressure rating: 125 Lb. Flange size for motor: 213TC</p> <p>Electrical data: Motor type: Baldor, TEFC Rated power - P2: 10 HP Main frequency: 60 Hz Rated voltage: 1 x 230 V</p>



Company name:

Created by:

Phone:

Date:

2/20/2018

Position	Count	Description
		Service factor: 1,15 Rated current: 40 A Cos phi - power factor: 0,97 Rated speed: 3525 rpm Motor efficiency at full load: 85.5 % Insulation class (IEC 85): F Others: Gross weight: 366 lb Shipping volume: 12.7 ft ³



Company name:

Created by:

Phone:

Date:

2/20/2018

29Z53047 CR 32-3-2 60 Hz

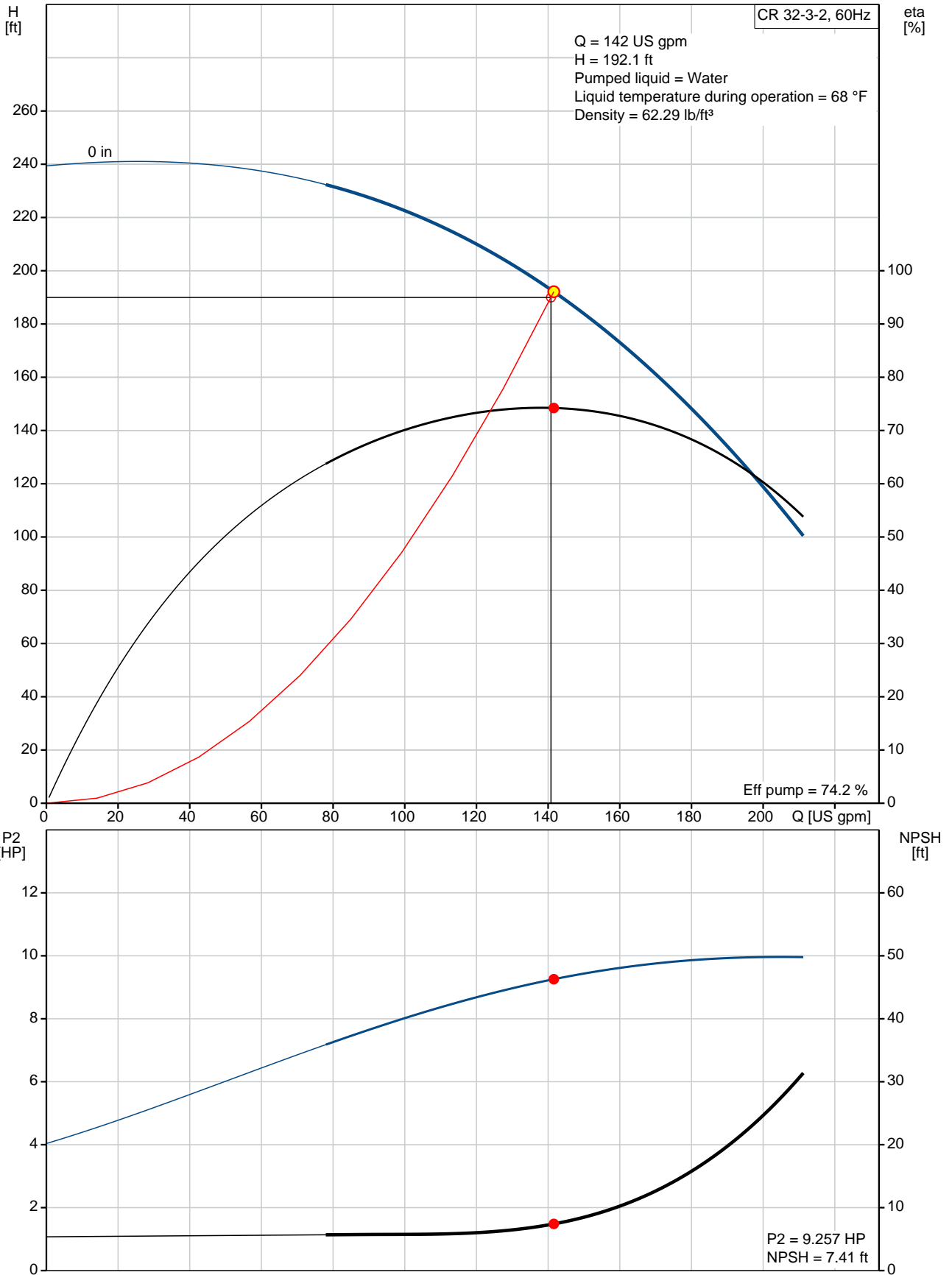

Description	Value
General information:	
Product name:	CR 32-3-2 U-G-A-V-KUBV
Product No.:	29Z53047
EAN:	5700394519885
Technical:	
Actual calculated flow:	142 US gpm
Rated flow:	141 US gpm
Resulting head of the pump:	192.1 ft
Stages:	3
Impellers:	3
Number of reduced-diameter impellers:	2
Low NPSH:	N
Code for shaft seal:	KUBV
Pump Number:	96418602
Pump version:	U
Model:	A
Cooling:	TEFC
Materials:	
Base:	Cast iron EN-JS1050 80-55-06
Impeller:	Stainless steel EN 1.4301 AISI 304
Material code:	A
Code for rubber:	V
Installation:	
Maximum ambient temperature:	104 °F
Max pressure at stated temperature:	232 psi / 194 °F
Type of connection:	ANSI
Connect code:	G
Size of suction port:	2 1/2" inch
Size of outlet port:	2 1/2" inch
Pressure rating:	125 Lb.
Flange size for motor:	213TC
Liquid:	
Pumped liquid:	Water
Liquid temperature range:	32 .. 194 °F
Liquid temperature during operation:	68 °F
Density:	62.29 lb/ft³
Electrical data:	
Motor type:	Baldor, TEFC
Rated power - P2:	10 HP
KVA code:	F
Main frequency:	60 Hz
Rated voltage:	1 x 230 V
Service factor:	1,15
Rated current:	40 A
Load current:	46 A
Cos phi - power factor:	0,97
Rated speed:	3525 rpm
Motor efficiency at full load:	85.5 %
Insulation class (IEC 85):	F

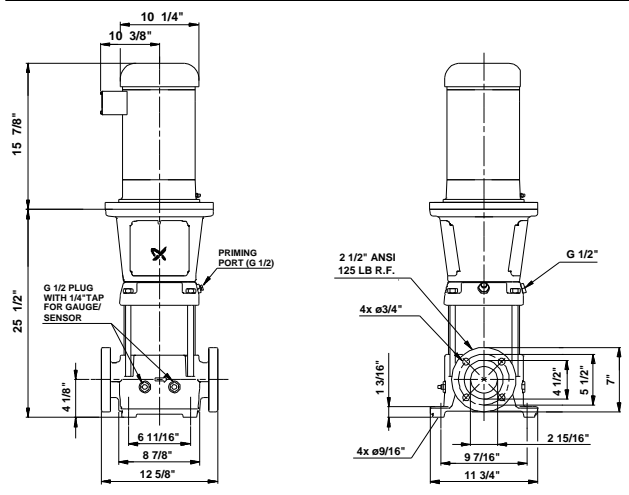
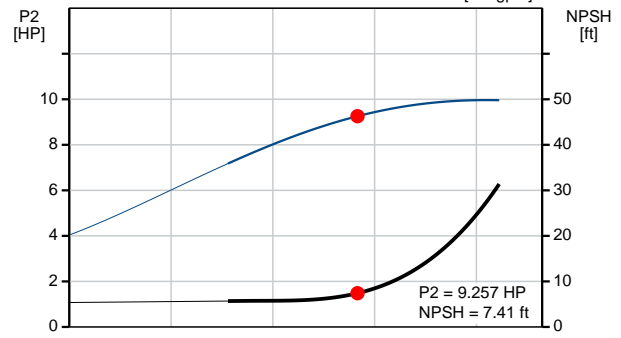
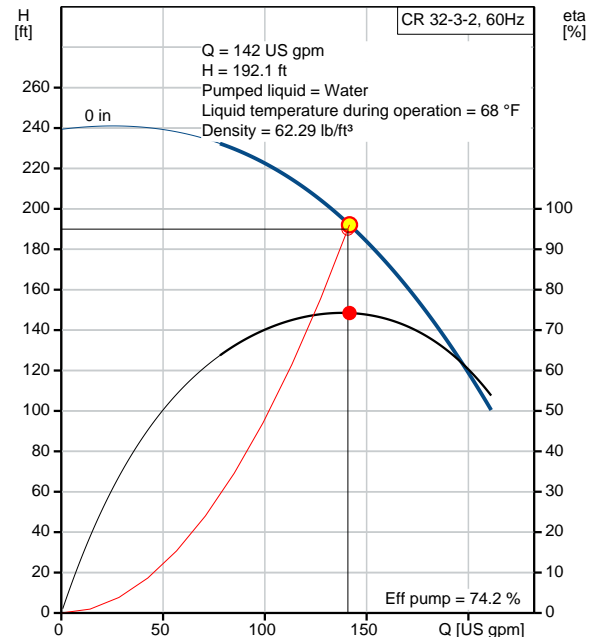



Company name:

Created by:

Phone:

Date: 2/20/2018

Description	Value
Motor protection:	CONTACT
Motor Number:	85700022
Others:	
Gross weight:	366 lb
Shipping volume:	12.7 ft ³
Sales region:	Namreg

29Z53047 CR 32-3-2 60 Hz

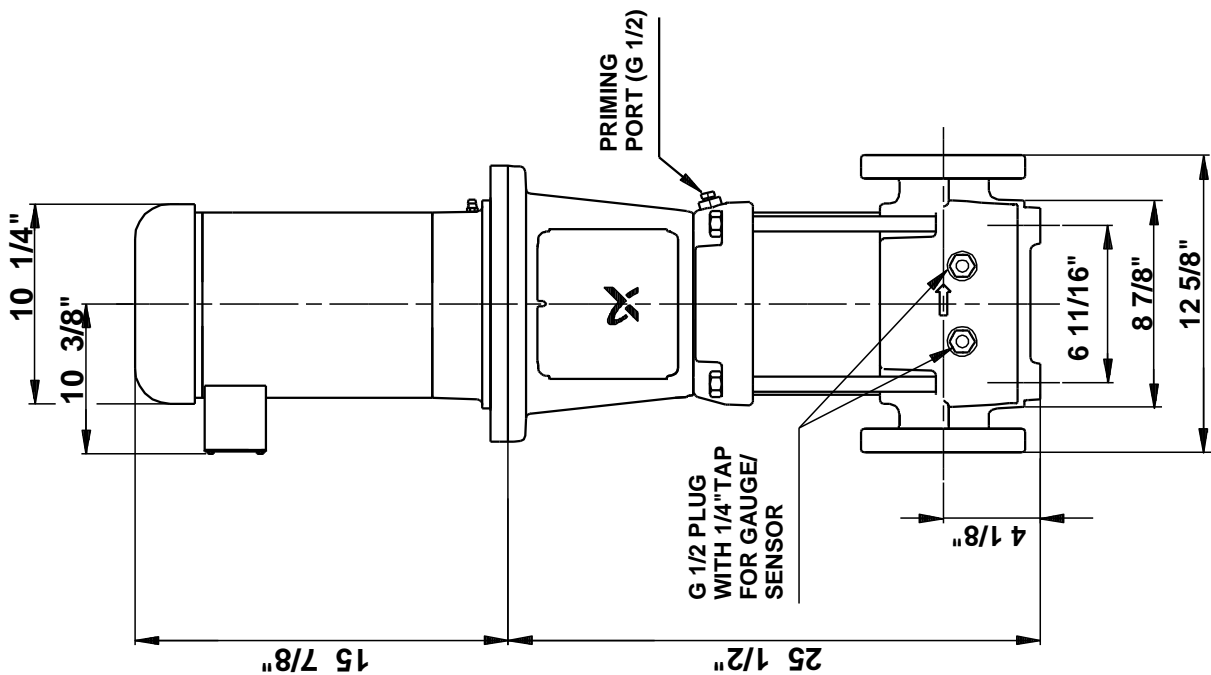
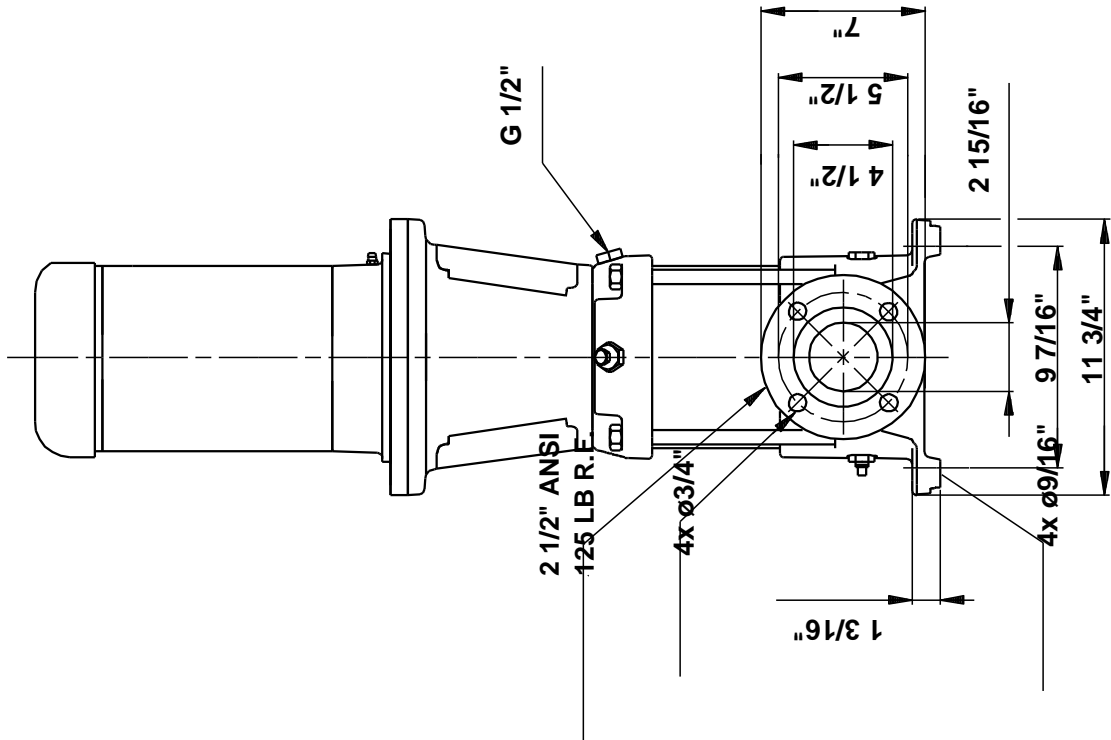

Note! All units are in [mm] unless otherwise stated.
Disclaimer: This simplified dimensional drawing does not show all details.



Company name:

Created by:

Phone:

Date: 2/20/2018

Order Data:

Product name: CR 32-3-2 U-G-A-V-KUBV

Amount: 1

Product No.: 29Z53047

Total: Price on request

Exploded view (TM065558 LACR)

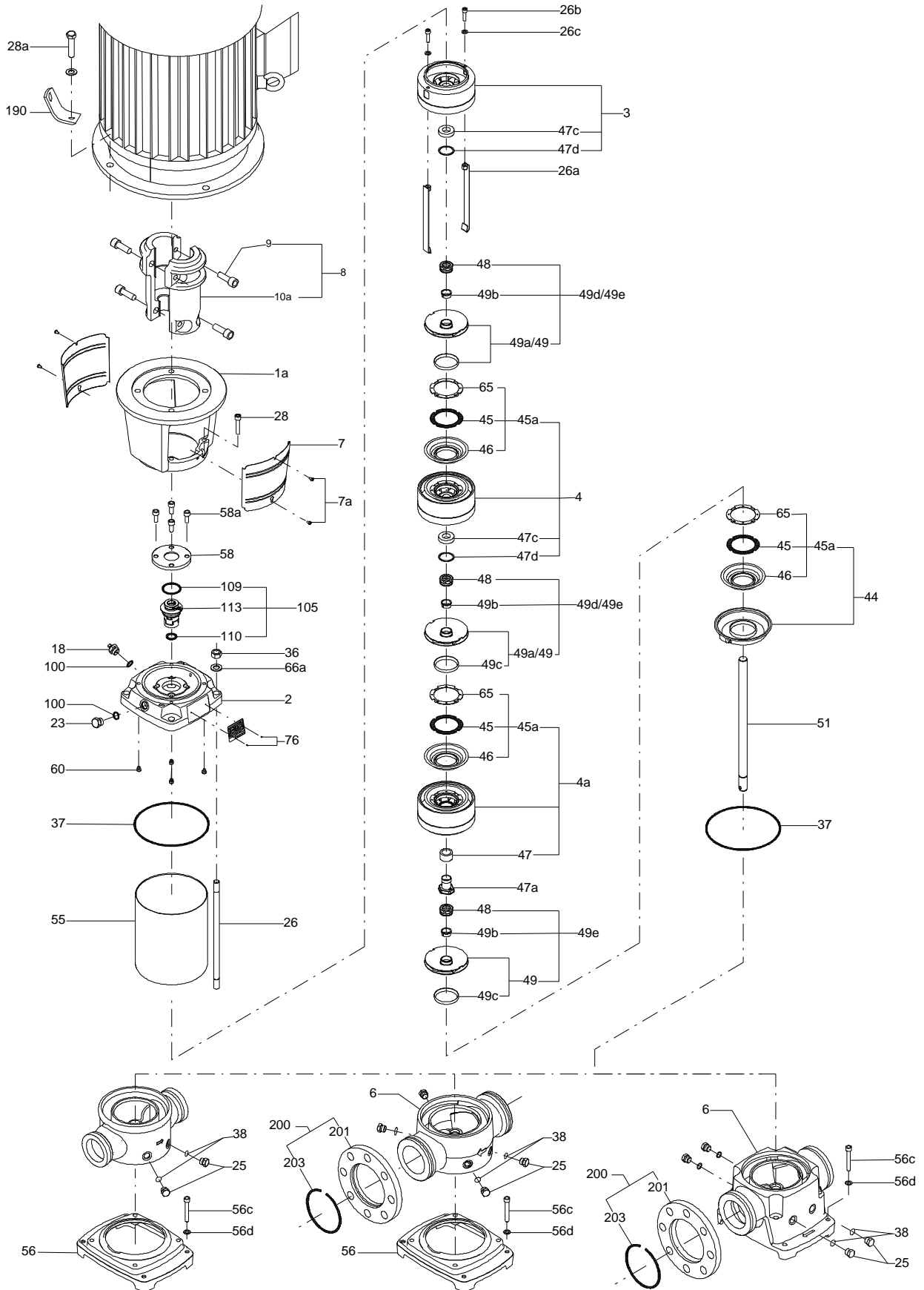

Sectional drawing (TM065571 LACR)

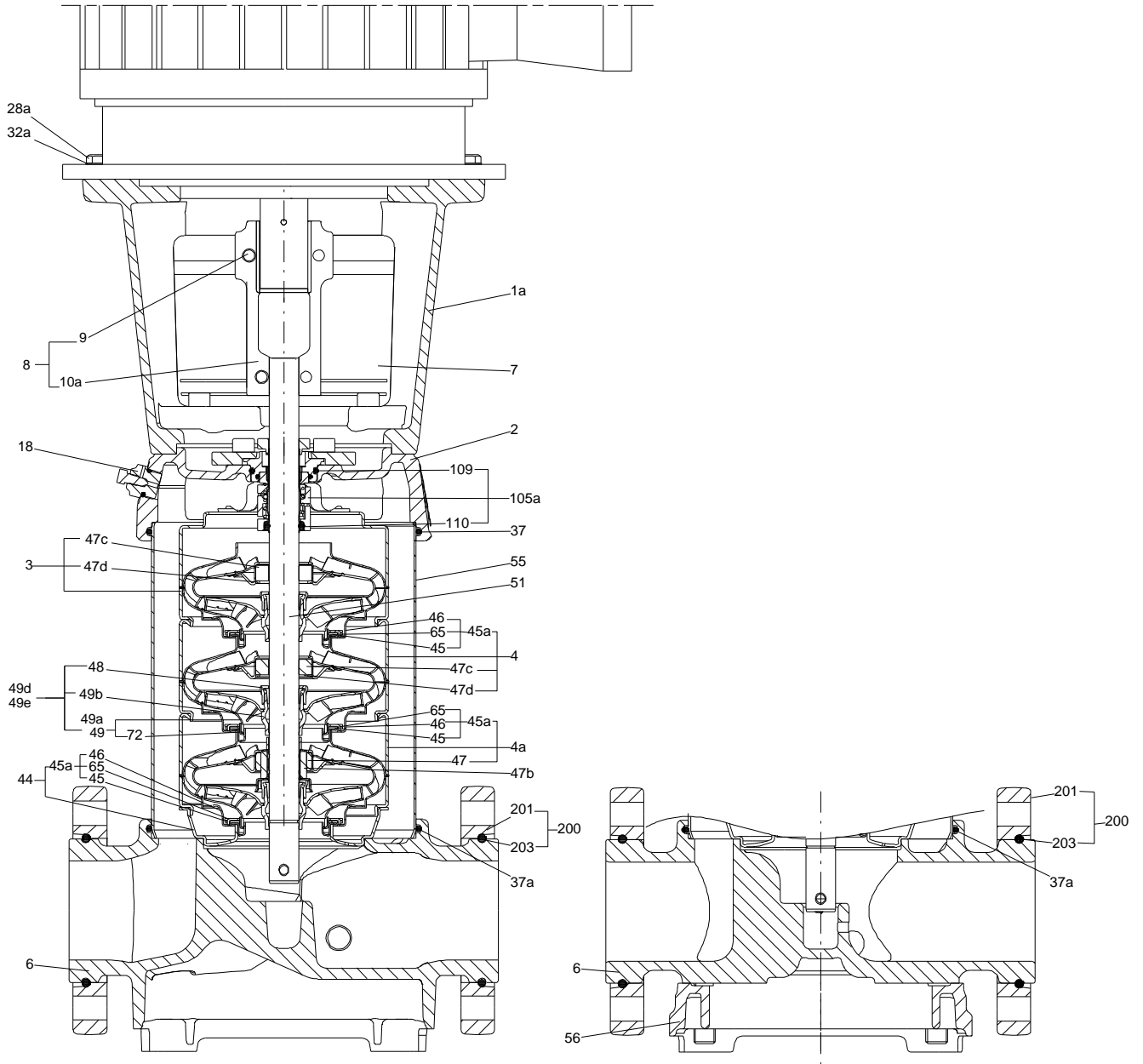

Parts list CR 32-3-2, Prod number 29Z53047

Valid from 3.3.2014 (1410)

Position	Description	Annotation	Classification data	Part No.	Count	Unit
	Motor				1	pcs
-	Flange cpl.				2	pcs
201	Flange				1	
203	Lock ring				1	
-	Motor stool cpl.				1	pcs
1a	Motor stool				1	
7	Coupling guard				2	
7a	Socket button head screw				4	
28	Hex socket head cap screw		Designation: DIN 912		4	
			Length: 50			
			Thread: M10			
- 1	Basic unit				1	pcs
- 2a	Pump head cpl.				1	
2	Pump head					
9	Hex socket head cap screw		Designation: DIN 912			
			Length: 25			
			Thread: M10			
- 18	Air vent screw					
	Plug					
	Spindle					
23	Plug					
37	O-ring		Diameter: 197			
			Material type: FKM			
			Thickness: 4			
58	Cover					
60	Spring					
100	O-ring		Diameter: 16,3			
			Material type: FKM			
			Thickness: 2,4			
- 6b	Base cpl.		Rubber type: FKM		1	
6	Base					
25	Plug					
32	Washer		Designation: DIN 125A			
			Inner diameter: 6,4			
			Outer diameter: 12,0			
			Thickness: 1,6			
37	O-ring		Diameter: 197			
			Material type: FKM			
			Thickness: 4			
38	O-ring		Diameter: 16,3			
			Material type: FKM			
			Thickness: 2,4			
26	Staybolt		Length: 356		4	
			Thread: M16			
36	Hex nut		Thread: M16		4	
55	Outer sleeve		Outer diameter: 197,0		1	
			Length: 235,5			
66a	Washer		Designation: DIN 125 A		4	
			Inner diameter: 17			
			Outer diameter: 30			
			Thickness: 3			
- 80	Chamber stack				1	
- 3	Upper chamber cpl.					

Position	Description	Annotation	Classification data	Part No.	Count	Unit
	Chamber					
	Guide					
	Cone					
	Guide cup					
	Guide cup					
3	Upper chamber cpl.					
47c	Bush					
47d	Lock ring					
- 4	Intermediate chamber cpl.					
	Chamber					
	Chamber					
	Guide					
	Cone					
	Guide cup					
	Guide cup					
- 45a	Neck ring cpl.					
45	Seal ring					
46	Neck ring					
65	Top f/neck ring					
47c	Bush					
47d	Lock ring					
- 4a	Intermediate chamber cpl.					
	Intermediate chamber cpl.					
- 45a	Neck ring cpl.					
45	Seal ring					
46	Neck ring					
65	Top f/neck ring					
47	Bearing					
26a	Strap cpl.		Thread: M8			
26b	Hex socket head cap screw					
26c	Washer		Designation: DIN 125A			
			Inner diameter: 8,4			
			Outer diameter: 16			
			Thickness: 1,6			
- 44	Suction interconnector coupling					
	Inlet part					
45	Seal ring					
46	Neck ring					
65	Top f/neck ring					
- 47a	Bearing cpl.					
	Disc spring					
	Bearing ring, rotating					
	Holder					
	Driver					
- 49d	Impeller cpl. reduced diameter					
48	Nut					
- 49	Impeller					
	Impeller hub					
49c	Wear ring					
49b	Split cone					
- 49e	Impeller cpl.					
48	Nut					
- 49	Impeller					
	Impeller hub					
49c	Wear ring					
49b	Split cone					
51	Shaft					
- 8	Coupling cpl.		Dimension: 22/34,9		1	pcs
9	Hex socket head cap screw		Designation: DIN 912		4	



Company name:

Created by:

Phone:

Date: 2/20/2018

Position	Description	Annotation	Classification data	Part No.	Count	Unit
			Length: 25			
			Thread: M10			
10a	Coupling half				2	
- 105	Shaft seal		Material type: HQQV		1	pcs
	Adjusting fork				1	
109	O-ring		Diameter: 44,45		1	
			Material type: FKM			
			Thickness: 3,53			
110	O-ring		Diameter: 21,5		1	
			Thickness: 4,25			