

PROJECT: _____	UNIT TAG: _____	QUANTITY: _____
REPRESENTATIVE: _____	TYPE OF SERVICE: _____	DATE: _____
ENGINEER: _____	SUBMITTED BY: _____	DATE: _____
CONTRACTOR: _____	APPROVED BY: _____	DATE: _____
	ORDER NO.: _____	DATE: _____



### CRN 1S-3

Vertical, multistage centrifugal pump with suction and discharge ports on same the level. Pump materials in contact with the liquid are in high-grade stainless steel (EN 1.4401) (AISI 316)

Product photo could vary from the actual product

Conditions of Service	Pump Data	Motor Data
Flow: _____	Max pressure at stated temperature: 363 psi / 250 °F	Rated power - P2: 0.33 HP
Head: _____	Maximum ambient temperature: 104 °F	Rated voltage: 115/230 V
Efficiency: _____	Approvals: CURUS,NSF61	Main frequency: 60 Hz
Liquid: Water	Shaft seal: HQQE	Insulation class: B
Temperature: 68 °F	Product number: On request	Motor type: BALDOR
NPSH required: ft		
Viscosity: _____		
Specific Gravity: 1.000		

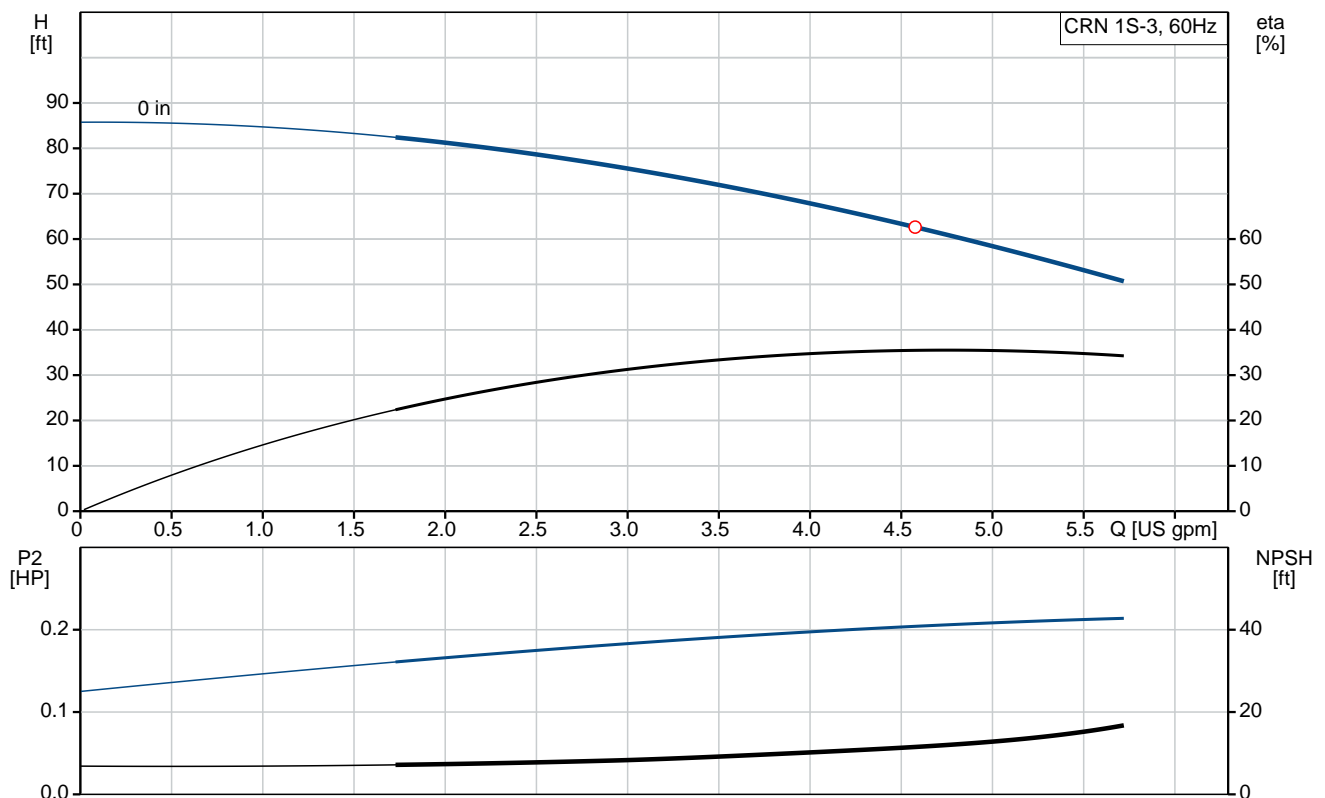

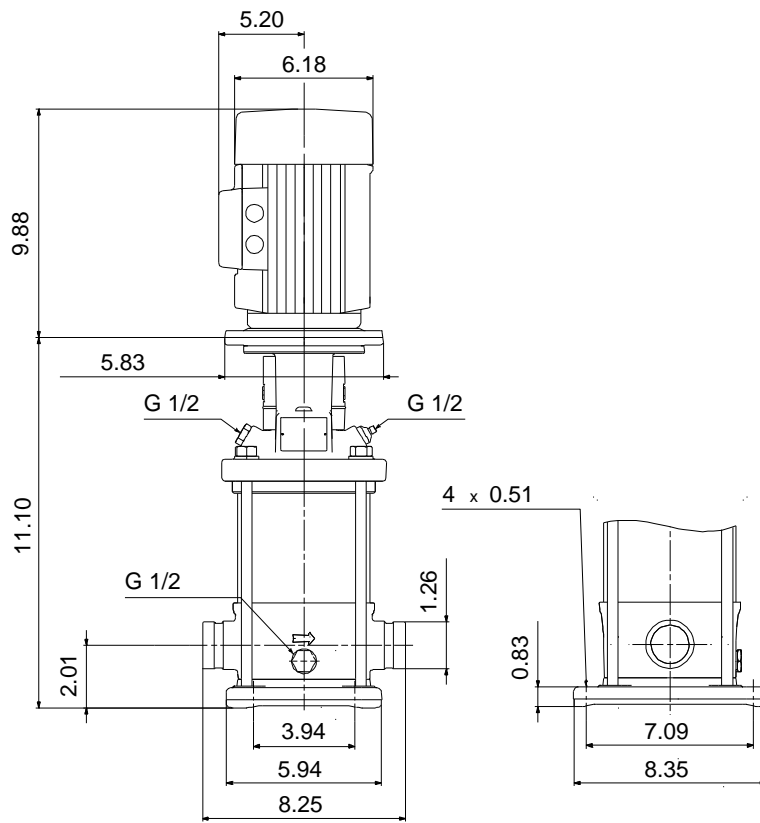

**Materials:**

Base: Stainless steel  
EN 1.4408  
AISI 316

Impeller: Stainless steel  
AISI 316  
EN 1.4401

Material code: G

Code for rubber: E

## Tender Text



Product No.: On request

### **CRN 1S-3 A-P-G-E-HQQE**

Vertical, non-self-priming, multistage, in-line, centrifugal pump for installation in pipe systems and mounting on a foundation.

The pump has the following characteristics:

- Impellers, intermediate chambers and outer sleeve are made of
  - Pump head cover and base are made of
  - The shaft seal has assembly length according to EN 12756.
  - Power transmission is via cast iron split coupling.
- flanges/couplings.

The motor is a 1-phase AC motor.

### **Controls:**

Frequency converter: NONE

### **Liquid:**

Pumped liquid: Water  
Liquid temperature during operation: 68 °F  
Density: 62.29 lb/ft<sup>3</sup>

### **Technical:**

Speed for pump data: 3436 rpm  
Pump orientation: Vertical  
Shaft seal arrangement: Single  
Code for shaft seal: HQQE  
Approvals on nameplate: CURUS, NSF61  
Curve tolerance: ISO9906:2012 3B

### **Materials:**

Base: Stainless steel  
EN 1.4408  
AISI 316  
Impeller: Stainless steel  
EN 1.4401  
AISI 316  
Bearing material: SIC

### **Installation:**

Maximum ambient temperature: 104 °F  
Max pressure at stated temperature: 363 psi / 250 °F  
363 psi / -4 °F  
Type of connection: PJE



Company name:

Created by:

Phone:

Date:

2/22/2018

Size of inlet connection: DN 32  
Size of suction port: 1 1/4 inch  
Size of outlet connection: DN 32  
Size of outlet port: 1 1/4 inch  
Pressure rating: PN 50  
Flange size for motor: 56C

**Electrical data:**

Motor standard: NEMA  
Motor type: BALDOR  
IE Efficiency class: NA  
Rated power - P2: 0.33 HP  
Power (P2) required by pump: 0.33 HP  
Main frequency: 60 Hz  
Rated voltage: 1 x 115/230 V  
Service factor: 1,35  
Rated current: 6,00/3,00 A  
Rated speed: 3450 rpm  
Number of poles: 2  
Insulation class (IEC 85): B

**Others:**

Net weight: 43.8 lb  
Gross weight: 54.8 lb  
Shipping volume: 4.94 ft<sup>3</sup>

Position	Count	Description
	1	<p><b>CRN 1S-3 A-P-G-E-HQQE</b></p>  <p>Product No.: On request Vertical, non-self-priming, multistage, in-line, centrifugal pump for installation in pipe systems and mounting on a foundation.</p> <p>The pump has the following characteristics:</p> <ul style="list-style-type: none"> <li>- Impellers, intermediate chambers and outer sleeve are made of</li> <li>- Pump head cover and base are made of</li> <li>- The shaft seal has assembly length according to EN 12756.</li> <li>- Power transmission is via cast iron split coupling flanges/couplings.</li> </ul> <p>The motor is a 1-phase AC motor.</p> <p><b>Controls:</b> Frequency converter: NONE</p> <p><b>Liquid:</b> Pumped liquid: Water Liquid temperature during operation: 68 °F Density: 62.29 lb/ft<sup>3</sup></p> <p><b>Technical:</b> Speed for pump data: 3436 rpm Pump orientation: Vertical Shaft seal arrangement: Single Code for shaft seal: HQQE Approvals on nameplate: CURUS,NSF61 Curve tolerance: ISO9906:2012 3B</p> <p><b>Materials:</b> Base: Stainless steel EN 1.4408 AISI 316 Impeller: Stainless steel EN 1.4401 AISI 316 Bearing material: SIC</p> <p><b>Installation:</b> Maximum ambient temperature: 104 °F Max pressure at stated temperature: 363 psi / 250 °F 363 psi / -4 °F Type of connection: PJE Size of inlet connection: DN 32</p>



Company name:

Created by:

Phone:

Date:

2/22/2018

Position	Count	Description
		Size of suction port: 1 1/4 inch Size of outlet connection: DN 32 Size of outlet port: 1 1/4 inch Pressure rating: PN 50 Flange size for motor: 56C  <b>Electrical data:</b> Motor standard: NEMA Motor type: BALDOR IE Efficiency class: NA Rated power - P2: 0.33 HP Power (P2) required by pump: 0.33 HP Main frequency: 60 Hz Rated voltage: 1 x 115/230 V Service factor: 1,35 Rated current: 6,00/3,00 A Rated speed: 3450 rpm Number of poles: 2 Insulation class (IEC 85): B  <b>Others:</b> Net weight: 43.8 lb Gross weight: 54.8 lb Shipping volume: 4.94 ft³

## On request CRN 1S-3 60 Hz

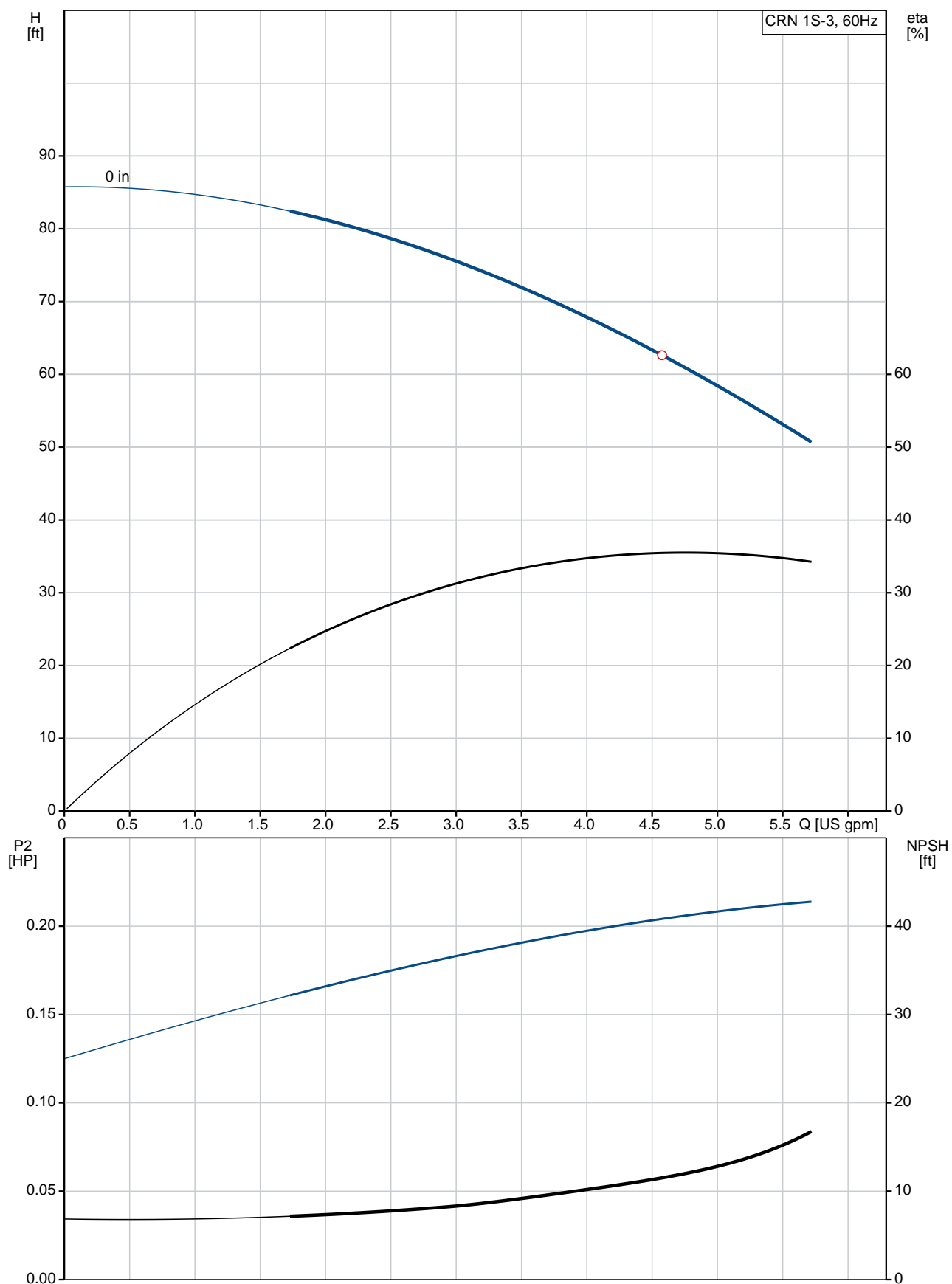

Description	Value
<b>General information:</b>	
Product name:	CRN 1S-3 A-P-G-E-HQQE
Product No.:	On request
EAN:	On request
<b>Technical:</b>	
Speed for pump data:	3436 rpm
Stages:	3
Impellers:	3
Low NPSH:	N
Pump orientation:	Vertical
Shaft seal arrangement:	Single
Code for shaft seal:	HQQE
Approvals on nameplate:	CURUS, NSF61
Curve tolerance:	ISO9906:2012 3B
Pump version:	A
Model:	A
Cooling:	TEFC
<b>Materials:</b>	
Base:	Stainless steel EN 1.4408 AISI 316
Impeller:	Stainless steel EN 1.4401 AISI 316
Material code:	G
Code for rubber:	E
Bearing material:	SIC

<b>Installation:</b>	
Maximum ambient temperature:	104 °F
Max pressure at stated temperature:	363 psi / 250 °F 363 psi / -4 °F
Type of connection:	PJE
Connect code:	P
Size of inlet connection:	DN 32
Size of suction port:	1 1/4 inch
Size of outlet connection:	DN 32
Size of outlet port:	1 1/4 inch
Pressure rating:	PN 50
Flange size for motor:	56C

<b>Liquid:</b>	
Pumped liquid:	Water
Liquid temperature during operation:	68 °F
Density:	62.29 lb/ft³

<b>Electrical data:</b>	
Motor standard:	NEMA
Motor type:	BALDOR
IE Efficiency class:	NA
Rated power - P2:	0.33 HP
Power (P2) required by pump:	0.33 HP
Main frequency:	60 Hz
Rated voltage:	1 x 115/230 V
Service factor:	1,35
Rated current:	6,00/3,00 A
Load current:	6,8/3,4 A

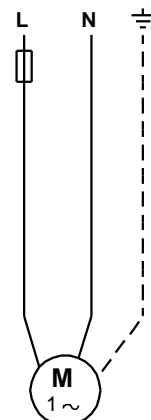
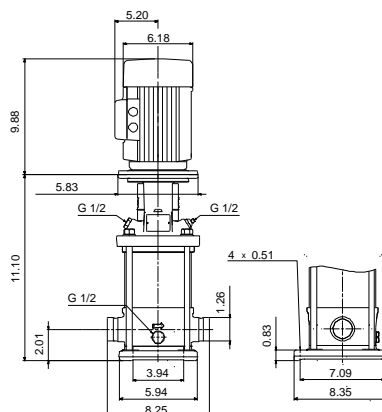
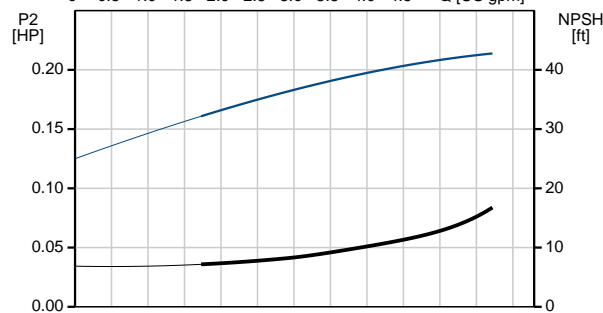
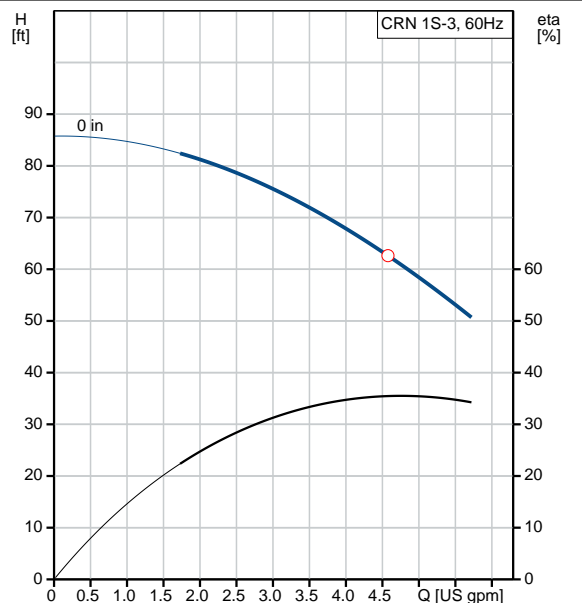





Company name:

Created by:

Phone:

Date:

2/22/2018

Description	Value
Rated speed:	3450 rpm
Number of poles:	2
Insulation class (IEC 85):	B
Motor Number:	85680001
<b>Controls:</b>	
Frequency converter:	NONE
<b>Others:</b>	
Net weight:	43.8 lb
Gross weight:	54.8 lb
Shipping volume:	4.94 ft <sup>3</sup>

## On request CRN 1S-3 60 Hz

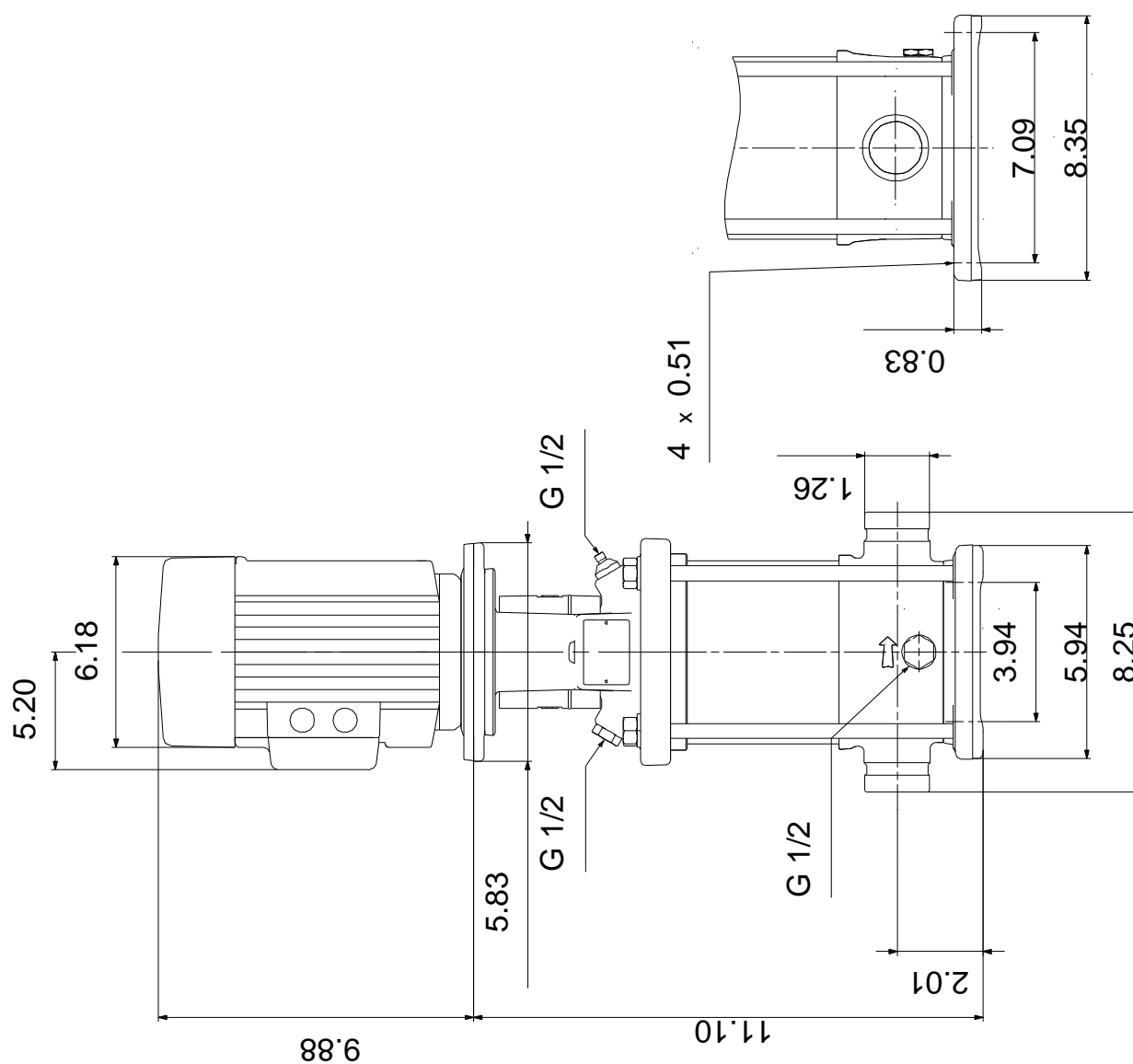

Note! All units are in [mm] unless otherwise stated.  
Disclaimer: This simplified dimensional drawing does not show all details.

On request CRN 1S-3 60 Hz

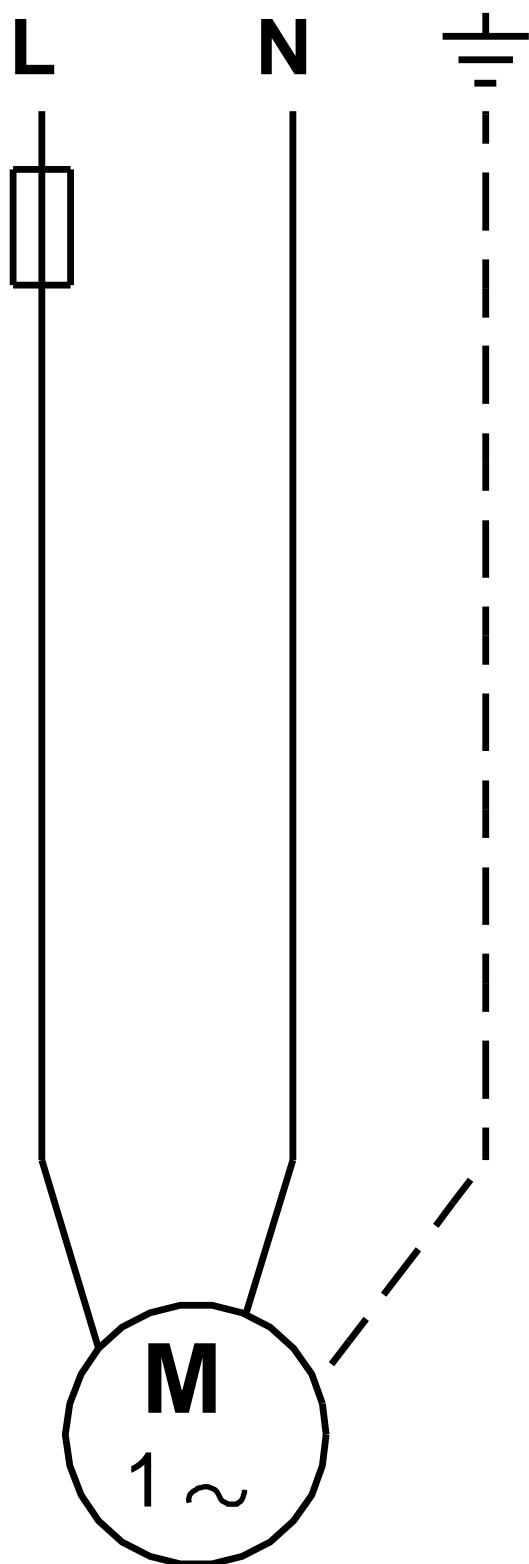

All units are [mm] unless otherwise presented.



Company name:

Created by:

Phone:

Date:

2/22/2018

---

**Order Data:**

Product name: CRN 1S-3 A-P-G-E-HQQE

Amount: 1

Product No.: On request

Total: Price on request

---

## Exploded view (TM02 0212 4100)

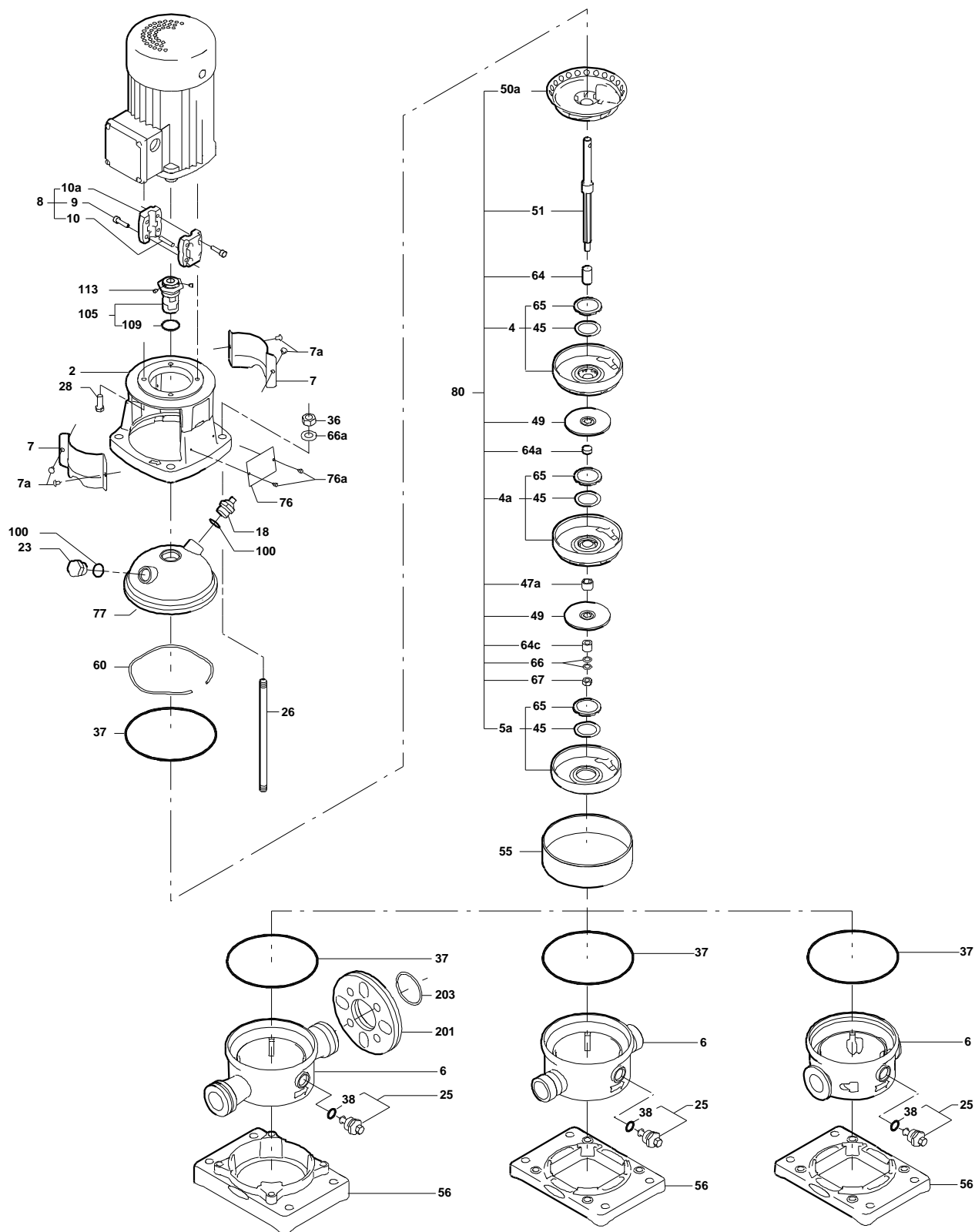

## Sectional drawing (TM02 0215 4100)

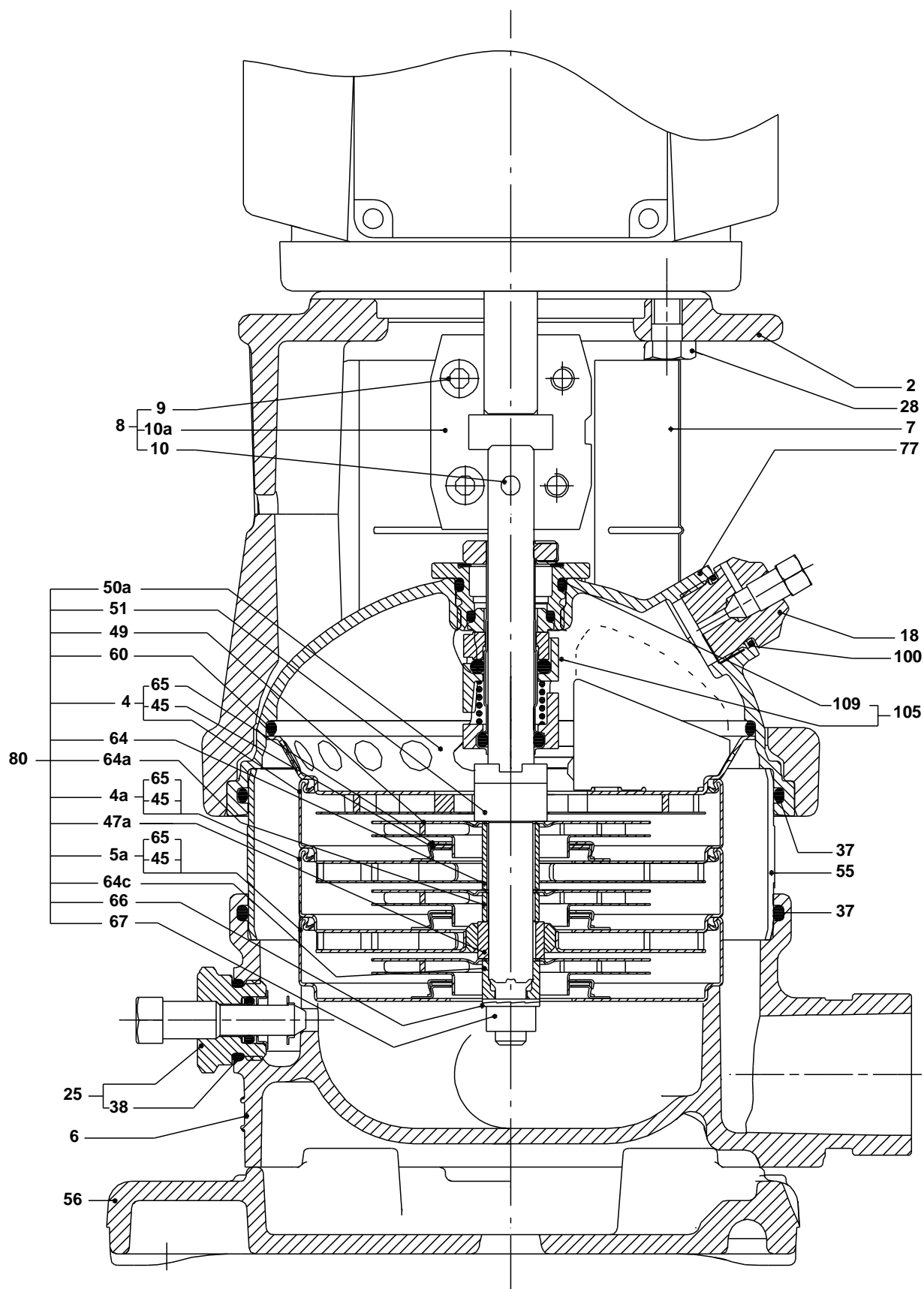

TM02