



**The Timken Company**

4500 Mt Pleasant St. NW

N. Canton, OH 44720

**Phone:** (234) 262-3000

**E-Mail:** [CustomerCAD@timken.com](mailto:CustomerCAD@timken.com) • **Web site:** [www.timken.com](http://www.timken.com)

## Part Number 1106KRRB, Fafnir® Eccentric Locking Collar Ball Bearings

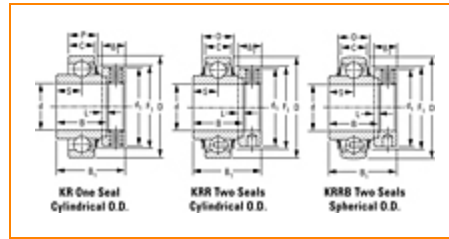

[Specifications](#) | [Dimensions](#) | [Basic Load Ratings](#)

### Specifications

<b>Manufacturing Part Number</b>	1106KRRB + COL
<b>Series</b>	Industrial
<b>Shaft Size d</b>	1 3/8 in
<b>Bore Type</b>	Cylindrical bore
<b>Bearing Type</b>	Ball Bearing
<b>Material</b>	Bearing Steel
<b>Lubrication Type</b>	Non-Relubricatable
<b>O.D. Type</b>	Spherical OD
<b>Sub Series</b>	1..KRRB
<b>Seal Type</b>	Shroud Seal



## Dimensions

<b>Outside Diameter D</b>	2.835 in 72 mm
<b>Inner Ring Width B</b>	1.484 in 37.7 mm
<b>Outside Ring Width C</b>	0.748 in 19 mm
<b>Radius r</b>	0.024 in 0.6 mm
<b>Center of Bearing from End S</b>	0.742 in 18.85 mm
<b>Set Screw Size</b>	3/8-16
<b>Number of Set Screws</b>	2
<b>Angle between Set Screws</b>	90 °
<b>Dimension d1</b>	2.126 in 54 mm
<b>Dimension B1</b>	2.016 in 51.2 mm
<b>Dimension B2</b>	0.673 in 17.1 mm

## Basic Load Ratings

<b>Static Load Rating</b>	3440 lbf 15300 N
<b>Dynamic Load Rating</b>	6400 lbf 28500 N

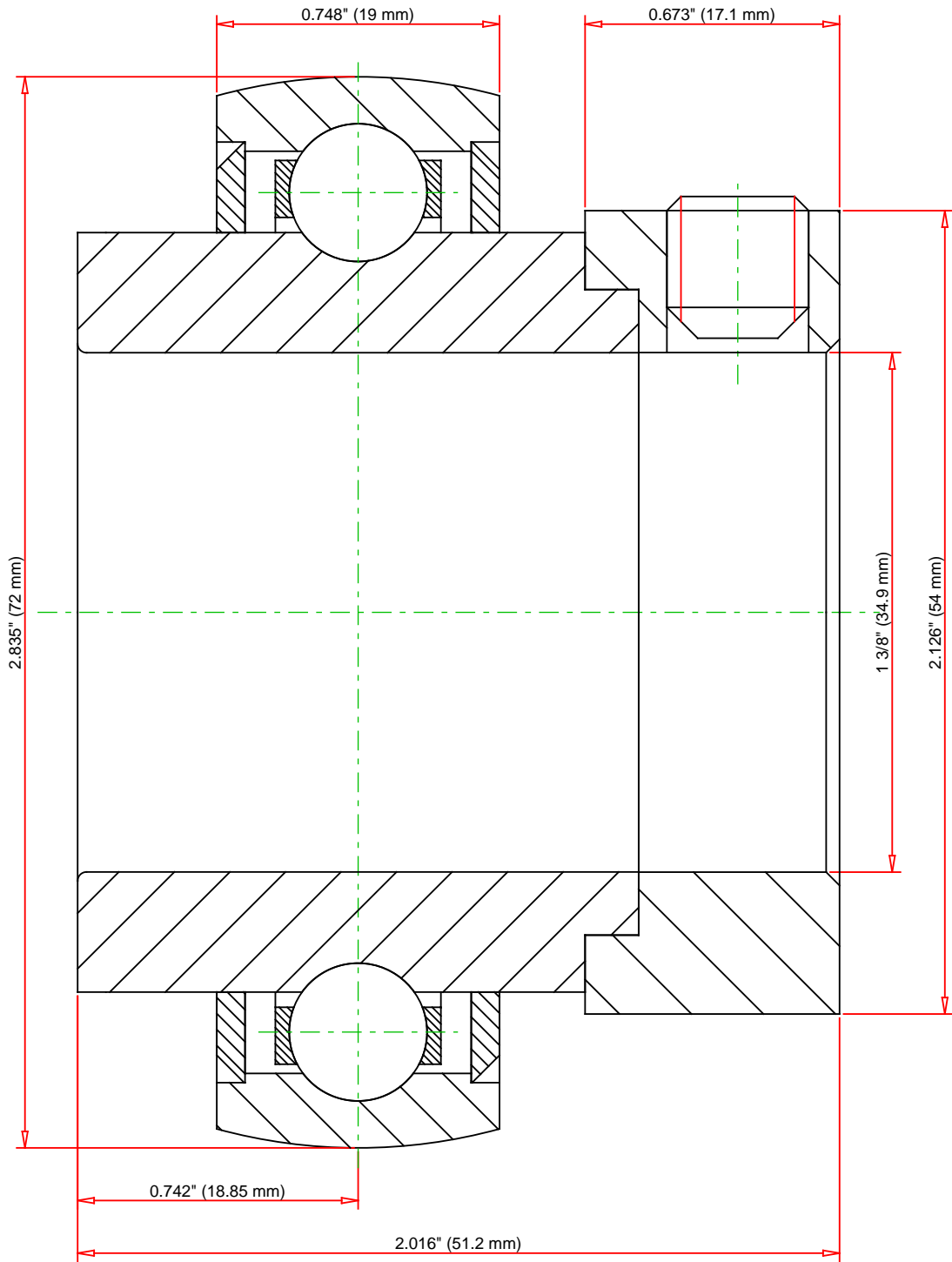

Weight	0.5 lb	0.2 kg
--------	--------	--------

**TIMKEN**®

**THE TIMKEN COMPANY**  
NORTH CANTON, OHIO USA

**1106KRRB**

Fafnir® Eccentric Locking Collar Ball Bearings

Static Load Rating	3440 lbf	15300 N
Dynamic Load Rating	6400 lbf	28500 N

Every reasonable effort has been made to ensure the accuracy of the information contained in this writing, but no liability is accepted for errors, omissions or for any other reason.

**FOR DISCUSSION ONLY**