

The Timken Company

4500 Mt Pleasant St. NW

N. Canton, OH 44720

Phone: (234) 262-3000

E-Mail: CustomerCAD@timken.com • **Web site:** www.timken.com

Part Number MM9108K, Fafnir® Spindle Deep Groove Ball Bearings (9100K, 200K, 300K)

Radial ball bearings consist of an inner and outer ring with a cage containing a complement of precision balls. The standard Conrad-type bearing has a deep-groove construction capable of handling radial and axial loads from either direction in versatile designs that permit relatively high-speed operation.

In addition to standard single-row deep groove bearings, Timken offers special designs, including a maximum capacity series and an extra large (XLS) radial series bearing.

Size range: 3 mm

[more](#)

[Specifications](#) | [Dimensions](#) | [Basic Load Ratings](#) | [Factors](#) | [Abutment and Fillet Dimensions](#)

Specifications

Design Units	Metric
Rows per Set	Single
d - Bore	40 mm
Ball Type	STEEL
Cage Type	CR - Phenolic Inner Land Riding Cage
Precision Class	ISO P4S (ABEC 7/9)

Dimensions



D - Outer Diameter	68 mm 2.6772 in
---------------------------	--------------------

Bearing Width	15 mm 0.5906 in
----------------------	--------------------

Basic Load Ratings

Ce - Dynamic Radial Rating (per row)¹	18600 N 4180 lbf
---	---------------------

C0 - Static Radial Rating (per row)	11600 N 2600 lbf
--	---------------------

C1 ISO - Dynamic Radial Rating (per row)	16900 N 3800 lbf
---	---------------------

Factors

Limiting Speed (Grease) (per row)	18200 rpm
--	-----------

Limiting Speed (Oil)	36400 rpm
-----------------------------	-----------

Abutment and Fillet Dimensions

R - Inner Ring "To Clear" Radius²	1 mm 0.039 in
---	------------------

r - Outer Ring "To Clear" Radius³	1 mm 0.039 in
---	------------------

da - Inner Ring Backing Diameter	45.7 mm 1.800 in
---	---------------------

Da - Outer Ring Backing Diameter	62.2 mm 2.450 in
---	---------------------

¹ Based on 10^6 revolutions of calculated fatigue life.

² Maximum housing fillet radius that bearing corners will clear.

³ Maximum shaft fillet radius that bearing corners will clear.

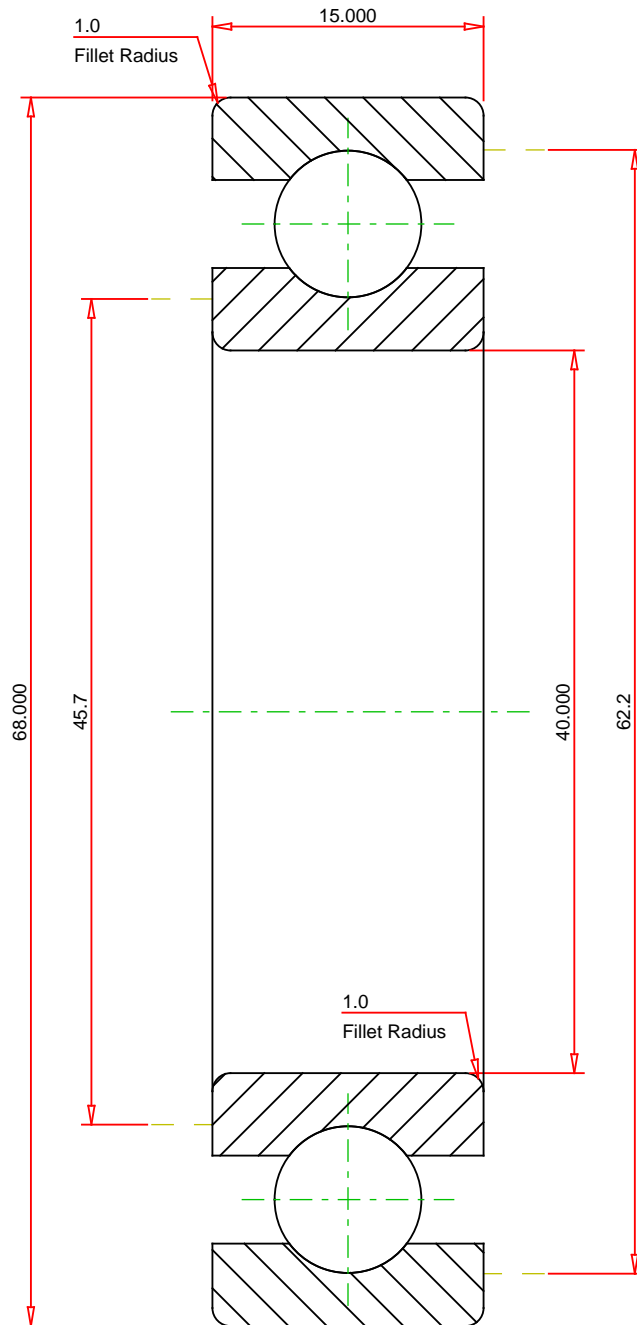

METRIC UNITS

Number of Balls Per Row	12
Bearing Weight	0.180 kg

TIMKEN®

THE TIMKEN COMPANY
NORTH CANTON, OHIO USA

MM9108K
Fafnir® Spindle Deep Groove Ball Bearings
(9100K, 200K, 300K)

Dynamic Radial Rating	18600	N
Static Radial Rating	11600	N

Every reasonable effort has been made to ensure the accuracy of the information contained in this writing, but no liability is accepted for errors, omissions or for any other reason.

FOR DISCUSSION ONLY