



The Timken Company

4500 Mt Pleasant St. NW

N. Canton, OH 44720

Phone: (234) 262-3000

E-Mail: CustomerCAD@timken.com • **Web site:** www.timken.com

Part Number 7407W SU, Fafnir® Single Row Angular Contact Ball Bearings (7200, 7300, 7400)

Timken® angular contact ball bearings are designed for combination radial and axial loading. Single-row bearings have high thrust capacity in one direction. Some single-row bearings are specifically designed for duplex mounting in sets for maximum performance.

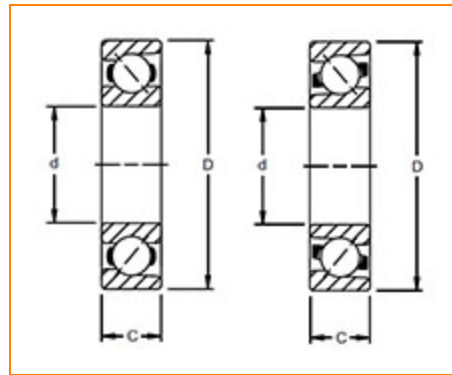

[Dimensions](#) | [Basic Load Ratings](#) | [Specifications](#) | [Abutment and Fillet Dimensions](#)

Dimensions

d - Bore	35 mm
D - Outer Diameter	100 mm 3.937 in
Bearing Width	25 mm 0.9843 in
Contact Angle	20°

Basic Load Ratings



C₀ - Static Radial Rating

42800 N
9650 lbf

Ce - Dynamic Radial Rating¹	79900 N 18000 lbf
---	----------------------

Specifications

Ball Type	STEEL
Cage Type	Steel Cage
Design Units	Metric

Abutment and Fillet Dimensions

R - Inner Ring "To Clear" Radius²	1.5 mm 0.059 in
r - Outer Ring "To Clear" Radius³	1.5 mm 0.059 in
da - Inner Ring Backing Diameter	43.90 mm 1.7300 in
Da - Outer Ring Backing Diameter	90.90 mm 3.580 in

¹ Based on 10^6 revolutions of calculated fatigue life.

² Maximum housing fillet radius that bearing corners will clear.

³ Maximum shaft fillet radius that bearing corners will clear.

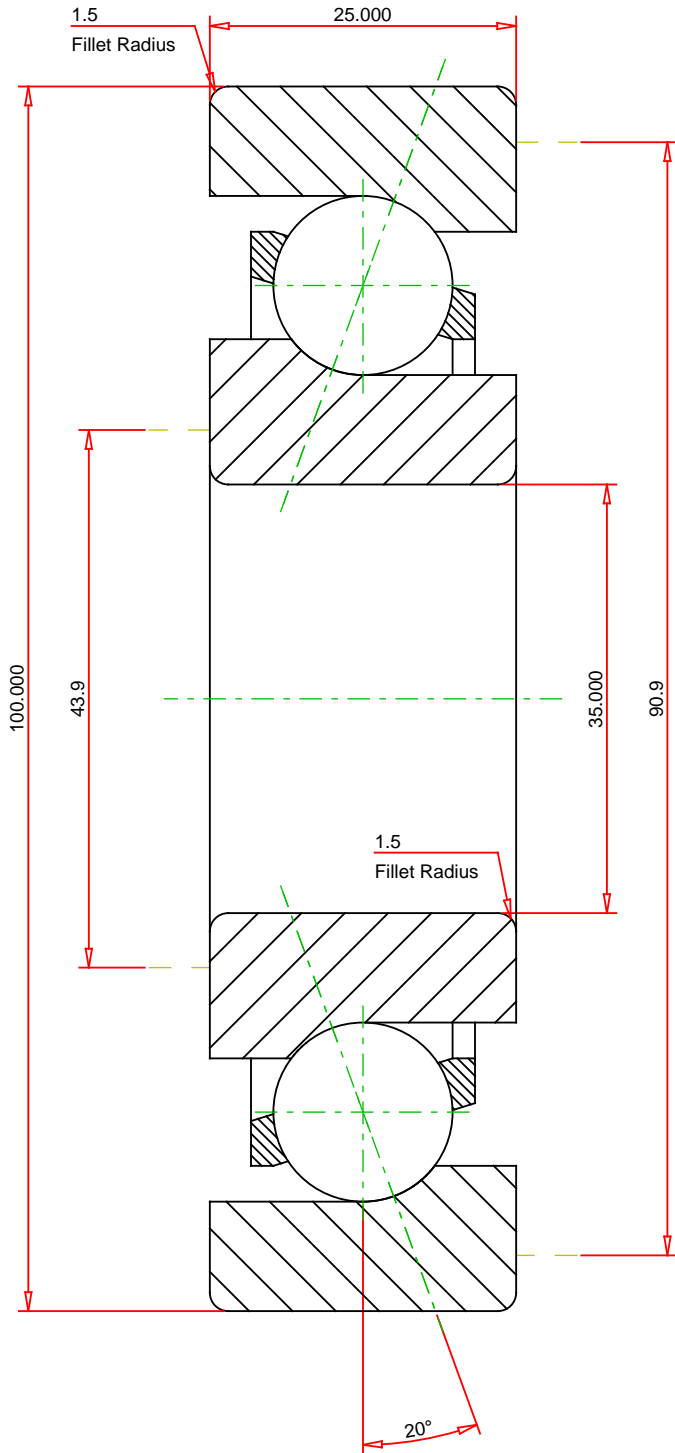

METRIC UNITS

Number of Balls Per Row 9
 Bearing Weight 1.002 kg

TIMKEN®

THE TIMKEN COMPANY
 NORTH CANTON, OHIO USA

7407W SU
 Fafnir® Single Row Angular Contact Ball Bearings
 (7200, 7300, 7400)

Dynamic Radial Rating 79900 N
 Static Radial Rating 42800 N

Every reasonable effort has been made to ensure the accuracy of the information contained in this writing, but no liability is accepted for errors, omissions or for any other reason.

FOR DISCUSSION ONLY