

**The Timken Company**

4500 Mt Pleasant St. NW

N. Canton, OH 44720

**Phone:** (234) 262-3000

**E-Mail:** [CustomerCAD@timken.com](mailto:CustomerCAD@timken.com) • **Web site:** [www.timken.com](http://www.timken.com)

## Part Number 7205WN, Fafnir® Single Row Angular Contact Ball Bearings (7200, 7300, 7400)

Timken® angular contact ball bearings are designed for combination radial and axial loading. Single-row bearings have high thrust capacity in one direction. Some single-row bearings are specifically designed for duplex mounting in sets for maximum performance.

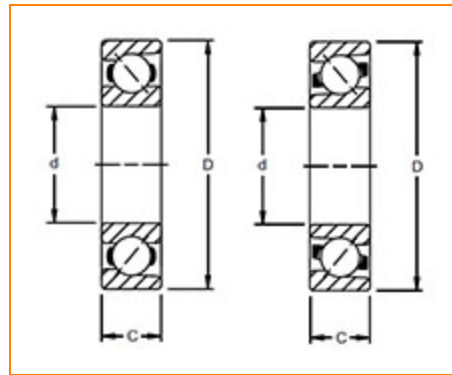

[Dimensions](#) | [Basic Load Ratings](#) | [Factors](#) | [Specifications](#) | [Abutment and Fillet Dimensions](#)

### Dimensions

<b>d - Bore</b>	25 mm
<b>D - Outer Diameter</b>	52 mm 2.0472 in
<b>Bearing Width</b>	15 mm 0.5906 in
<b>Contact Angle</b>	40°

### Basic Load Ratings

**C<sub>0</sub> - Static Radial Rating**

 9400 N  
2120 lbf

<b>Ce - Dynamic Radial Rating<sup>1</sup></b>	16600 N 3750 lbf
---	---------------------

## Factors

<b>Limiting Speed (Grease)</b>	7775 rpm
<b>Limiting Speed (Oil)</b>	10370 rpm

## Specifications

<b>Ball Type</b>	STEEL
<b>Cage Type</b>	Ball Piloted, Pressed Brass Cage
<b>Design Units</b>	Metric

## Abutment and Fillet Dimensions

<b>R - Inner Ring "To Clear" Radius<sup>2</sup></b>	1 mm 0.039 in
<b>r - Outer Ring "To Clear" Radius<sup>3</sup></b>	1 mm 0.039 in
<b>da - Inner Ring Backing Diameter</b>	29.00 mm 1.140 in
<b>Da - Outer Ring Backing Diameter</b>	46.00 mm 1.810 in

<sup>1</sup> Based on  $10^6$  revolutions of calculated fatigue life.

<sup>2</sup> Maximum housing fillet radius that bearing corners will clear.

<sup>3</sup> Maximum shaft fillet radius that bearing corners will clear.

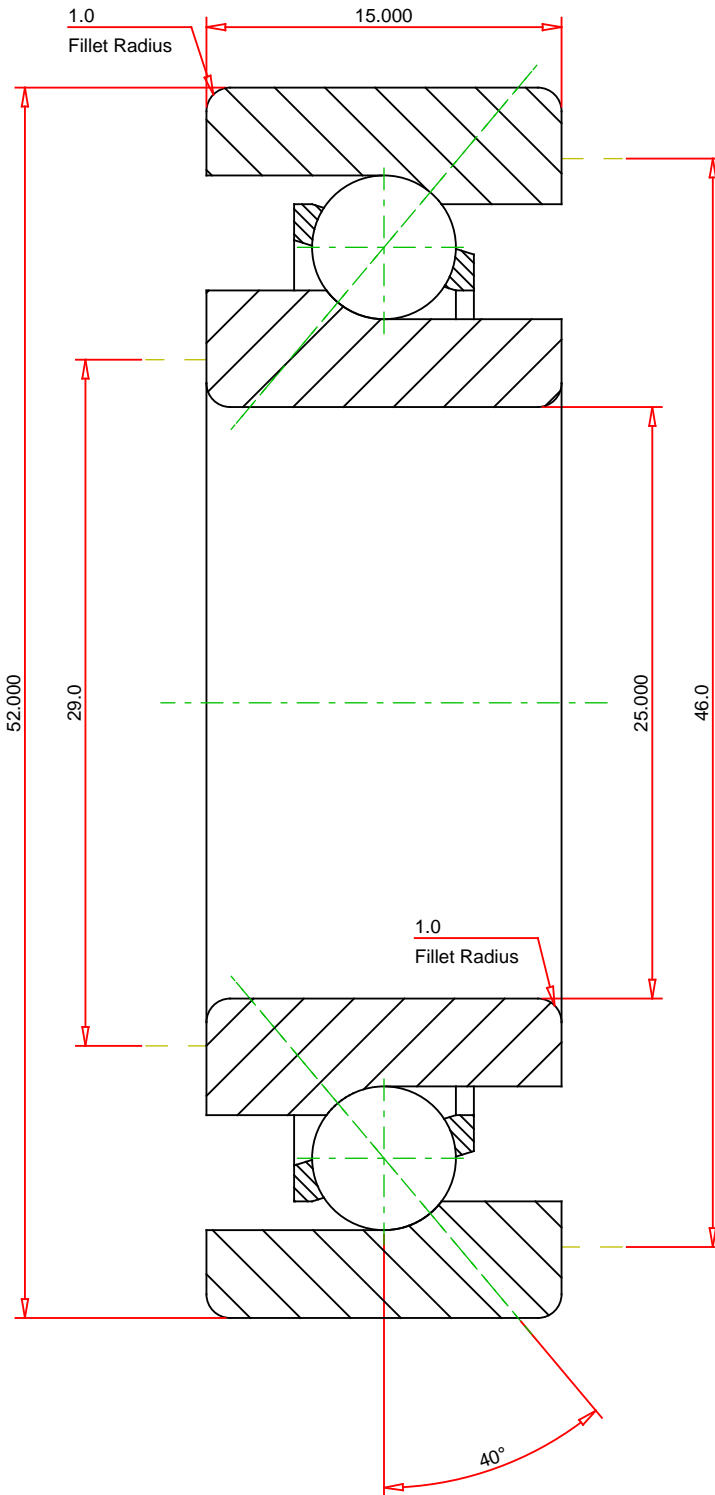

METRIC UNITS

Number of Balls Per Row	13
Bearing Weight	0.132 kg

**TIMKEN**®

**THE TIMKEN COMPANY**  
NORTH CANTON, OHIO USA

**7205WN**  
Fafnir® Single Row Angular Contact Ball Bearings  
(7200, 7300, 7400)

Dynamic Radial Rating	16600	N
Static Radial Rating	9400	N

Every reasonable effort has been made to ensure the accuracy of the information contained in this writing, but no liability is accepted for errors, omissions or for any other reason.

**FOR DISCUSSION ONLY**