

The Timken Company

4500 Mt Pleasant St. NW

N. Canton, OH 44720

Phone: (234) 262-3000

E-Mail: CustomerCAD@timken.com • **Web site:** www.timken.com

Part Number 7205W SU, Fafnir® Single Row Angular Contact Ball Bearings (7200, 7300, 7400)

Timken® angular contact ball bearings are designed for combination radial and axial loading. Single-row bearings have high thrust capacity in one direction. Some single-row bearings are specifically designed for duplex mounting in sets for maximum performance.

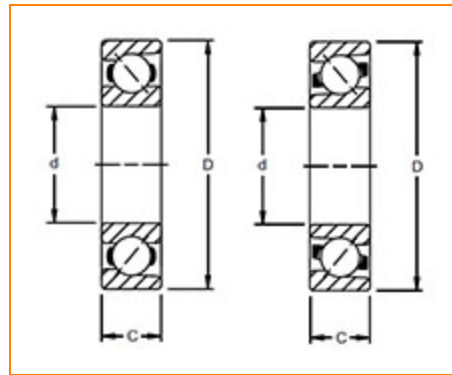

[Dimensions](#) | [Basic Load Ratings](#) | [Factors](#) | [Specifications](#) | [Abutment and Fillet Dimensions](#)

Dimensions

d - Bore	25 mm
D - Outer Diameter	52 mm 2.0472 in
Bearing Width	15 mm 0.5906 in
Contact Angle	40 °

Basic Load Ratings

 C₀ - Static Radial Rating	9400 N 2120 lbf
--	--------------------

Ce - Dynamic Radial Rating¹	16600 N 3750 lbf
---	---------------------

Factors

Limiting Speed (Grease)	7775 rpm
Limiting Speed (Oil)	10370 rpm

Specifications

Ball Type	STEEL
Cage Type	Ball Piloted, Pressed Brass Cage
Design Units	Metric

Abutment and Fillet Dimensions

R - Inner Ring "To Clear" Radius²	1 mm 0.039 in
r - Outer Ring "To Clear" Radius³	1 mm 0.039 in
da - Inner Ring Backing Diameter	29.00 mm 1.140 in
Da - Outer Ring Backing Diameter	46.00 mm 1.810 in

¹ Based on 10^6 revolutions of calculated fatigue life.

² Maximum housing fillet radius that bearing corners will clear.

³ Maximum shaft fillet radius that bearing corners will clear.

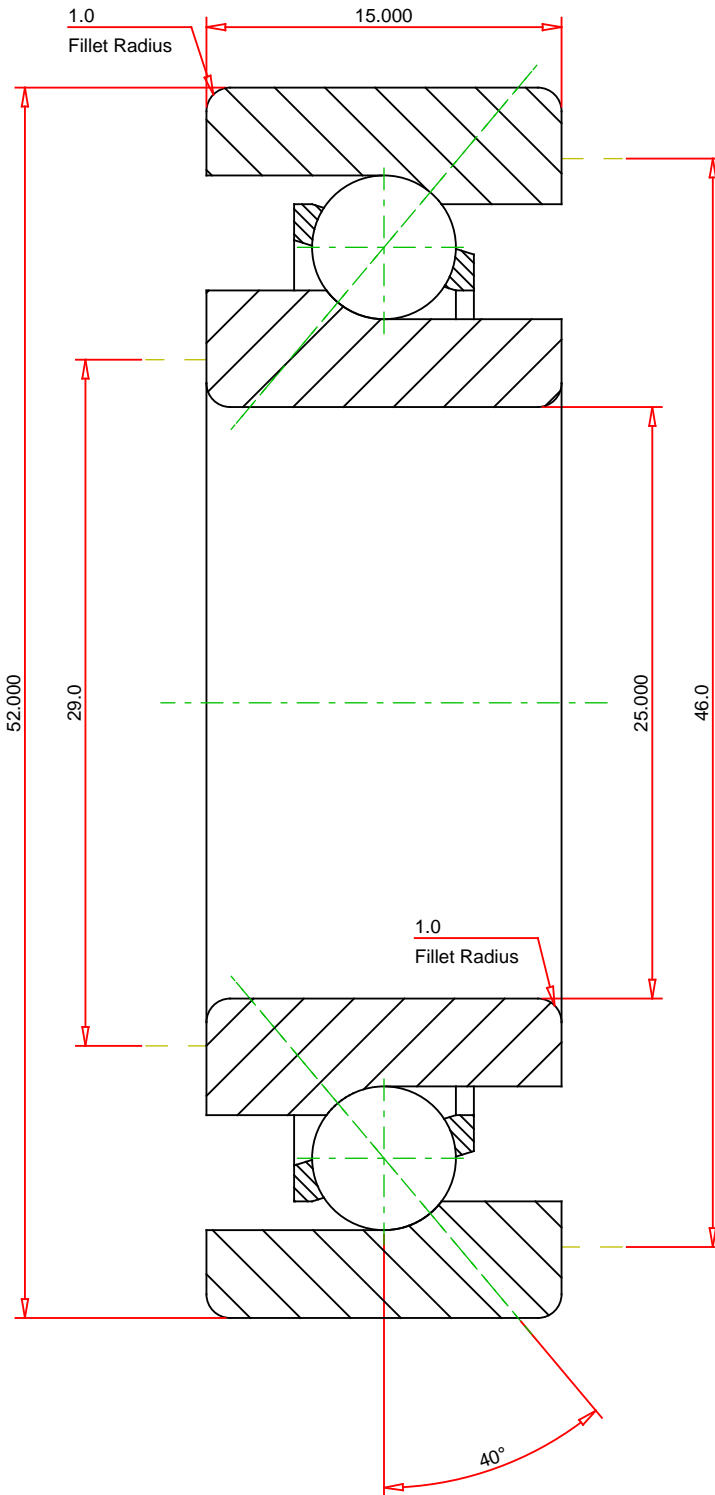

METRIC UNITS

Number of Balls Per Row	13
Bearing Weight	0.132 kg

TIMKEN®

THE TIMKEN COMPANY
NORTH CANTON, OHIO USA

7205W SU
Fafnir® Single Row Angular Contact Ball Bearings
(7200, 7300, 7400)

Dynamic Radial Rating	16600	N
Static Radial Rating	9400	N

Every reasonable effort has been made to ensure the accuracy of the information contained in this writing, but no liability is accepted for errors, omissions or for any other reason.

FOR DISCUSSION ONLY