



**The Timken Company**

4500 Mt Pleasant St. NW

N. Canton, OH 44720

**Phone:** (234) 262-3000

**E-Mail:** [CustomerCAD@timken.com](mailto:CustomerCAD@timken.com) • **Web site:** [www.timken.com](http://www.timken.com)

## Part Number YASM2 3/16, Fafnir® Pillow Block Mounted Bearings Setscrew Locking



[Specifications](#) | [Dimensions](#) | [Basic Load Ratings](#)

### Specifications

<b>Series</b>	Industrial
<b>Shaft Size d</b>	2 3/16 in
<b>Bearing Type</b>	Ball Bearing
<b>Bearing Number</b>	GYM1203KRRB
<b>Seal Type</b>	Shroud Seal
<b>Housing Construction</b>	Two-Bolt Pillow Block
<b>Alternate Part Name</b>	YASM2 3/16

### Dimensions



<b>Base to Center Height H</b>	69.85 mm 2.75 in
<b>Total Length L</b>	239.7 mm 9.437 in
<b>Total Width A</b>	60.3 mm 2.374 in
<b>Bolt Hole Spacing J</b>	188.1 mm 7.406 in
<b>Bolt Hole Width N</b>	18.26 mm 0.719 in
<b>Bolt Hole Length N1</b>	29.46 mm 1.16 in
<b>Foot Height H1</b>	23.8 mm
<b>Total Height H2</b>	138.9 mm 5.469 in
<b>Inside Ring Width B</b>	65.07 mm 2.562 in
<b>Dimension S1</b>	39.67 mm 1.562 in
<b>Dimension F</b>	76.48 mm 3.011 in

## Basic Load Ratings

<b>Static Load Rating</b>	35900 N 8080 lbf
<b>Dynamic Load Rating</b>	58200 N 13100 lbf

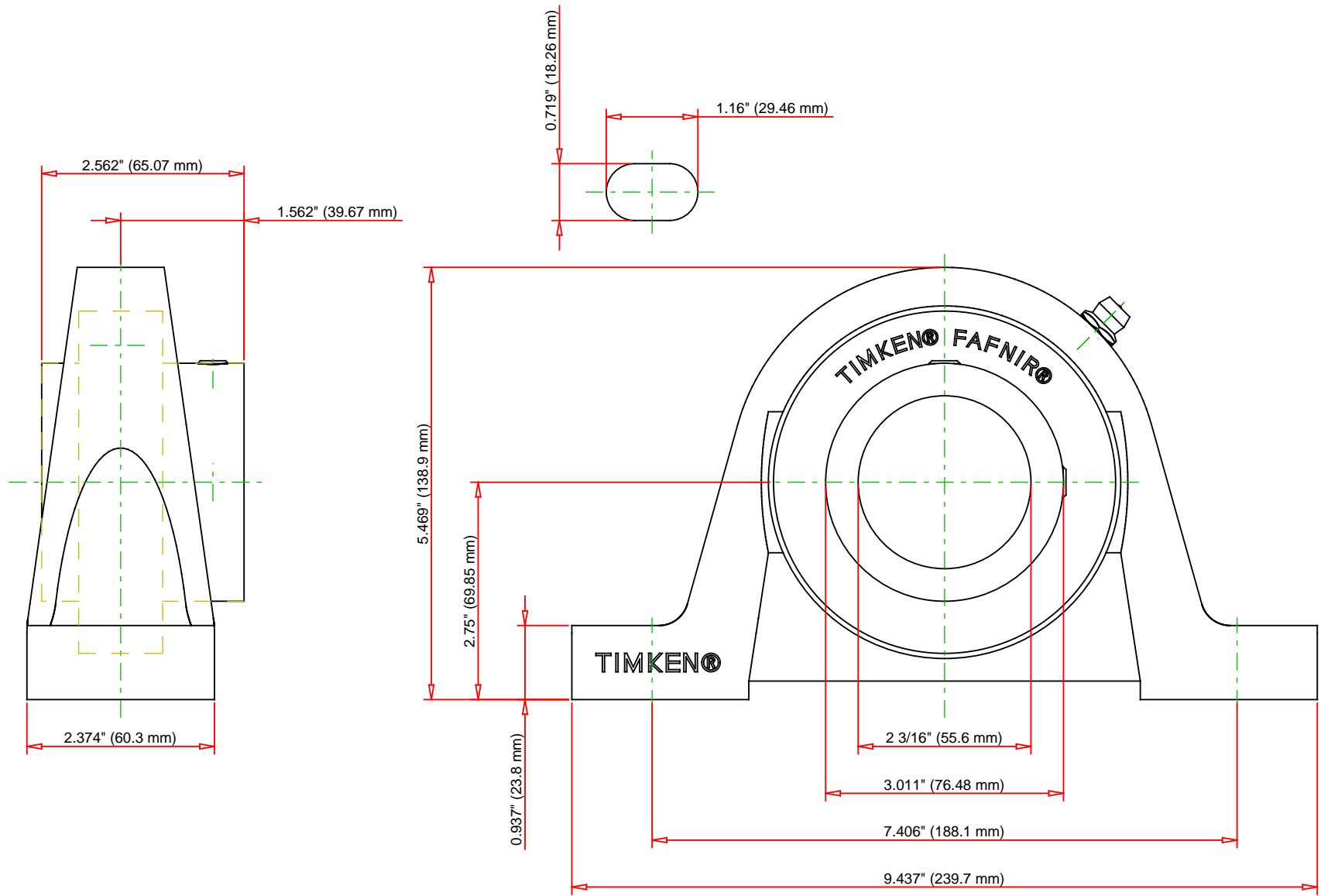

Bearing Number	GYM1203KRRB			
Load Ratings - C <sub>r</sub>	13100	lbf	58200	N
Load Ratings - C <sub>0r</sub>	8080	lbf	35900	N
Weight	9.898	lb	4.49	kg
Bolt Size	M10x1.5			

**TIMKEN®**

THE TIMKEN COMPANY  
NORTH CANTON, OHIO USA

**YASM2 3/16**

Fafnir® Pillow Block Mounted Bearings Setscrew Locking

Every reasonable effort has been made to ensure the accuracy of the information contained in this writing, but no liability is accepted for errors, omissions or for any other reason.

**FOR DISCUSSION ONLY**