

**The Timken Company**

4500 Mt Pleasant St. NW

N. Canton, OH 44720

**Phone:** (234) 262-3000

**E-Mail:** [CustomerCAD@timken.com](mailto:CustomerCAD@timken.com) • **Web site:** [www.timken.com](http://www.timken.com)
**Part Number HJ-8010440, 6673M**

- Clearance fit suggested for outer ring when housing is stationary relative to load.
- Tight transition fit suggested if housing rotates relative to load.
- Consult your Timken representative for oscillating applications (e.g., low radial-clearance concerns).
- Unmarked end of outer ring should be assembled against housing shoulder to clear maximum allowed housing fillet ( $r_{as\ max}$ ).
- Meets Military Standard MS 51961.



[Bearing Dimensions](#) | [Specifications](#) | [Mounting Data](#) | [Sub Assembly Part Numbers](#)

**Bearing Dimensions**

<b>Shaft Diameter (<math>F_w</math>)</b>	127.00 mm 5.00 in
<b>D - Outer Diameter</b>	165.1 mm 6 1/2 in
<b>Dimension C/B</b>	63.5 mm 2.5000 in

**Specifications**

<b>Static Load Rating <math>C_0</math></b>	684000 N 154000 lbf
<b>Dynamic Load Rating <math>C_1</math><sup>1</sup></b>	345000 N 77600 lbf
<b>Geometry Factor <math>C_g</math><sup>2</sup></b>	0.1213
<b>Thermal Speed Ratings - Oil</b>	2800 rpm
<b>Thermal Speed Ratings - Grease</b>	2500 rpm

## Mounting Data

<b>Chamfer <math>r_{smin}</math></b>	2.540 mm 0.1 in
<b>Max. Mounting Dimensions Clearance Fit 1</b>	127.00 mm 5.00 in
<b>Min. Mounting Dimensions Clearance Fit 1</b>	126.975 mm 4.9990 in
<b>Max. Mounting Dimensions Clearance Fit 2</b>	165.141 mm 6.5016 in
<b>Min. Mounting Dimensions Clearance Fit 2</b>	165.100 mm 6.500 in
<b>Max. Mounting Dimensions Tight Transition Fit S</b>	4.9984 mm 126.959 in
<b>Min. Mounting Dimensions Tight Transition Fit S</b>	126.934 mm 4.9974 in
<b>Max. Mounting Dimensions Tight Transition Fit H</b>	165.044 mm 6.4978 in
<b>Min. Mounting Dimensions Tight Transition Fit H</b>	165.085 mm 6.4994 in
<b>Shoulder Diameter <math>D_a</math></b>	150.81 mm 5.938 in

## Sub Assembly Part Numbers

**Used with Inner Ring  
Designation**

IR-648040

<sup>1</sup> Based on  $1 \times 10^6$  revolutions  $L_{10}$  life, for the ISO life calculation method.

<sup>2</sup>  $C_g$  factor for bearing without inner ring.

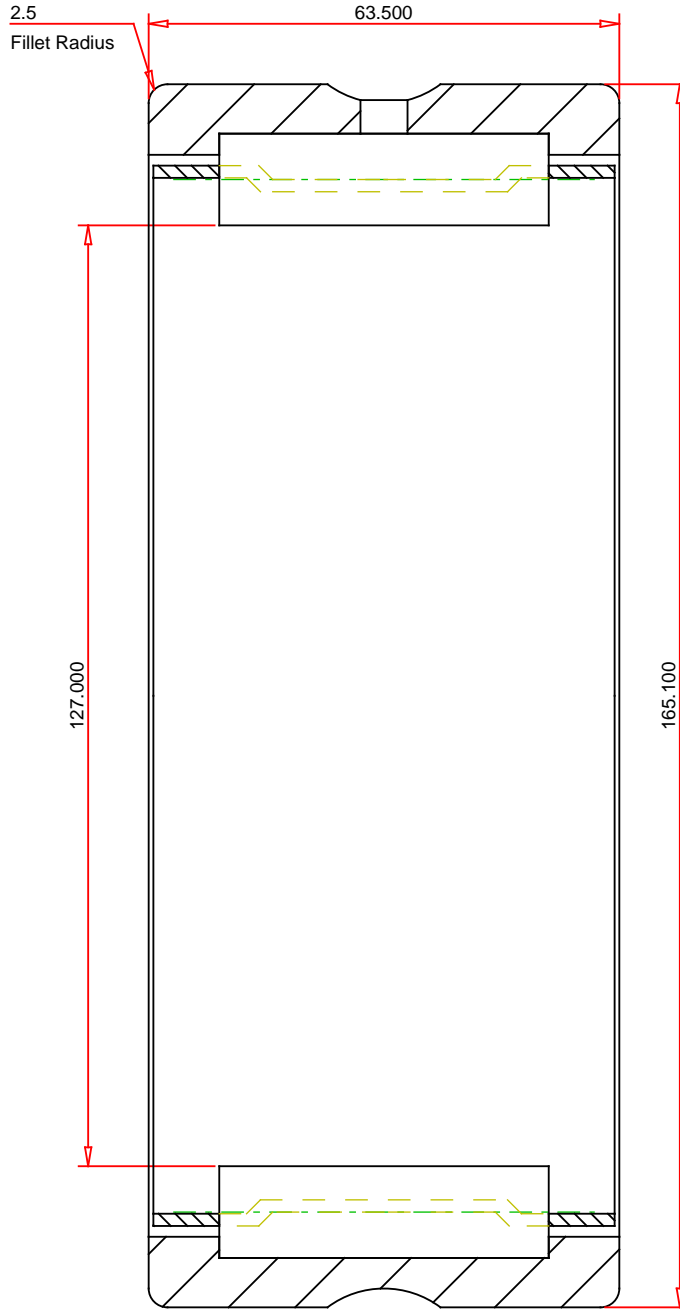

METRIC UNITS

Bearing Weight 3.6 kg

**TIMKEN**<sup>®</sup>

**THE TIMKEN COMPANY**  
NORTH CANTON, OHIO USA

**HJ-8010440**  
CYLINDRICAL ROLLER BEARING

Dynamic Load Rating 345000 N  
Static Load Rating 684000 N

Every reasonable effort has been made to ensure the accuracy of the information contained in this writing, but no liability is accepted for errors, omissions or for any other reason.

**FOR DISCUSSION ONLY**