



The Timken Company

4500 Mt Pleasant St. NW

N. Canton, OH 44720

Phone: (234) 262-3000

E-Mail: CustomerCAD@timken.com • **Web site:** www.timken.com

Part Number LAS1, Fafnir® Pillow Block Mounted Bearings Eccentric Locking Collar

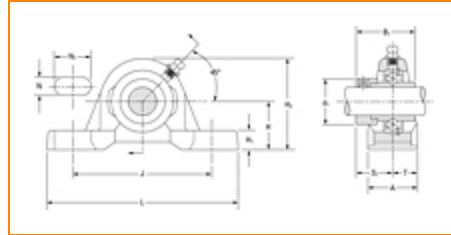

[Specifications](#) | [Dimensions](#) | [Basic Load Ratings](#)

Specifications

Series	Industrial
Shaft Size d	1 in
Bearing Type	Ball Bearing
Bearing Number	G1100KPPB3
Seal Type	Labyrinth Seal
Housing Construction	Two-Bolt Pillow Block
Alternate Part Name	LAS1

Dimensions

Base to Center Height H	36.51 mm 1.437 in
Total Length L	139.7 mm 5.5 in



Total Width A	37.3 mm 1.469 in
Bolt Hole Spacing J	104.8 mm 4.126 in
Bolt Hole Width N	11.1 mm 0.437 in
Bolt Hole Length N1	20.6 mm 0.811 in
Foot Height H1	15.1 mm
Total Height H2	73 mm 2.874 in
Dimension d1	38.1 mm 1.5 in
Dimension B1	44.4 mm 1.748 in
Dimension S1	26.9 mm 1.059 in
Dimension T	18.7 mm 0.736 in

Basic Load Ratings

Static Load Rating	7800 N 1750 lbf
Dynamic Load Rating	15500 N 3490 lbf

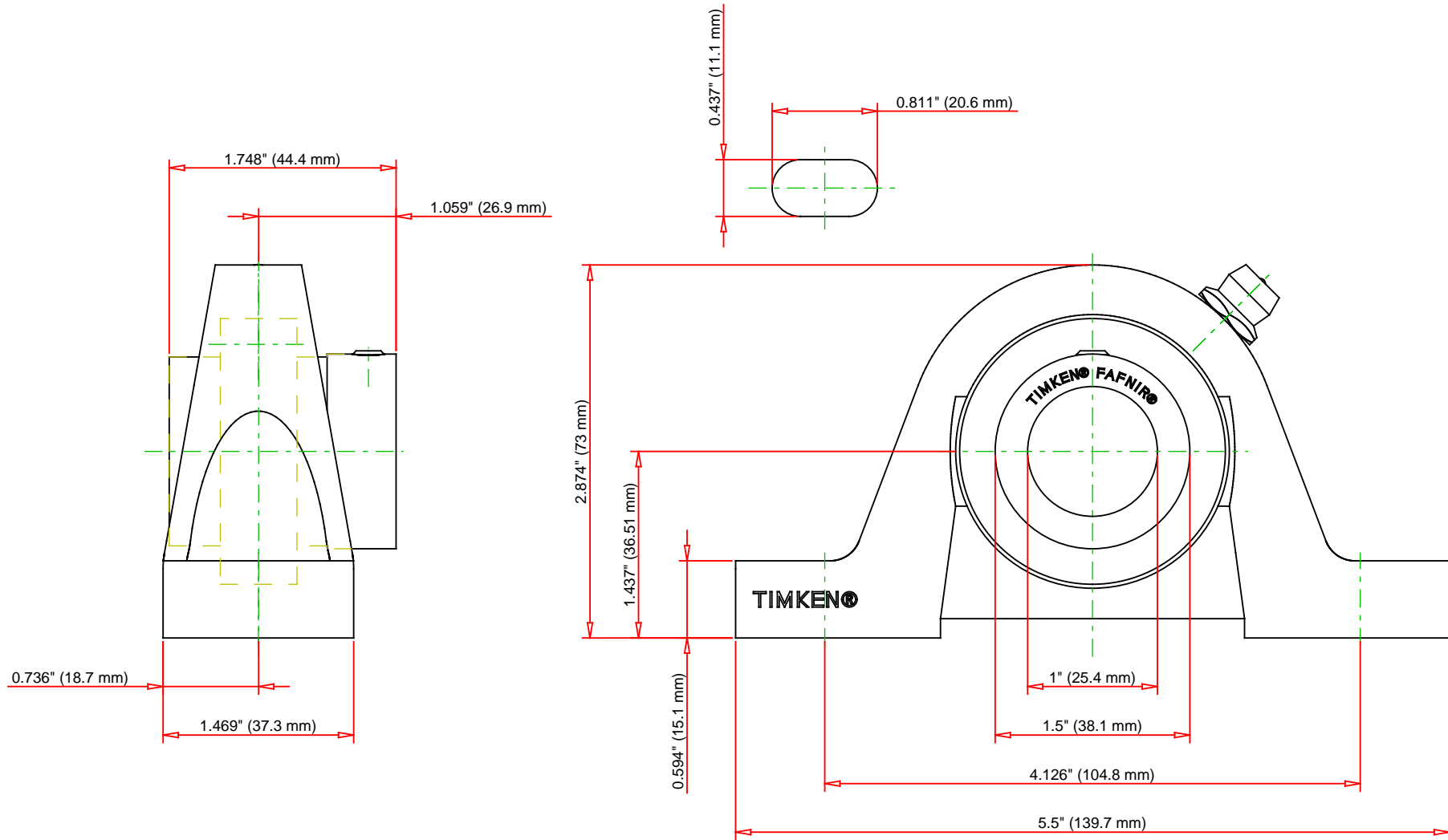

Bearing Number	G1100KPPB3			
Load Ratings - C _r	3490	lbf	15500	N
Load Ratings - C _{0r}	1750	lbf	7800	N
Weight	3.549	lb	1.61	kg

TIMKEN
 THE TIMKEN COMPANY
 NORTH CANTON, OHIO USA

LAS1
 Fafnir® Pillow Block Mounted Bearings Eccentric
 Locking Collar

Every reasonable effort has been made to ensure the accuracy of the information contained in this writing, but no liability is accepted for errors, omissions or for any other reason.

FOR DISCUSSION ONLY