

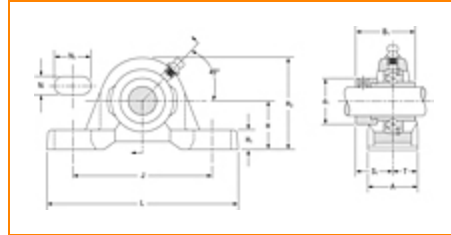

The Timken Company

4500 Mt Pleasant St. NW

N. Canton, OH 44720

Phone: (234) 262-3000

E-Mail: CustomerCAD@timken.com • **Web site:** www.timken.com
Part Number LAK1 1/4, Fafnir® Pillow Block Mounted Bearings Eccentric Locking Collar

[Specifications](#) | [Dimensions](#) | [Basic Load Ratings](#)
Specifications

Series	Industrial
Shaft Size d	1 1/4 in
Bearing Type	Ball Bearing
Bearing Number	G1104KLLB
Seal Type	Labyrinth Seal
Housing Construction	Two-Bolt Pillow Block
Alternate Part Name	LAK1 1/4

Dimensions

Base to Center Height H	46.04 mm 1.813 in
Total Length L	166.7 mm 6.563 in



Total Width A	46.8 mm 1.843 in
Bolt Hole Spacing J	130.2 mm 5.126 in
Bolt Hole Width N	14.3 mm 0.563 in
Bolt Hole Length N1	24.6 mm 0.969 in
Foot Height H1	16.7 mm
Total Height H2	93.7 mm 3.689 in
Dimension d1	54 mm 2.126 in
Dimension B1	51.2 mm 2.016 in
Dimension S1	32.35 mm 1.274 in
Dimension T	23.4 mm 0.921 in

Basic Load Ratings

Static Load Rating	15300 N 3440 lbf
Dynamic Load Rating	28500 N 6400 lbf

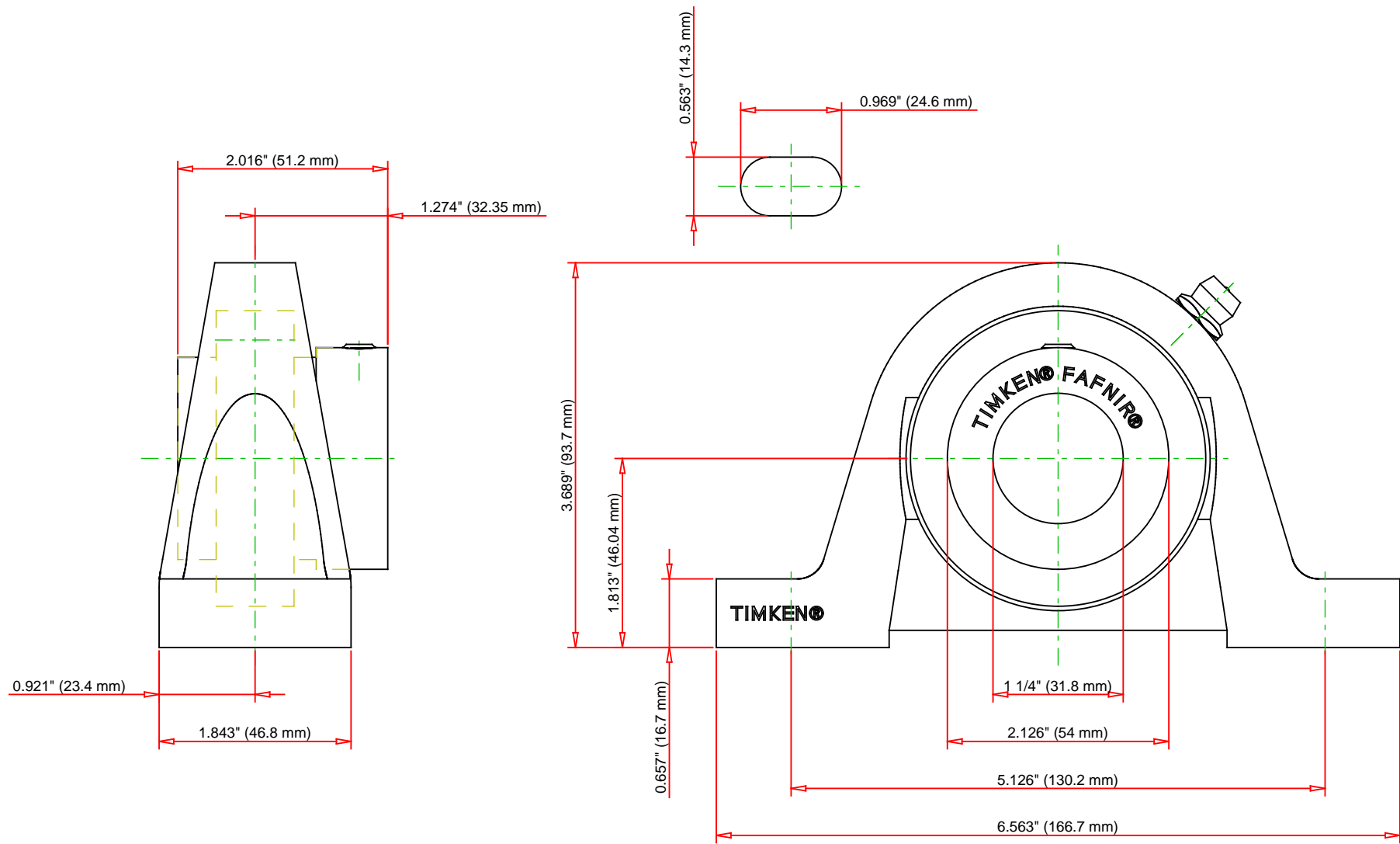

Bearing Number	G1104KLLB			
Load Ratings - C _r	6400	lbf	28500	N
Load Ratings - C _{0r}	3440	lbf	15300	N
Weight	4.167	lb	1.89	kg

TIMKEN
 THE TIMKEN COMPANY
 NORTH CANTON, OHIO USA

LAK1 1/4
 Fafnir® Pillow Block Mounted Bearings Eccentric
 Locking Collar

Every reasonable effort has been made to ensure the accuracy of the information contained in this writing, but no liability is accepted for errors, omissions or for any other reason.

FOR DISCUSSION ONLY