



The Timken Company

4500 Mt Pleasant St. NW

N. Canton, OH 44720

Phone: (234) 262-3000

E-Mail: CustomerCAD@timken.com • **Web site:** www.timken.com

Part Number RAS 3/4, Fafnir® Pillow Block Mounted Bearings Eccentric Locking Collar

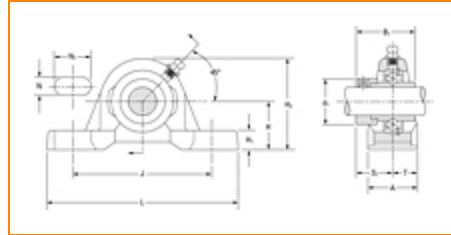

[Specifications](#) | [Dimensions](#) | [Basic Load Ratings](#)

Specifications

Series	Industrial
Shaft Size d	3/4 in
Bearing Type	Ball Bearing
Bearing Number	G1012KRRB
Seal Type	Shroud Seal
Housing Construction	Two-Bolt Pillow Block
Alternate Part Name	RAS3/4

Dimensions

Base to Center Height H	33.34 mm 1.313 in
Total Length L	127 mm 5 in



Total Width A	33.3 mm 1.311 in
Bolt Hole Spacing J	96.4 mm 3.795 in
Bolt Hole Width N	11.1 mm 0.437 in
Bolt Hole Length N1	20.2 mm 0.795 in
Foot Height H1	15.1 mm
Total Height H2	65.9 mm 2.594 in
Dimension d1	33.3 mm 1.311 in
Dimension B1	43.7 mm 1.72 in
Dimension S1	26.6 mm 1.047 in
Dimension T	16.7 mm 0.657 in

Basic Load Ratings

Static Load Rating	6500 N 1460 lbf
Dynamic Load Rating	14200 N 3190 lbf

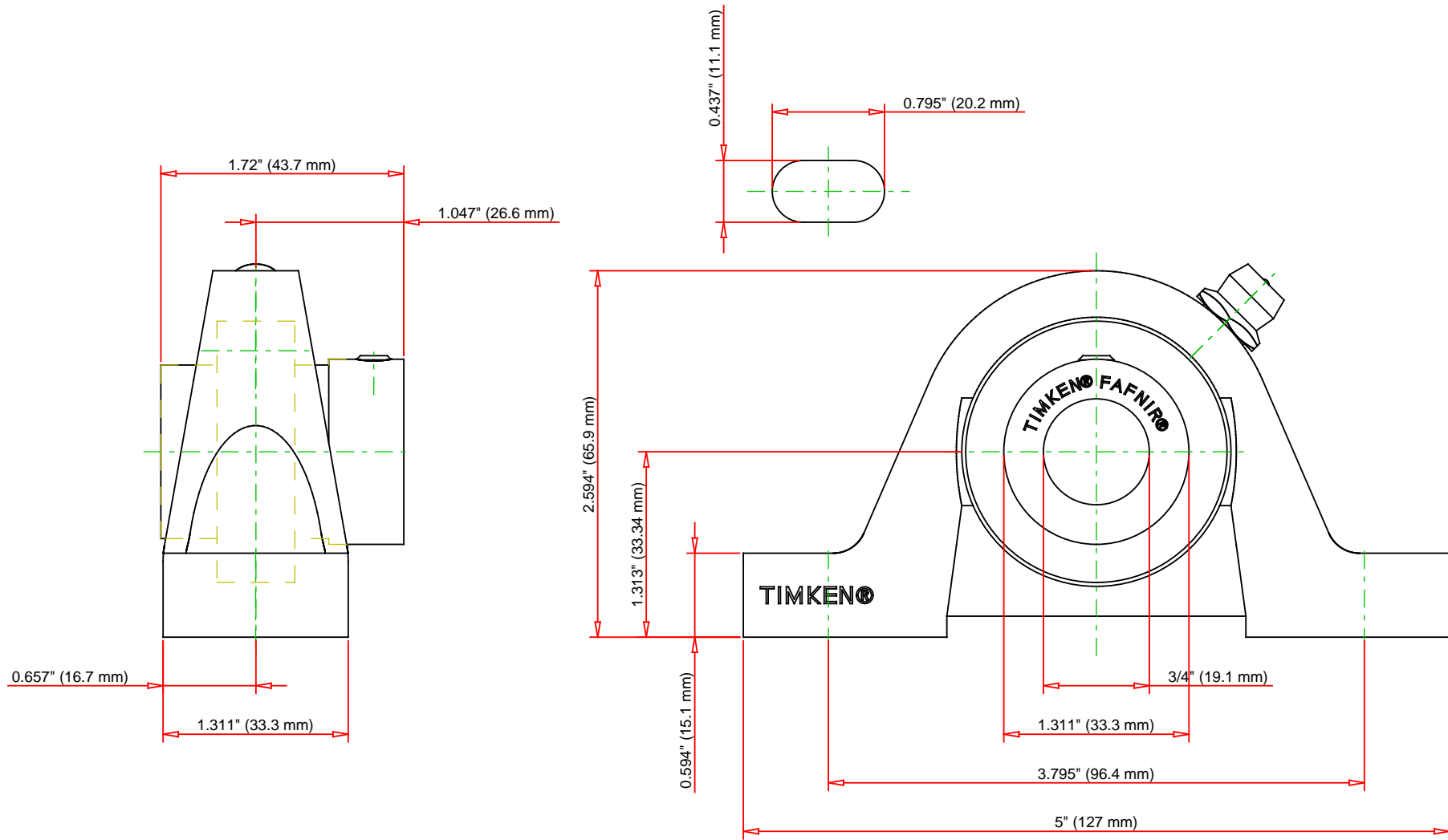

Bearing Number	G1012KRRB			
Load Ratings - C _r	3190	lbf	14200	N
Load Ratings - C _{0r}	1460	lbf	6500	N
Weight	1.609	lb	0.73	kg

TIMKEN
 THE TIMKEN COMPANY
 NORTH CANTON, OHIO USA

RAS 3/4
 Fafnir® Pillow Block Mounted Bearings Eccentric
 Locking Collar

Every reasonable effort has been made to ensure the accuracy of the information contained in this writing, but no liability is accepted for errors, omissions or for any other reason.

FOR DISCUSSION ONLY