

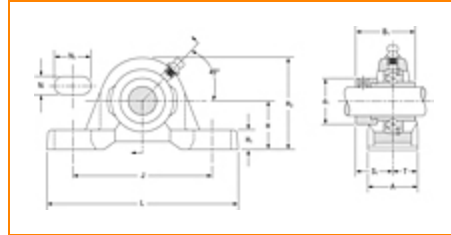

**The Timken Company**

4500 Mt Pleasant St. NW

N. Canton, OH 44720

**Phone:** (234) 262-3000

**E-Mail:** [CustomerCAD@timken.com](mailto:CustomerCAD@timken.com) • **Web site:** [www.timken.com](http://www.timken.com)
**Part Number RAK1 15/16, Fafnir® Pillow Block Mounted Bearings Eccentric Locking Collar**

[Specifications](#) | [Dimensions](#) | [Basic Load Ratings](#)
**Specifications**

<b>Series</b>	Industrial
<b>Shaft Size d</b>	1 15/16 in
<b>Bearing Type</b>	Ball Bearing
<b>Bearing Number</b>	G1115KRRB
<b>Seal Type</b>	Shroud Seal
<b>Housing Construction</b>	Two-Bolt Pillow Block
<b>Alternate Part Name</b>	RAK1 15/16

**Dimensions**

<b>Base to Center Height H</b>	55.56 mm 2.187 in
<b>Total Length L</b>	200 mm 7.874 in



<b>Total Width A</b>	57.9 mm 2.28 in
<b>Bolt Hole Spacing J</b>	158 mm 6.22 in
<b>Bolt Hole Width N</b>	18.3 mm 0.72 in
<b>Bolt Hole Length N1</b>	25.4 mm 1 in
<b>Foot Height H1</b>	17.7 mm
<b>Total Height H2</b>	112.7 mm 4.437 in
<b>Dimension d1</b>	69.9 mm 2.752 in
<b>Dimension B1</b>	62.7 mm 2.469 in
<b>Dimension S1</b>	38.1 mm 1.5 in
<b>Dimension T</b>	29 mm 1.142 in

## Basic Load Ratings

<b>Static Load Rating</b>	23200 N 5210 lbf
<b>Dynamic Load Rating</b>	38900 N 8740 lbf

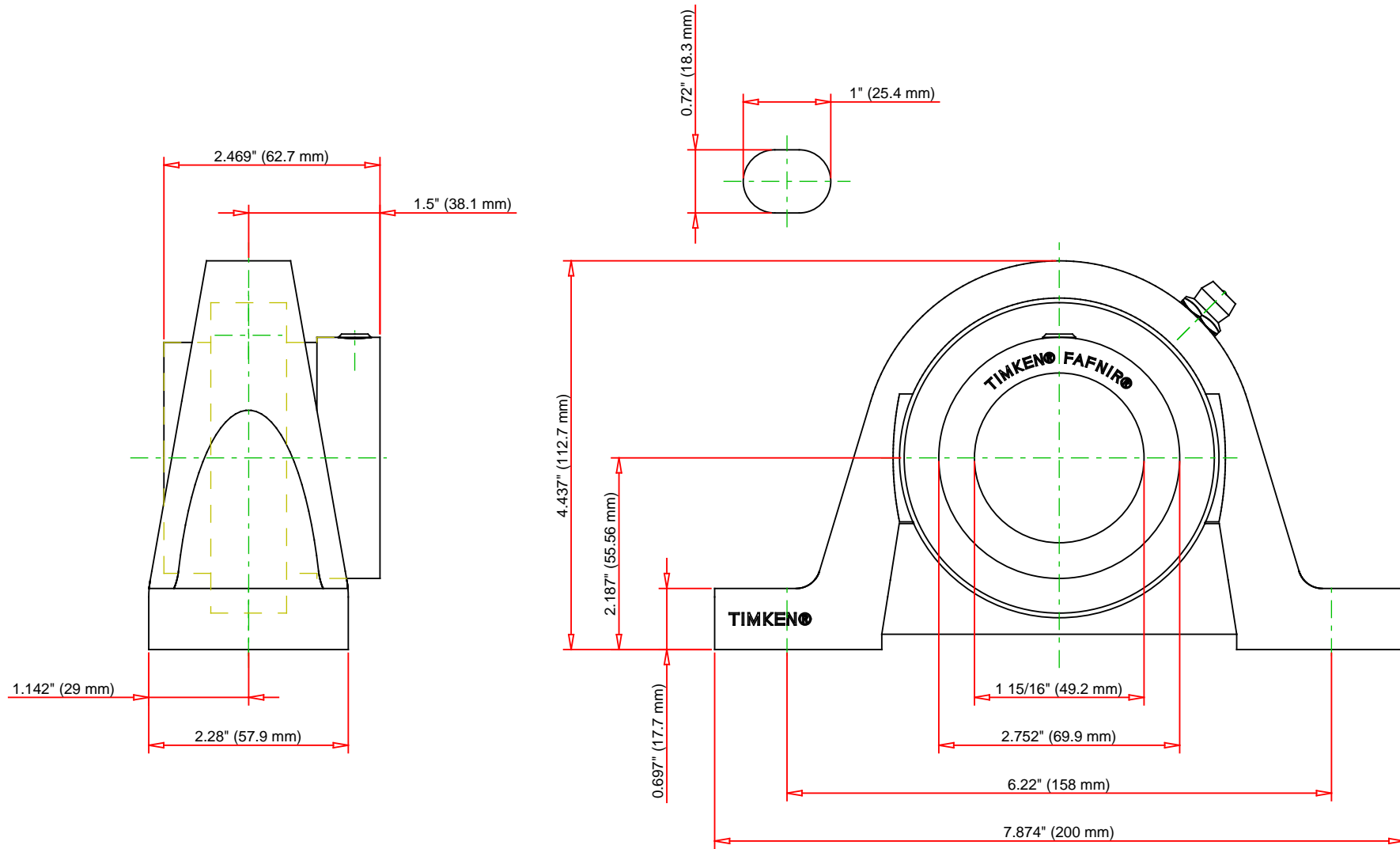

Bearing Number	G1115KRRB			
Load Ratings - $C_r$	8740	lbf	38900	N
Load Ratings - $C_{0r}$	5210	lbf	23200	N
Weight	8.841	lb	4.01	kg

**TIMKEN**

THE TIMKEN COMPANY  
NORTH CANTON, OHIO USA

**RAK1 15/16**

Fafnir® Pillow Block Mounted Bearings Eccentric  
Locking Collar

Every reasonable effort has been made to ensure the accuracy of the information contained in this writing, but no liability is accepted for errors, omissions or for any other reason.

**FOR DISCUSSION ONLY**