

**The Timken Company**

4500 Mt Pleasant St. NW

N. Canton, OH 44720

**Phone:** (234) 262-3000

**E-Mail:** [CustomerCAD@timken.com](mailto:CustomerCAD@timken.com) • **Web site:** [www.timken.com](http://www.timken.com)
**Part Number 23280YMBW507AC08C3, Spherical Roller Bearings - Brass Cage**

Spherical bearings are designed to manage high radial loads even when misalignment, poor lubrication, contamination, extreme speeds or critical application stresses are present.



[Specifications](#) | [Dimensions](#) | [Abutment and Fillet Dimensions](#) | [Basic Load Ratings](#) | [Factors](#)

**Specifications**

<b>Design Unit</b>	Metric
<b>d - Bore</b>	400 mm
<b>Cage Type</b>	YMB
<b>Cage Material</b>	Brass

**Dimensions**

<b>D - Outer Diameter</b>	720 mm 28.3470 in
---------------------------	----------------------



<b>B' - Inner Ring Width</b>	256 mm 10.079 in
<b>B - Outer Ring Width</b>	256 mm 10.0790 in

## Abutment and Fillet Dimensions

<b>R - Inner Ring "To Clear" Radius<sup>1</sup></b>	5 mm 0.200 in
<b>r - Outer Ring "To Clear" Radius<sup>2</sup></b>	5 mm 0.2 in
<b>da - Inner Ring Backing Diameter</b>	466.000 mm 18.4000 in
<b>Da - Outer Ring Backing Diameter</b>	646 mm 25.400 in

## Basic Load Ratings

<b>C0 - Static Radial Rating</b>	10800000 N 2430000 lbf
<b>C1(2) - Dynamic Radial Rating (Two-Rows)</b>	6720000 N 1510000 lbf

## Factors

<b>e - ISO Factor<sup>3</sup></b>	0.34
<b>Y0 - ISO Factor<sup>4</sup></b>	1.92
<b>Y1 - ISO Factor<sup>5</sup></b>	1.96
<b>Y2 - ISO Factor<sup>6</sup></b>	2.93
<b>Reference Thermal Speed Rating (Grease)</b>	350 rpm

<b>Reference Thermal Speed Rating (Oil)<sup>7</sup></b>	380 rpm
---	---------

<b>C<sub>g</sub> - Geometry Factor<sup>8</sup></b>	0.0952
--	--------

<sup>1</sup> Maximum housing fillet radius that bearing corners will clear.

<sup>2</sup> Maximum shaft fillet radius that bearing corners will clear.

<sup>3</sup> These factors apply for both inch and metric calculations. Consult your Timken representative for instruction on use.

<sup>4</sup> These factors apply for both inch and metric calculations. See engineering

<sup>5</sup> These factors apply for both inch and metric calculations. Consult your Timken representative for instruction on use.

<sup>6</sup> These factors apply for both inch and metric calculations. Consult your Timken representative for instruction on use.

<sup>7</sup> See thermal speed ratings in the engineering section.

<sup>8</sup> Geometry constant for Lubrication Life Adjustment Factor a<sub>3l</sub>.

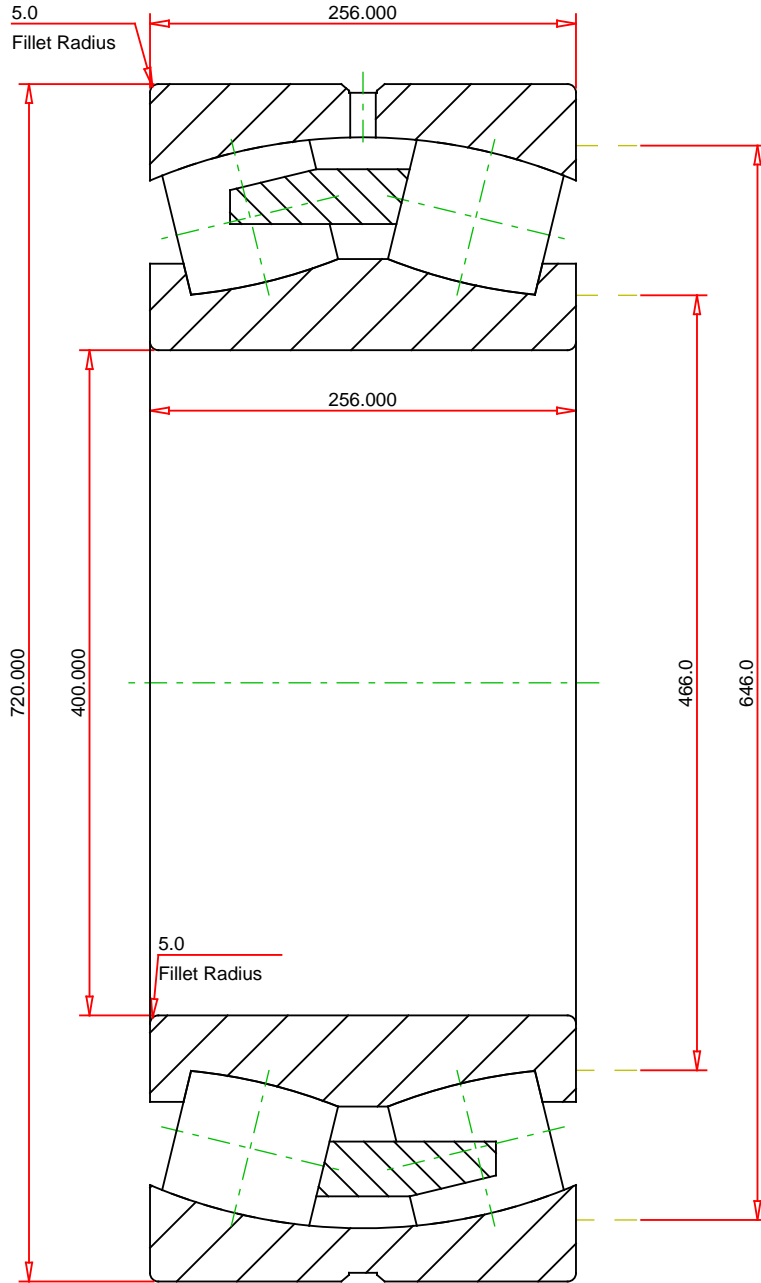

METRIC UNITS

Number of Rollers Per Row	19
ISO Factor e	0.34
ISO Factor Y0	1.92
ISO Factor Y1	1.96
ISO Factor Y2	2.93
Bearing Weight	457.5 kg
Cage Type	YMB
Cage Material	Brass

**TIMKEN**®

**THE TIMKEN COMPANY**  
NORTH CANTON, OHIO USA

<b>23280YMBW507AC08C3</b> SRB ASSEMBLY	
Dynamic Radial Rating (Two Rows)	6720000 N
Static Radial Rating	10800000 N

Every reasonable effort has been made to ensure the accuracy of the information contained in this writing, but no liability is accepted for errors, omissions or for any other reason.

**FOR DISCUSSION ONLY**