

The Timken Company

4500 Mt Pleasant St. NW

N. Canton, OH 44720

Phone: (234) 262-3000

E-Mail: CustomerCAD@timken.com • **Web site:** www.timken.com
Part Number HJ-648032, 6673M

- Clearance fit suggested for outer ring when housing is stationary relative to load.
- Tight transition fit suggested if housing rotates relative to load.
- Consult your Timken representative for oscillating applications (e.g., low radial-clearance concerns).
- Unmarked end of outer ring should be assembled against housing shoulder to clear maximum allowed housing fillet ($r_{as\ max}$).
- Meets Military Standard MS 51961.



[Bearing Dimensions](#) | [Specifications](#) | [Mounting Data](#) | [Sub Assembly Part Numbers](#)

Bearing Dimensions

Shaft Diameter (F_w)	101.60 mm 4.00 in
D - Outer Diameter	127 mm 5 in
Dimension C/B	50.8 mm 2.0000 in

Specifications

Static Load Rating C_0	428000 N 96200 lbf
Dynamic Load Rating $C_1$¹	201000 N 45100 lbf
Geometry Factor C_g²	0.106
Thermal Speed Ratings - Oil	3500 rpm
Thermal Speed Ratings - Grease	3100 rpm

Mounting Data

Chamfer r_{smin}	2.540 mm 0.1 in
Max. Mounting Dimensions Clearance Fit 1	101.60 mm 4.00 in
Min. Mounting Dimensions Clearance Fit 1	101.577 mm 3.9991 in
Max. Mounting Dimensions Clearance Fit 2	127.041 mm 5.0016 in
Min. Mounting Dimensions Clearance Fit 2	127.000 mm 5.000 in
Max. Mounting Dimensions Tight Transition Fit S	3.9986 mm 101.564 in
Min. Mounting Dimensions Tight Transition Fit S	101.542 mm 3.9977 in
Max. Mounting Dimensions Tight Transition Fit H	126.944 mm 4.9978 in
Min. Mounting Dimensions Tight Transition Fit H	126.985 mm 4.9994 in
Shoulder Diameter D_a	117.48 mm 4.625 in

Sub Assembly Part Numbers

**Used with Inner Ring
Designation**

IR-526432

IR-546432

IR-566432

¹ Based on 1×10^6 revolutions L_{10} life, for the ISO life calculation method.

² C_g factor for bearing without inner ring.

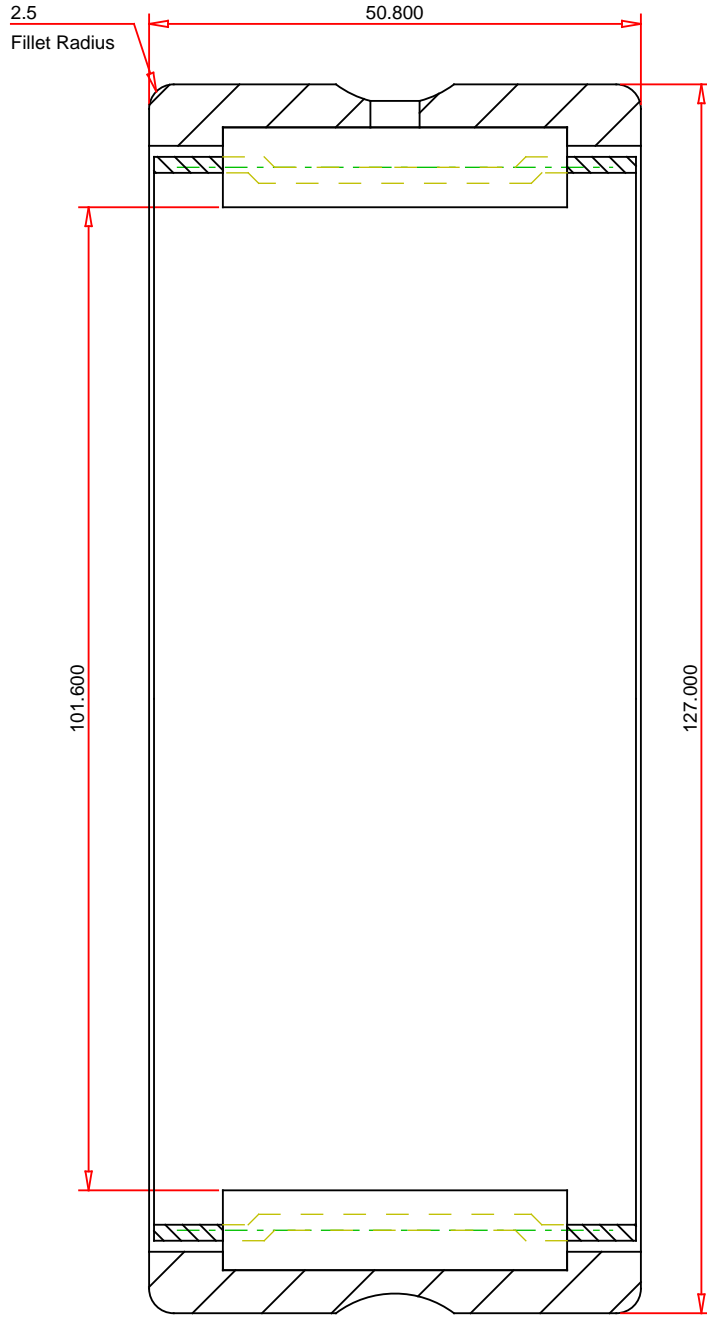

METRIC UNITS

Bearing Weight 1.5 kg

TIMKEN[®]

THE TIMKEN COMPANY
NORTH CANTON, OHIO USA

HJ-648032
CYLINDRICAL ROLLER BEARING

Dynamic Load Rating 201000 N
Static Load Rating 428000 N

Every reasonable effort has been made to ensure the accuracy of the information contained in this writing, but no liability is accepted for errors, omissions or for any other reason.

FOR DISCUSSION ONLY