

The Timken Company

4500 Mt Pleasant St. NW

N. Canton, OH 44720

Phone: (234) 262-3000

E-Mail: CustomerCAD@timken.com • **Web site:** www.timken.com

Part Number S3PP, Fafnir® Deep Groove Ball Bearings (9100K, 200K, 300K)

Radial ball bearings consist of an inner and outer ring with a cage containing a complement of precision balls. The standard Conrad-type bearing has a deep-groove construction capable of handling radial and axial loads from either direction in versatile designs that permit relatively high-speed operation.

In addition to standard single-row deep groove bearings, Timken offers special designs, including a maximum capacity series and an extra large (XLS) radial series bearing.

Size range: 3 mm

[more](#)

[Specifications](#) | [Dimensions](#) | [Basic Load Ratings](#) | [Factors](#) | [Abutment and Fillet Dimensions](#)

Specifications

Design Units	Metric
d - Bore	9.525 mm
Ball Type	STEEL
Manufacturing Part Number	PS3PP Z1 FS50160

Dimensions



D - Outer Diameter	22.23 mm 0.875 in
Bearing Width	7.142 mm 0.2812 in

Basic Load Ratings

Ce - Dynamic Radial Rating¹	3700 N 830 lbf
C0 - Static Radial Rating	1410 N 320 lbf

Factors

Limiting Speed (Grease)	18748 rpm
Limiting Speed (Oil)	21872 rpm

Abutment and Fillet Dimensions

R - Inner Ring "To Clear" Radius²	0.41 mm 0.016 in
r - Outer Ring "To Clear" Radius³	0.41 mm 0.016 in
da - Inner Ring Backing Diameter	12.19 mm 0.4800 in
Da - Outer Ring Backing Diameter	20.32 mm 0.8000 in

¹ Based on 10^6 revolutions of calculated fatigue life.

² Maximum housing fillet radius that bearing corners will clear.

³ Maximum shaft fillet radius that bearing corners will clear.

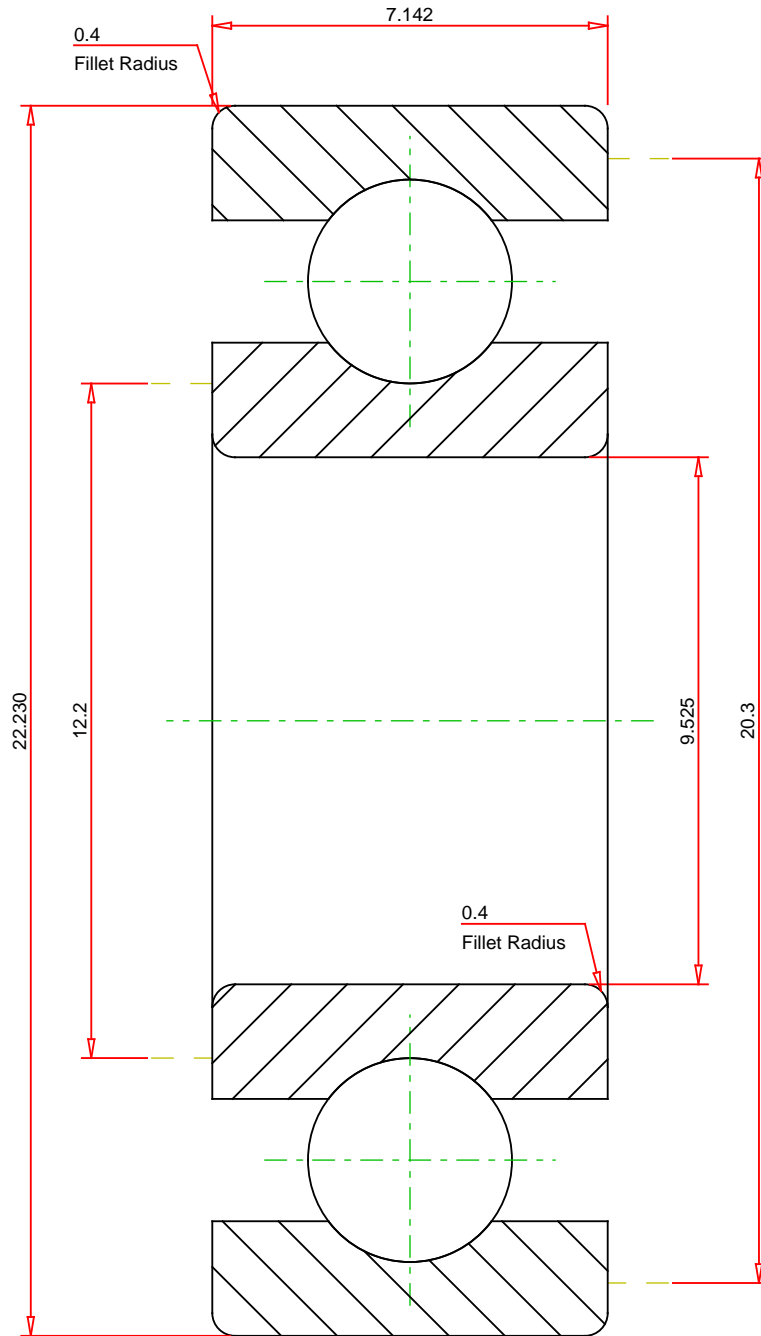

METRIC UNITS

Number of Balls Per Row 7
 Bearing Weight 0.010 kg

TIMKEN®

THE TIMKEN COMPANY
 NORTH CANTON, OHIO USA

S3PP
 Fafnir® Deep Groove Ball Bearings (9100K, 200K, 300K)

Dynamic Radial Rating 3700 N
 Static Radial Rating 1410 N

Every reasonable effort has been made to ensure the accuracy of the information contained in this writing, but no liability is accepted for errors, omissions or for any other reason.

FOR DISCUSSION ONLY