

The Timken Company

4500 Mt Pleasant St. NW

N. Canton, OH 44720

Phone: (234) 262-3000

E-Mail: CustomerCAD@timken.com • **Web site:** www.timken.com

Part Number 9104K, Fafnir® Deep Groove Ball Bearings (9100K, 200K, 300K)

Radial ball bearings consist of an inner and outer ring with a cage containing a complement of precision balls. The standard Conrad-type bearing has a deep-groove construction capable of handling radial and axial loads from either direction in versatile designs that permit relatively high-speed operation.

In addition to standard single-row deep groove bearings, Timken offers special designs, including a maximum capacity series and an extra large (XLS) radial series bearing.

Size range: 3 mm

[more](#)

[Specifications](#) | [Dimensions](#) | [Basic Load Ratings](#) | [Factors](#) | [Abutment and Fillet Dimensions](#)

Specifications

Design Units	Metric
d - Bore	20 mm
Ball Type	STEEL
Manufacturing Part Number	9104K Z5 FS50000

Dimensions



D - Outer Diameter	42 mm 1.654 in
Bearing Width	12 mm 0.4724 in

Basic Load Ratings

Ce - Dynamic Radial Rating¹	10409 N 2340 lbf
C0 - Static Radial Rating	5026 N 1130 lbf

Factors

Limiting Speed (Grease)	9680 rpm
Limiting Speed (Oil)	11290 rpm

Abutment and Fillet Dimensions

R - Inner Ring "To Clear" Radius²	0.6 mm 0.024 in
r - Outer Ring "To Clear" Radius³	0.6 mm 0.024 in
da - Inner Ring Backing Diameter	22.60 mm 0.890 in
Da - Outer Ring Backing Diameter	37.10 mm 1.4600 in

¹ Based on 10^6 revolutions of calculated fatigue life.

² Maximum housing fillet radius that bearing corners will clear.

³ Maximum shaft fillet radius that bearing corners will clear.

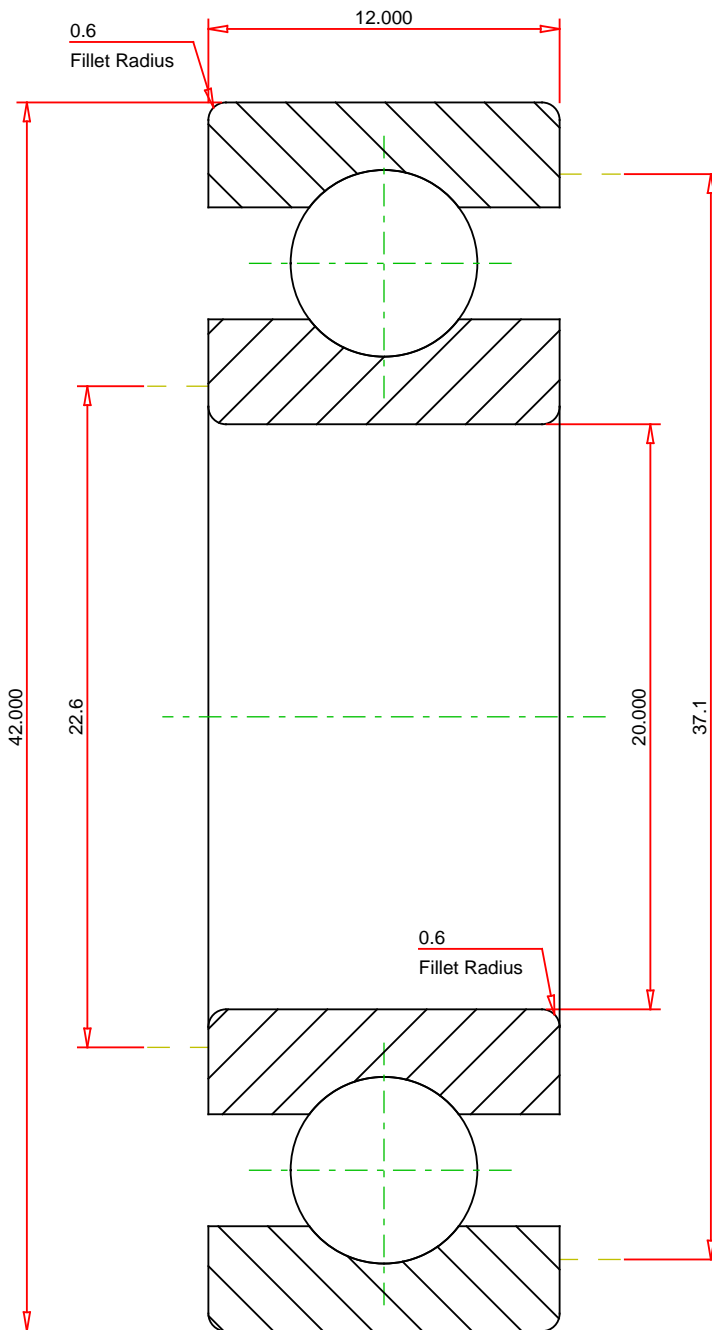

METRIC UNITS

Number of Balls Per Row	9
Bearing Weight	0.073 kg

TIMKEN®

THE TIMKEN COMPANY
NORTH CANTON, OHIO USA

9104K	
Fafnir® Deep Groove Ball Bearings (9100K, 200K, 300K)	
Dynamic Radial Rating	10409 N
Static Radial Rating	5026 N

Every reasonable effort has been made to ensure the accuracy of the information contained in this writing, but no liability is accepted for errors, omissions or for any other reason.

FOR DISCUSSION ONLY