

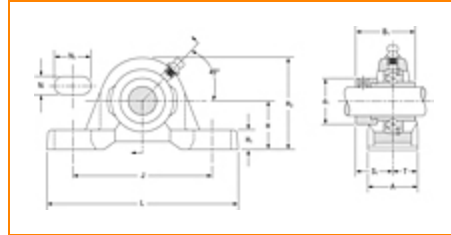

The Timken Company

4500 Mt Pleasant St. NW

N. Canton, OH 44720

Phone: (234) 262-3000

E-Mail: CustomerCAD@timken.com • **Web site:** www.timken.com
Part Number RAK2 15/16, Fafnir® Pillow Block Mounted Bearings Eccentric Locking Collar

[Specifications](#) | [Dimensions](#) | [Basic Load Ratings](#)
Specifications

Series	Industrial
Shaft Size d	2 15/16 in
Bearing Type	Ball Bearing
Bearing Number	G1215KRRB
Seal Type	Shroud Seal
Housing Construction	Two-Bolt Pillow Block
Alternate Part Name	RAK2 15/16

Dimensions

Base to Center Height H	84.14 mm 3.313 in
Total Length L	304.8 mm 12 in



Total Width A	82.6 mm 3.252 in
Bolt Hole Spacing J	241.3 mm 9.5 in
Bolt Hole Width N	22.2 mm 0.874 in
Bolt Hole Length N1	31.8 mm 1.252 in
Foot Height H1	38.1 mm
Total Height H2	163.5 mm 6.437 in
Dimension d1	101.6 mm 4 in
Dimension B1	92.1 mm 3.6260 in
Dimension S1	54.8 mm 2.157 in
Dimension T	41.3 mm 1.626 in

Basic Load Ratings

Static Load Rating	44800 N 10100 lbf
Dynamic Load Rating	68900 N 15500 lbf

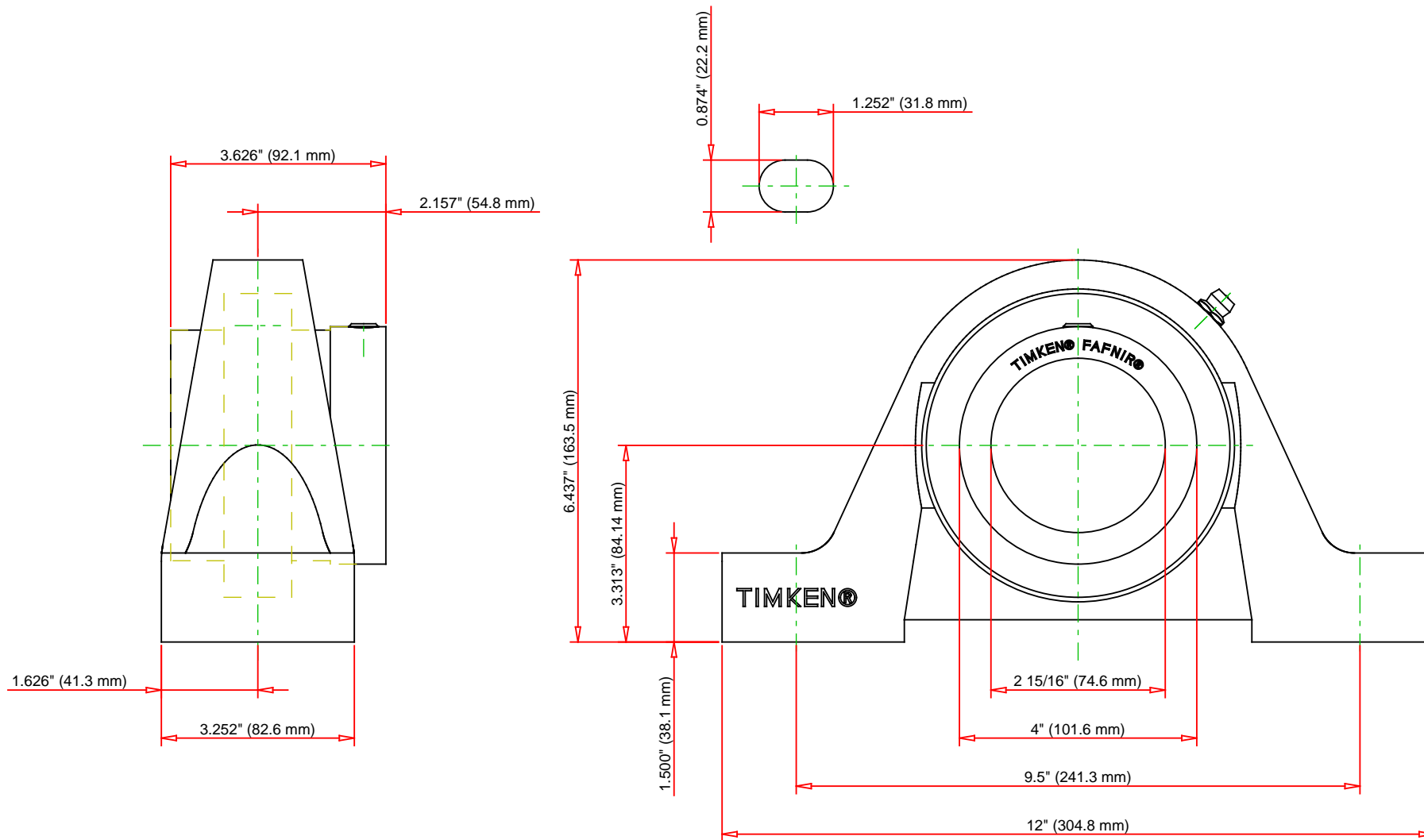

Bearing Number	G1215KRRB			
Load Ratings - C_r	15500	lbf	68900	N
Load Ratings - C_{0r}	10100	lbf	44800	N
Weight	19.899	lb	9.026	kg

TIMKEN
 THE TIMKEN COMPANY
 NORTH CANTON, OHIO USA

RAK2 15/16
 Fafnir® Pillow Block Mounted Bearings Eccentric
 Locking Collar

Every reasonable effort has been made to ensure the accuracy of the information contained in this writing, but no liability is accepted for errors, omissions or for any other reason.

FOR DISCUSSION ONLY