



**The Timken Company**

4500 Mt Pleasant St. NW

N. Canton, OH 44720

**Phone:** (234) 262-3000

**E-Mail:** [CustomerCAD@timken.com](mailto:CustomerCAD@timken.com) • **Web site:** [www.timken.com](http://www.timken.com)

## Part Number RAS1 5/16, Fafnir® Pillow Block Mounted Bearings Eccentric Locking Collar

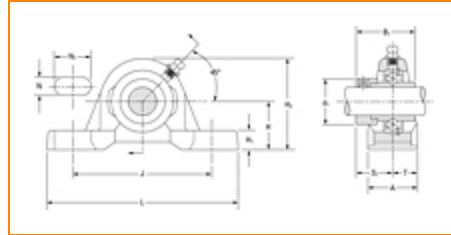

[Specifications](#) | [Dimensions](#) | [Basic Load Ratings](#)

### Specifications

<b>Series</b>	Industrial
<b>Shaft Size d</b>	1 5/16 in
<b>Bearing Type</b>	Ball Bearing
<b>Bearing Number</b>	G1105KRRB
<b>Seal Type</b>	Shroud Seal
<b>Housing Construction</b>	Two-Bolt Pillow Block
<b>Alternate Part Name</b>	RAS1 5/16

### Dimensions

<b>Base to Center Height H</b>	47.63 mm 1.875 in
<b>Total Length L</b>	166.7 mm 6.563 in



<b>Total Width A</b>	46.8 mm 1.843 in
<b>Bolt Hole Spacing J</b>	130.2 mm 5.126 in
<b>Bolt Hole Width N</b>	14.3 mm 0.563 in
<b>Bolt Hole Length N1</b>	24.6 mm 0.969 in
<b>Foot Height H1</b>	18.3 mm
<b>Total Height H2</b>	95.3 mm 3.752 in
<b>Dimension d1</b>	54 mm 2.126 in
<b>Dimension B1</b>	51.2 mm 2.016 in
<b>Dimension S1</b>	32.35 mm 1.274 in
<b>Dimension T</b>	23.4 mm 0.921 in

## Basic Load Ratings

<b>Static Load Rating</b>	15300 N 3440 lbf
<b>Dynamic Load Rating</b>	28500 N 6400 lbf

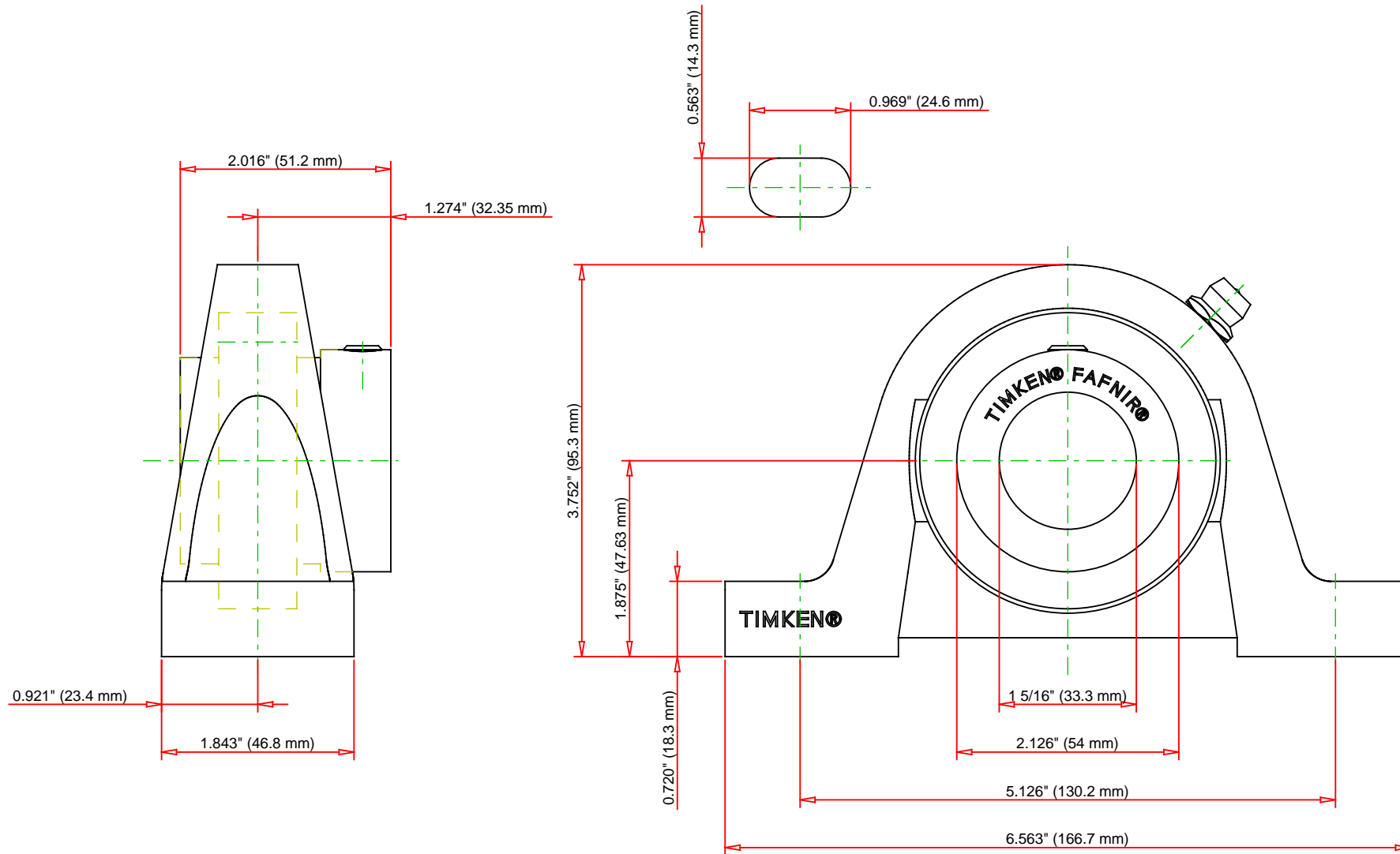

Bearing Number	G1105KRRB			
Load Ratings - C <sub>r</sub>	6400	lbf	28500	N
Load Ratings - C <sub>0r</sub>	3440	lbf	15300	N
Weight	4.167	lb	1.89	kg

**TIMKEN**

THE TIMKEN COMPANY  
NORTH CANTON, OHIO USA

**RAS1 5/16**  
Fafnir® Pillow Block Mounted Bearings Eccentric  
Locking Collar

Every reasonable effort has been made to ensure the accuracy of the information contained in this writing, but no liability is accepted for errors, omissions or for any other reason.

**FOR DISCUSSION ONLY**