



The Timken Company

4500 Mt Pleasant St. NW

N. Canton, OH 44720

Phone: (234) 262-3000

E-Mail: CustomerCAD@timken.com • **Web site:** www.timken.com

Part Number SAS1 3/8, Fafnir® Pillow Block Mounted Bearings Setscrew Locking



[Specifications](#) | [Dimensions](#) | [Basic Load Ratings](#)

Specifications

Series	Standard
Shaft Size d	1 3/8 in
Bearing Type	Ball Bearing
Bearing Number	GYA106RRB
Seal Type	Narrow Shroud
Housing Construction	Two-Bolt Pillow Block
Alternate Part Name	SAS1 3/8

Dimensions

Base to Center Height H	47.62 mm 1.875 in
Total Length L	166.7 mm 6.563 in



Total Width A	45.2 mm 1.78 in
Bolt Hole Spacing J	130.2 mm 5.126 in
Bolt Hole Width N	14.3 mm 0.563 in
Bolt Hole Length N1	24.6 mm 0.969 in
Foot Height H1	18.3 mm
Total Height H2	93.6 mm 3.685 in
Inside Ring Width B	36.5 mm 1.4370 in
Dimension S1	25.65 mm 1.01 in
Dimension F	46.8 mm 1.8430 in

Basic Load Ratings

Static Load Rating	15300 N 3440 lbf
Dynamic Load Rating	28500 N 6400 lbf

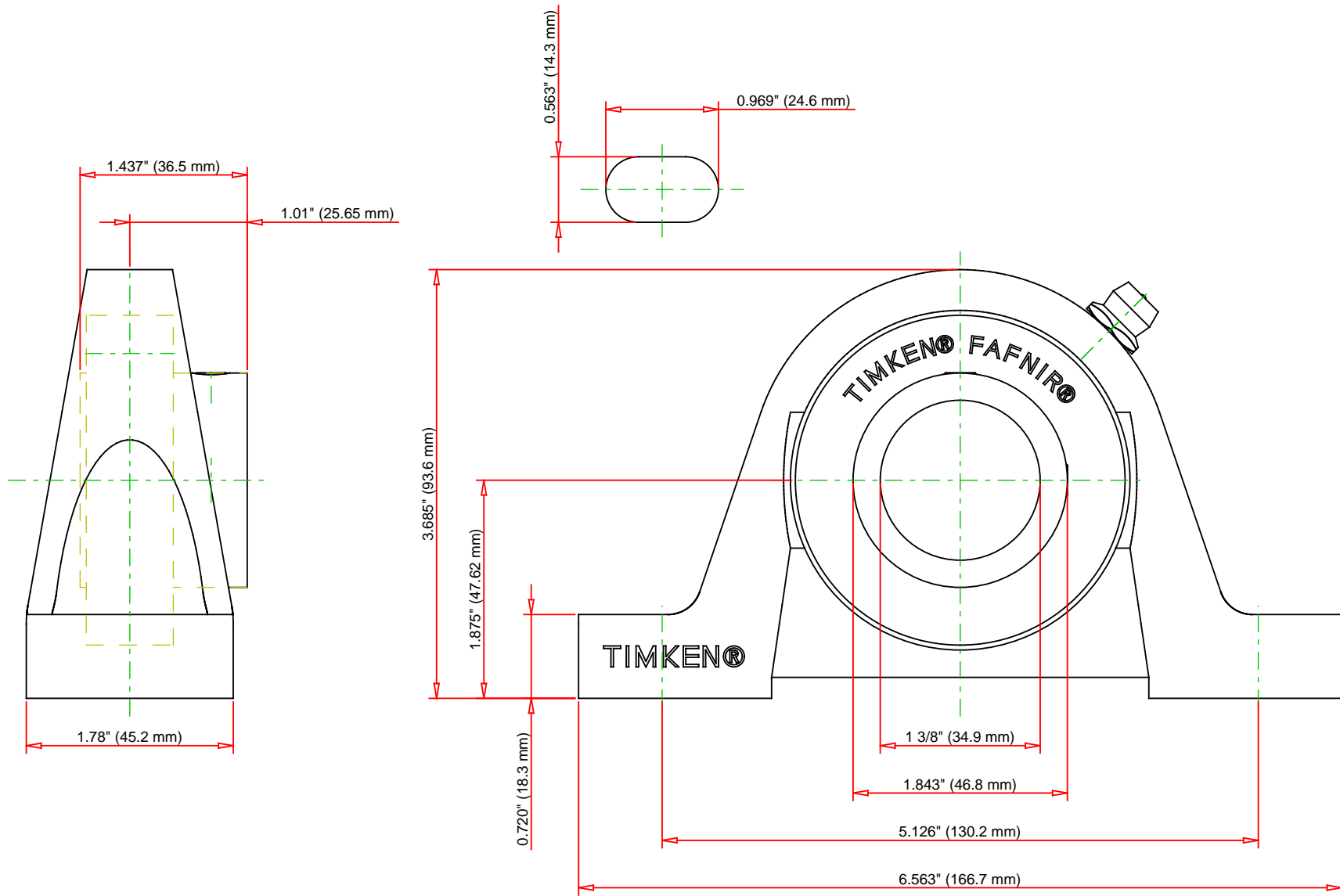

Bearing Number	GYA106RRB			
Load Ratings - C _r	6400	lbf	28500	N
Load Ratings - C _{0r}	3440	lbf	15300	N
Weight	3.351	lb	1.52	kg
Bolt Size	M8x1.25			

TIMKEN

THE TIMKEN COMPANY
NORTH CANTON, OHIO USA

SAS1 3/8

Fafnir® Pillow Block Mounted Bearings Setscrew Locking

Every reasonable effort has been made to ensure the accuracy of the information contained in this writing, but no liability is accepted for errors, omissions or for any other reason.

FOR DISCUSSION ONLY