

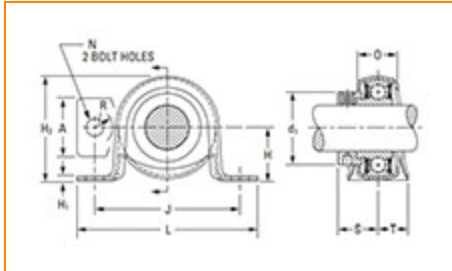

The Timken Company

4500 Mt Pleasant St. NW

N. Canton, OH 44720

Phone: (234) 262-3000

E-Mail: CustomerCAD@timken.com • **Web site:** www.timken.com
Part Number PB 1/2, Fafnir® Pillow Block Mounted Bearings Eccentric Locking Collar

[Specifications](#) | [Dimensions](#) | [Basic Load Ratings](#)
Specifications

Series	Light-Duty
Shaft Size d	0.5000 in
Bearing Type	Ball Bearing
Bearing Number	RA008RRB
Seal Type	Shroud Seal
Housing Construction	Two-Bolt Pillow Block
Alternate Part Name	PB 1/2

Dimensions

Base to Center Height H	22.2 mm 0.875 in
--------------------------------	---------------------



Total Length L	92.1 mm 3.625 in
Total Width A	25.4 mm 1 in
Bolt Hole Width N	8.7 mm 0.344 in
Foot Height H1	2.54 mm 0.1 in
Total Height H2	44.4 mm 1.75 in
Dimension d1	28.6 mm 1.126 in
Dimension B1	28.6 mm 1.126 in
Dimension S1	22.1 mm 0.87 in
Dimension T	12.7 mm 0.5 in

Basic Load Ratings

Static Load Rating	4700 N 1070 lbf
Dynamic Load Rating	10700 N 2380 lbf

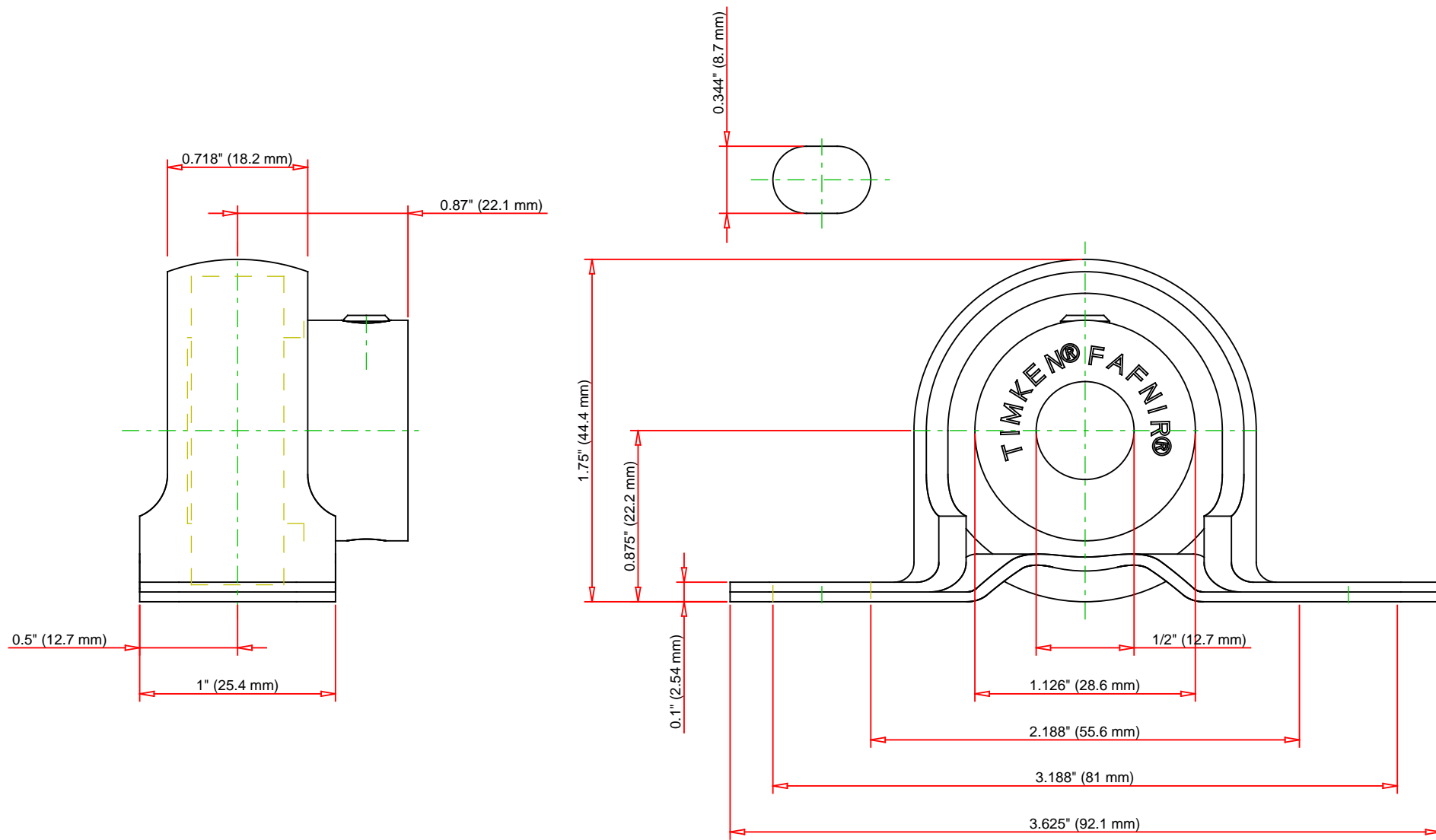

Bearing Number	RA008RRB			
Load Ratings - C _r	2380	lbf	10700	N
Load Ratings - C _{0r}	1070	lbf	4700	N
Weight	0.44	lb	0.2	kg

TIMKEN[®]

THE TIMKEN COMPANY
NORTH CANTON, OHIO USA

PB 1/2

Fafnir[®] Pillow Block Mounted Bearings Eccentric
Locking Collar

Every reasonable effort has been made to ensure the accuracy of the information contained in this writing, but no liability is accepted for errors, omissions or for any other reason.

FOR DISCUSSION ONLY