

The Timken Company

4500 Mt Pleasant St. NW

N. Canton, OH 44720

Phone: (234) 262-3000

E-Mail: CustomerCAD@timken.com • **Web site:** www.timken.com

Part Number W206PPG, Fafnir® Deep Groove Ball Bearings (9100K, 200K, 300K)

Radial ball bearings consist of an inner and outer ring with a cage containing a complement of precision balls. The standard Conrad-type bearing has a deep-groove construction capable of handling radial and axial loads from either direction in versatile designs that permit relatively high-speed operation.

In addition to standard single-row deep groove bearings, Timken offers special designs, including a maximum capacity series and an extra large (XLS) radial series bearing.

Size range: 3 mm

[more](#)

[Specifications](#) | [Dimensions](#) | [Basic Load Ratings](#) | [Factors](#) | [Abutment and Fillet Dimensions](#)

Specifications

Design Units	Metric
d - Bore	30 mm
Ball Type	STEEL
Manufacturing Part Number	W206PPGZ17P

Dimensions



D - Outer Diameter	62 mm 2.441 in
Bearing Width	23.83 mm 0.9382 in

Basic Load Ratings

Ce - Dynamic Radial Rating¹	21600 N 4850 lbf
C0 - Static Radial Rating	11300 N 2530 lbf

Factors

Limiting Speed (Grease)	6522 rpm
Limiting Speed (Oil)	7609 rpm

Abutment and Fillet Dimensions

R - Inner Ring "To Clear" Radius²	1 mm 0.039 in
r - Outer Ring "To Clear" Radius³	1 mm 0.039 in
da - Inner Ring Backing Diameter	34.04 mm 1.3400 in
Da - Outer Ring Backing Diameter	56.13 mm 2.210 in

¹ Based on 10^6 revolutions of calculated fatigue life.

² Maximum housing fillet radius that bearing corners will clear.

³ Maximum shaft fillet radius that bearing corners will clear.

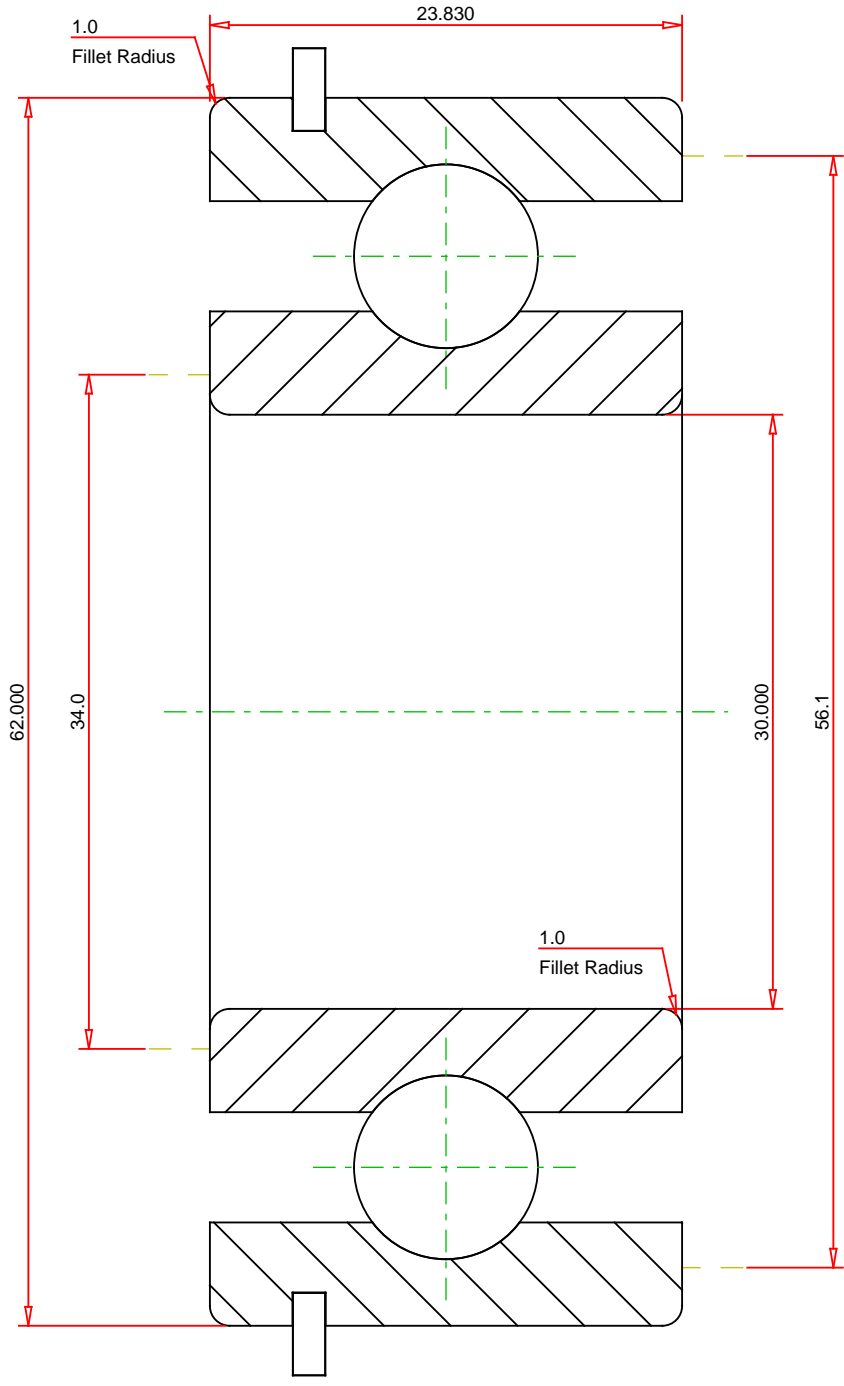

METRIC UNITS

Number of Balls Per Row	9
Bearing Weight	0.295 kg

TIMKEN®

THE TIMKEN COMPANY
NORTH CANTON, OHIO USA

W206PPG	
Fafnir® Deep Groove Ball Bearings (9100K, 200K, 300K)	
Dynamic Radial Rating	21600 N
Static Radial Rating	11300 N

Every reasonable effort has been made to ensure the accuracy of the information contained in this writing, but no liability is accepted for errors, omissions or for any other reason.

FOR DISCUSSION ONLY