

**The Timken Company**

4500 Mt Pleasant St. NW

N. Canton, OH 44720

**Phone:** (234) 262-3000

**E-Mail:** [CustomerCAD@timken.com](mailto:CustomerCAD@timken.com) • **Web site:** [www.timken.com](http://www.timken.com)
**Part Number 6214-RS, Deep Groove Ball Bearings (6000, 6200, 6300, 6400)**

Timken's deep groove ball bearings deliver reliable performance in a wide range of applications and conditions. With super-finished raceways and controlled geometries, our premium design helps ensure consistent quality.



[Specifications](#) | [Dimensions](#) | [Basic Load Ratings](#) | [Factors](#)

**Specifications**

<b>Clearance</b>	C0 (Normal)
<b>Bore Size d</b>	70 mm
<b>Features</b>	One Contact Seal
<b>Bearing Type</b>	Standard DGBB

**Dimensions**

<b>Outside Diameter D</b>	125 mm
<b>Outside Ring Width B</b>	24 mm
<b>Radius Rs min</b>	1.5 mm



## Basic Load Ratings

**Cr - Dynamic Load Rating** 60800 N

**C0r - Static Load Rating** 44000 N

## Factors

**Grease Reference Speed** 5700 rpm

**Oil Reference Speed** 8300 rpm

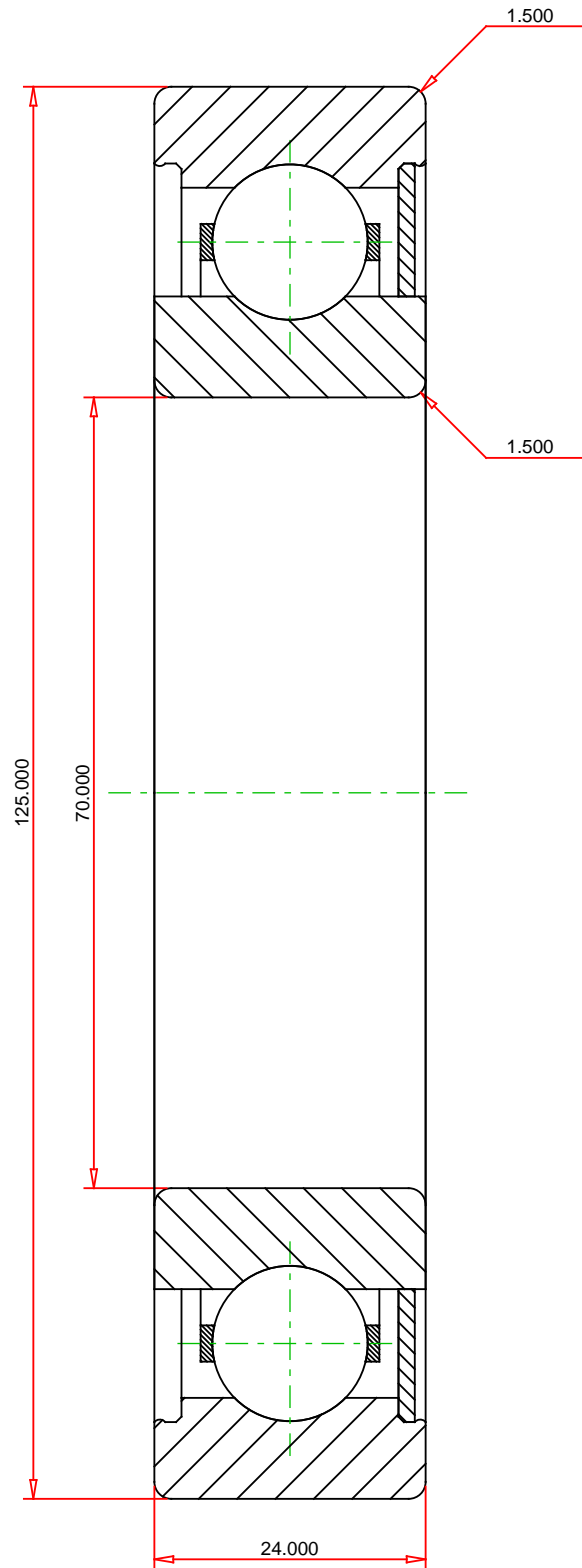

METRIC UNITS

Weight 1.1 kg

**TIMKEN**®

**THE TIMKEN COMPANY**  
NORTH CANTON, OHIO USA

**6214-RS**  
Deep Groove Ball Bearings (6000, 6200, 6300, 6400)

Dynamic Load Rating 60800 N  
Static Load Rating 44000 N

Every reasonable effort has been made to ensure the accuracy of the information contained in this writing, but no liability is accepted for errors, omissions or for any other reason.

**FOR DISCUSSION ONLY**