

The Timken Company

4500 Mt Pleasant St. NW

N. Canton, OH 44720

Phone: (234) 262-3000

E-Mail: CustomerCAD@timken.com • **Web site:** www.timken.com
Part Number 22206EMW33, Spherical Roller Bearings - Brass Cage

Spherical bearings are designed to manage high radial loads even when misalignment, poor lubrication, contamination, extreme speeds or critical application stresses are present.



[Specifications](#) | [Dimensions](#) | [Abutment and Fillet Dimensions](#) | [Basic Load Ratings](#) | [Factors](#)

Specifications

Design Unit	Metric
d - Bore	30 mm
Cage Type	EM
Cage Material	Brass
Superseded Part	22206YMW33

Dimensions

D - Outer Diameter	62 mm 2.4409 in
 d' - Inner Ring Width	20 mm 0.7874 in

B - Outer Ring Width	20 mm 0.7874 in
-----------------------------	--------------------

Abutment and Fillet Dimensions

R - Inner Ring "To Clear" Radius¹	1 mm 0.040 in
r - Outer Ring "To Clear" Radius²	1 mm 0.04 in
da - Inner Ring Backing Diameter	38.000 mm 1.500 in
Da - Outer Ring Backing Diameter	56 mm 2.200 in

Basic Load Ratings

C0 - Static Radial Rating	64300 N 14400 lbf
C1(2) - Dynamic Radial Rating (Two-Rows)	56800 N 12800 lbf

Factors

e - ISO Factor³	0.31
Y0 - ISO Factor⁴	2.1
Y1 - ISO Factor⁵	2.15
Y2 - ISO Factor⁶	3.2
Reference Thermal Speed Rating (Grease)	7900 rpm

Reference Thermal Speed Rating (Oil)⁷	9900 rpm
---	----------

Cg - Geometry Factor⁸	0.0368
---	--------

¹ Maximum housing fillet radius that bearing corners will clear.

² Maximum shaft fillet radius that bearing corners will clear.

³ These factors apply for both inch and metric calculations. Consult your Timken representative for instruction on use.

⁴ These factors apply for both inch and metric calculations. See engineering

⁵ These factors apply for both inch and metric calculations. Consult your Timken representative for instruction on use.

⁶ These factors apply for both inch and metric calculations. Consult your Timken representative for instruction on use.

⁷ See thermal speed ratings in the engineering section.

⁸ Geometry constant for Lubrication Life Adjustment Factor a3l.

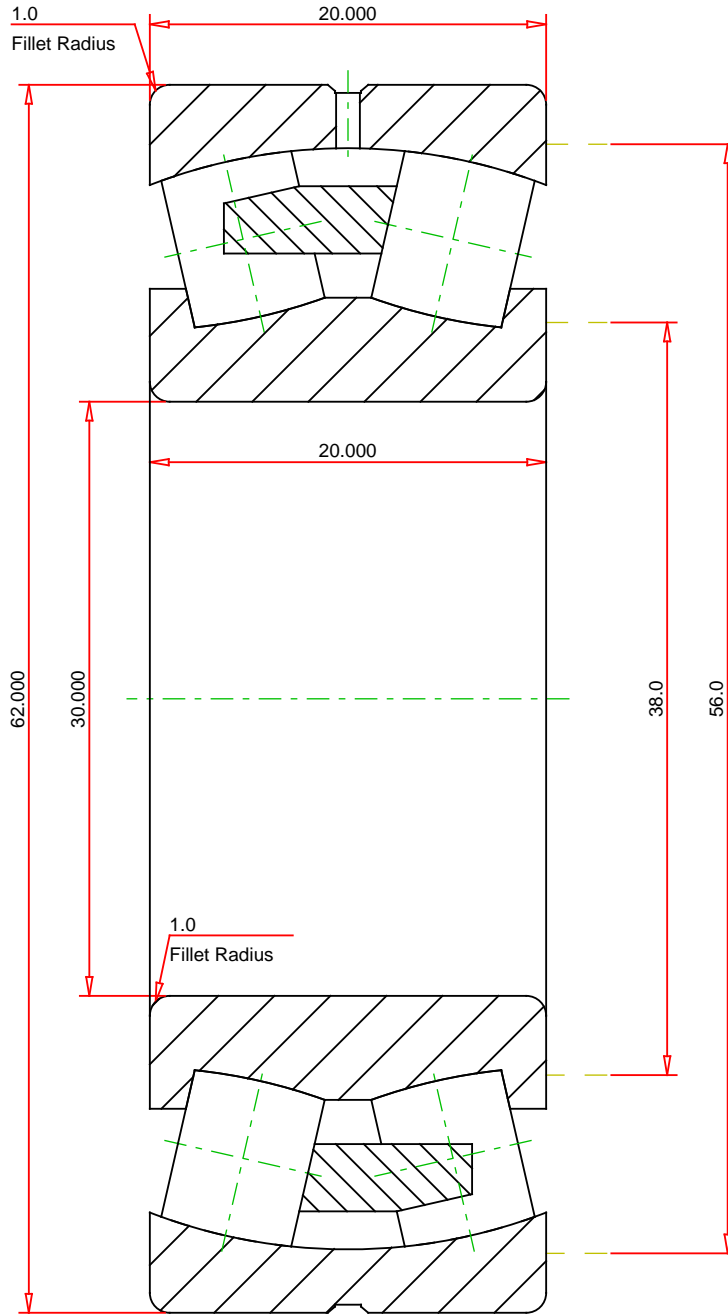

METRIC UNITS

Number of Rollers Per Row	14
ISO Factor e	0.31
ISO Factor Y0	2.10
ISO Factor Y1	2.15
ISO Factor Y2	3.20
Bearing Weight	0.3 kg
Cage Type	EM
Cage Material	Brass

TIMKEN®

22206EMW33
SRB ASSEMBLY

THE TIMKEN COMPANY
NORTH CANTON, OHIO USA

Dynamic Radial Rating (Two Rows)	56800	N
Static Radial Rating	64300	N

Every reasonable effort has been made to ensure the accuracy of the information contained in this writing, but no liability is accepted for errors, omissions or for any other reason.

FOR DISCUSSION ONLY