



The Timken Company

4500 Mt Pleasant St. NW

N. Canton, OH 44720

Phone: (234) 262-3000

E-Mail: CustomerCAD@timken.com • **Web site:** www.timken.com

Part Number UCP201-8, UCP 200 Pillow Block Mounted Bearings - Set Screw Locking

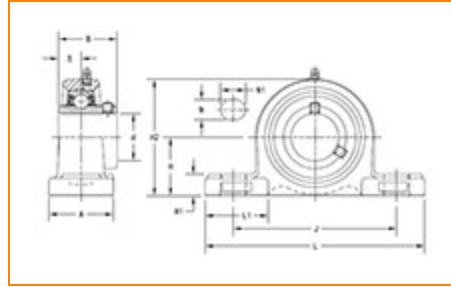

[Specifications](#) | [Dimensions](#) | [Basic Load Ratings](#)

Specifications

Bearing Number	UC201-8
Shaft Size d	0.5000 in
UPC Code	087796070936
Locking Style	Set Screw Locking
Housing Construction	Two-Bolt Pillow Block

Dimensions

Base to Center Height H	30.2 mm 1.189 in
Total Length L	127 mm 5 in



Housing Width A	38 mm 1.496 in
Bolt Hole Spacing J	95 mm 3.74 in
Bolt Hole Size N	13 mm 0.512 in
Bolt Hole Length N1	18 mm 0.709 in
Foot Height H1	16 mm
Total Height H2	60 mm 2.362 in
Dimension L1	36 mm 1.406 in
Inner Ring Width B	31 mm 1.22 in
Center of Bearing from End S	12.7 mm 0.5 in

Basic Load Ratings

Static Load Rating	6650 N 1495 lbf
Dynamic Load Rating	12800 N 2878 lbf

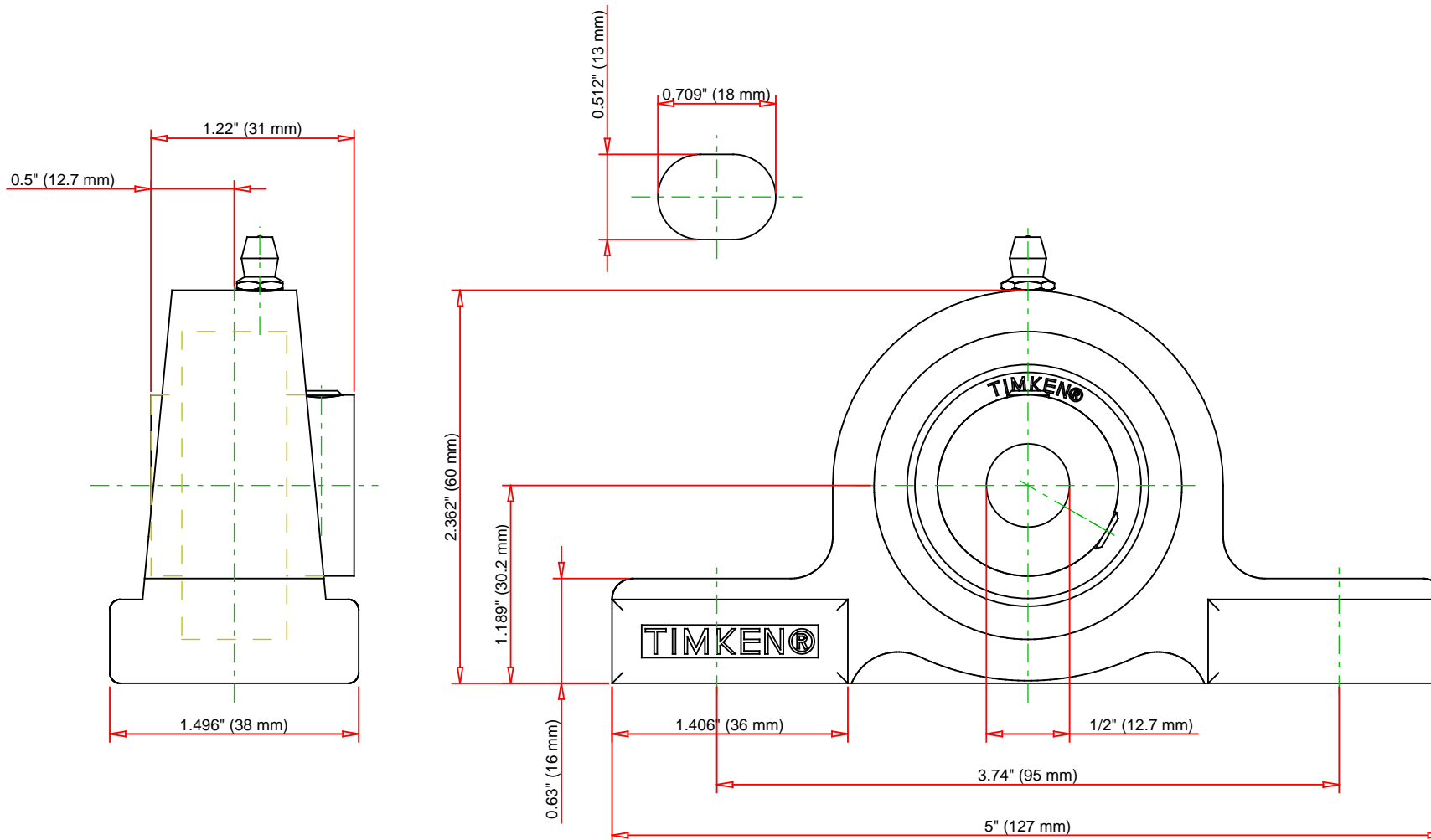

Bearing Number	UC201-8			
Load Ratings - C _r	2878	lbf	12800	N
Load Ratings - C _{0r}	1495	lbf	6650	N
Weight	1.3	lb	0.6	kg
Bolt Size	M10			

TIMKEN

THE TIMKEN COMPANY
NORTH CANTON, OHIO USA

UCP201-8

UCP 200 Pillow Block Mounted Bearings -
Set Screw Locking

Every reasonable effort has been made to ensure the accuracy of the information contained in this writing, but no liability is accepted for errors, omissions or for any other reason.

FOR DISCUSSION ONLY