



The Timken Company

4500 Mt Pleasant St. NW

N. Canton, OH 44720

Phone: (234) 262-3000

E-Mail: CustomerCAD@timken.com • **Web site:** www.timken.com

Part Number UCP217-52, UCP 200 Pillow Block Mounted Bearings - Set Screw Locking

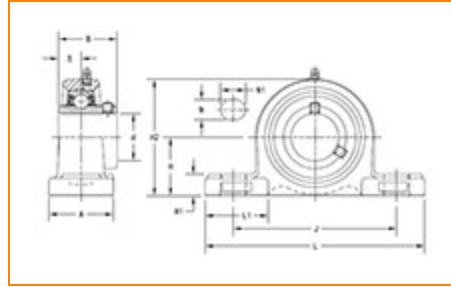

[Specifications](#) | [Dimensions](#) | [Basic Load Ratings](#)

Specifications

| | |
|-----------------------------|-----------------------|
| Bearing Number | UC217-52 |
| Shaft Size d | 3 1/4 in |
| UPC Code | 087796141087 |
| Locking Style | Set Screw Locking |
| Housing Construction | Two-Bolt Pillow Block |

Dimensions

| | |
|--------------------------------|---------------------|
| Base to Center Height H | 95.2 mm 3.748 in |
| Total Length L | 310 mm 12.205 in |



| | |
|-------------------------------------|----------------------|
| Housing Width A | 83 mm 3.268 in |
| Bolt Hole Spacing J | 247 mm 9.724 in |
| Bolt Hole Size N | 25 mm 0.984 in |
| Bolt Hole Length N1 | 35 mm 1.378 in |
| Foot Height H1 | 32 mm |
| Total Height H2 | 185 mm 7.283 in |
| Dimension L1 | 87 mm 3.438 in |
| Inner Ring Width B | 85.7 mm 3.3740 in |
| Center of Bearing from End S | 34.1 mm 1.343 in |

Basic Load Ratings

| | |
|----------------------------|----------------------|
| Static Load Rating | 61900 N 13916 lbf |
| Dynamic Load Rating | 84000 N 18884 lbf |

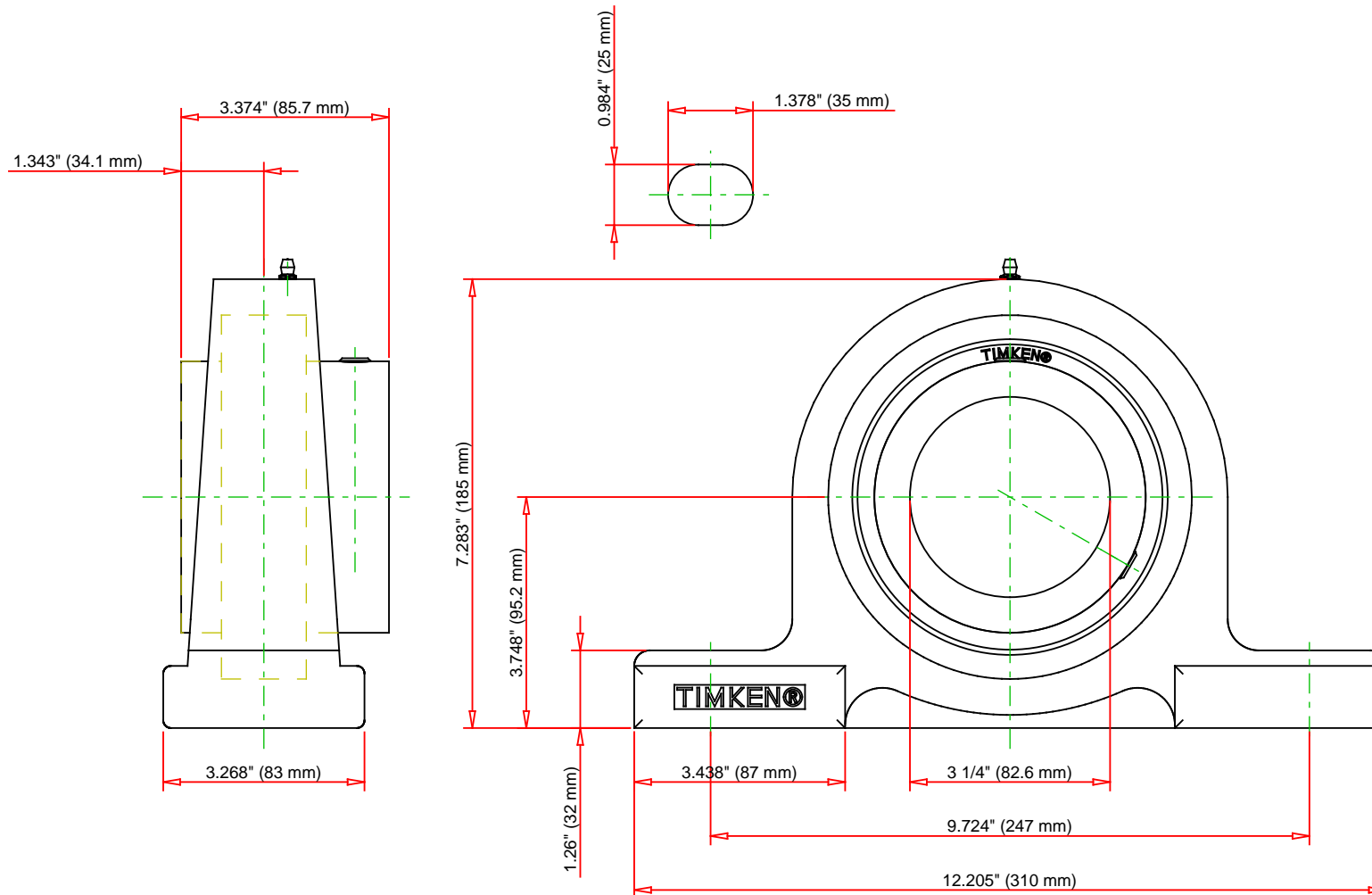

| | | | |
|--------------------------------|----------|-----|-------|
| Bearing Number | UC217-52 | | |
| Load Ratings - C _r | 18884 | lbf | 84000 |
| Load Ratings - C _{0r} | 13916 | lbf | 61900 |
| Weight | 23.8 | lb | 10.8 |
| Bolt Size | M20 | | |

TIMKEN

THE TIMKEN COMPANY
NORTH CANTON, OHIO USA

UCP217-52

UCP 200 Pillow Block Mounted Bearings -
Set Screw Locking

Every reasonable effort has been made to ensure the accuracy of the information contained in this writing, but no liability is accepted for errors, omissions or for any other reason.

FOR DISCUSSION ONLY