



The Timken Company

4500 Mt Pleasant St. NW

N. Canton, OH 44720

Phone: (234) 262-3000

E-Mail: CustomerCAD@timken.com • **Web site:** www.timken.com

Part Number 16012-C3, Narrow Section Ball Bearings (16000, 16100)

Timken's deep groove ball bearings deliver reliable performance in a wide range of applications and conditions. With super-finished raceways and controlled geometries, our premium design helps ensure consistent quality.

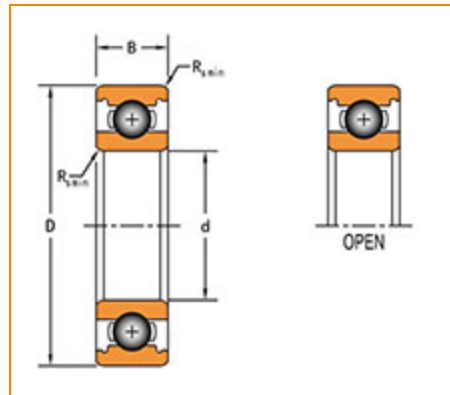

[Specifications](#) | [Dimensions](#) | [Basic Load Ratings](#) | [Factors](#)

Specifications

Clearance	C3
Bore Size d	60 mm
Features	Open

Dimensions

Outside Diameter D	95 mm
Outside Ring Width B	11 mm
Radius Rs min	0.6 mm



Basic Load Ratings

Cr - Dynamic Load Rating 19900 N

C0r - Static Load Rating 17500 N

Factors

Grease Limiting Speed 5400 rpm

Oil Reference Speed 7800 rpm

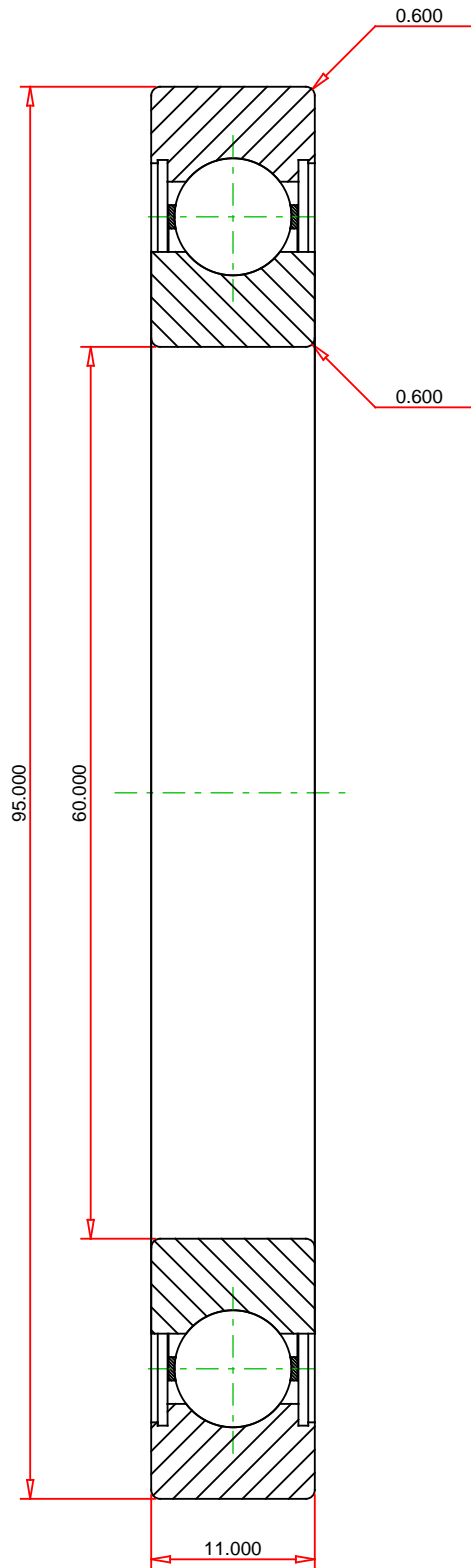

METRIC UNITS

Weight 0.22 kg

TIMKEN®

THE TIMKEN COMPANY
NORTH CANTON, OHIO USA

16012-C3
Narrow Section Ball Bearings (16000, 16100)

Dynamic Load Rating 19900 N
Static Load Rating 17500 N

Every reasonable effort has been made to ensure the accuracy of the information contained in this writing, but no liability is accepted for errors, omissions or for any other reason.

FOR DISCUSSION ONLY