

The Timken Company

4500 Mt Pleasant St. NW

N. Canton, OH 44720

Phone: (234) 262-3000

E-Mail: CustomerCAD@timken.com • **Web site:** www.timken.com
Part Number 6006-2RS-NR, Deep Groove Ball Bearings (6000, 6200, 6300, 6400)

Timken's deep groove ball bearings deliver reliable performance in a wide range of applications and conditions. With super-finished raceways and controlled geometries, our premium design helps ensure consistent quality.



[Specifications](#) | [Dimensions](#) | [Basic Load Ratings](#) | [Factors](#)

Specifications

Clearance	C0 (Normal)
Bore Size d	30 mm
Features	Contact Seals With Snap Ring
Bearing Type	Standard DGBB

Dimensions

Outside Diameter D	55 mm
Outside Ring Width B	13 mm
Radius Rs min	1 mm



Snap Ring Diameter D2 max	60.700 mm
----------------------------------	-----------

Snap Ring Width f max	1.120 mm
------------------------------	----------

Basic Load Ratings

Cr - Dynamic Load Rating	13200 N
---------------------------------	---------

C0r - Static Load Rating	8300 N
---------------------------------	--------

Factors

Grease Reference Speed	12000 rpm
-------------------------------	-----------

Oil Reference Speed	18000 rpm
----------------------------	-----------

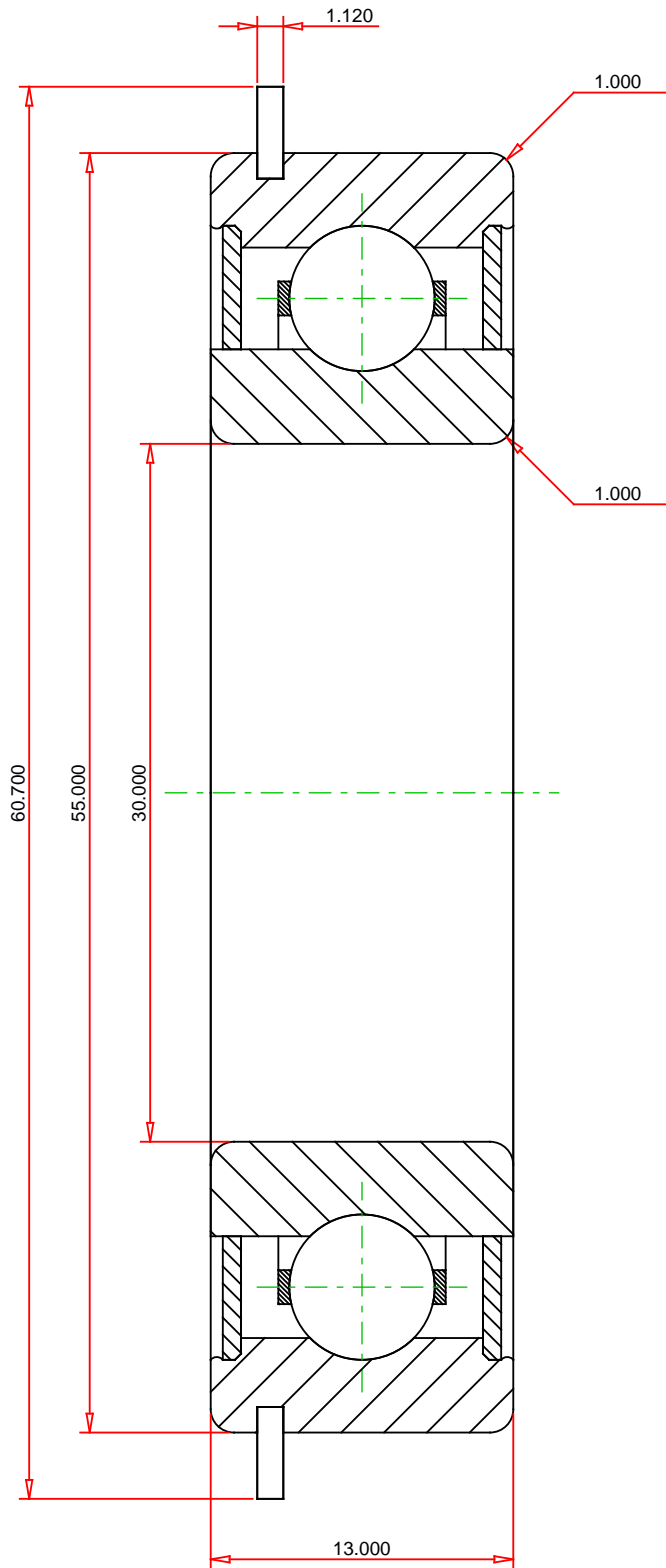

METRIC UNITS

Weight 0.11 kg

TIMKEN®

THE TIMKEN COMPANY
NORTH CANTON, OHIO USA

6006-2RS-NR
Deep Groove Ball Bearings (6000, 6200, 6300, 6400)

Dynamic Load Rating 13200 N
Static Load Rating 8300 N

Every reasonable effort has been made to ensure the accuracy of the information contained in this writing, but no liability is accepted for errors, omissions or for any other reason.

FOR DISCUSSION ONLY