

**The Timken Company**

4500 Mt Pleasant St. NW

N. Canton, OH 44720

**Phone:** (234) 262-3000

**E-Mail:** [CustomerCAD@timken.com](mailto:CustomerCAD@timken.com) • **Web site:** [www.timken.com](http://www.timken.com)
**Part Number 6201-2RS-NR, Deep Groove Ball Bearings (6000, 6200, 6300, 6400)**

Timken's deep groove ball bearings deliver reliable performance in a wide range of applications and conditions. With super-finished raceways and controlled geometries, our premium design helps ensure consistent quality.



[Specifications](#) | [Dimensions](#) | [Basic Load Ratings](#) | [Factors](#)

**Specifications**

<b>Clearance</b>	C0 (Normal)
<b>Bore Size d</b>	12 mm
<b>Features</b>	Contact Seals With Snap Ring
<b>Bearing Type</b>	Standard DGBB

**Dimensions**

<b>Outside Diameter D</b>	32 mm
<b>Outside Ring Width B</b>	10 mm
<b>Radius Rs min</b>	0.6 mm



<b>Snap Ring Diameter D2 max</b>	36.700 mm
----------------------------------	-----------

<b>Snap Ring Width f max</b>	1.120 mm
------------------------------	----------

## Basic Load Ratings

<b>Cr - Dynamic Load Rating</b>	6800 N
---------------------------------	--------

<b>C0r - Static Load Rating</b>	3000 N
---------------------------------	--------

## Factors

<b>Grease Reference Speed</b>	21000 rpm
-------------------------------	-----------

<b>Oil Reference Speed</b>	30000 rpm
----------------------------	-----------

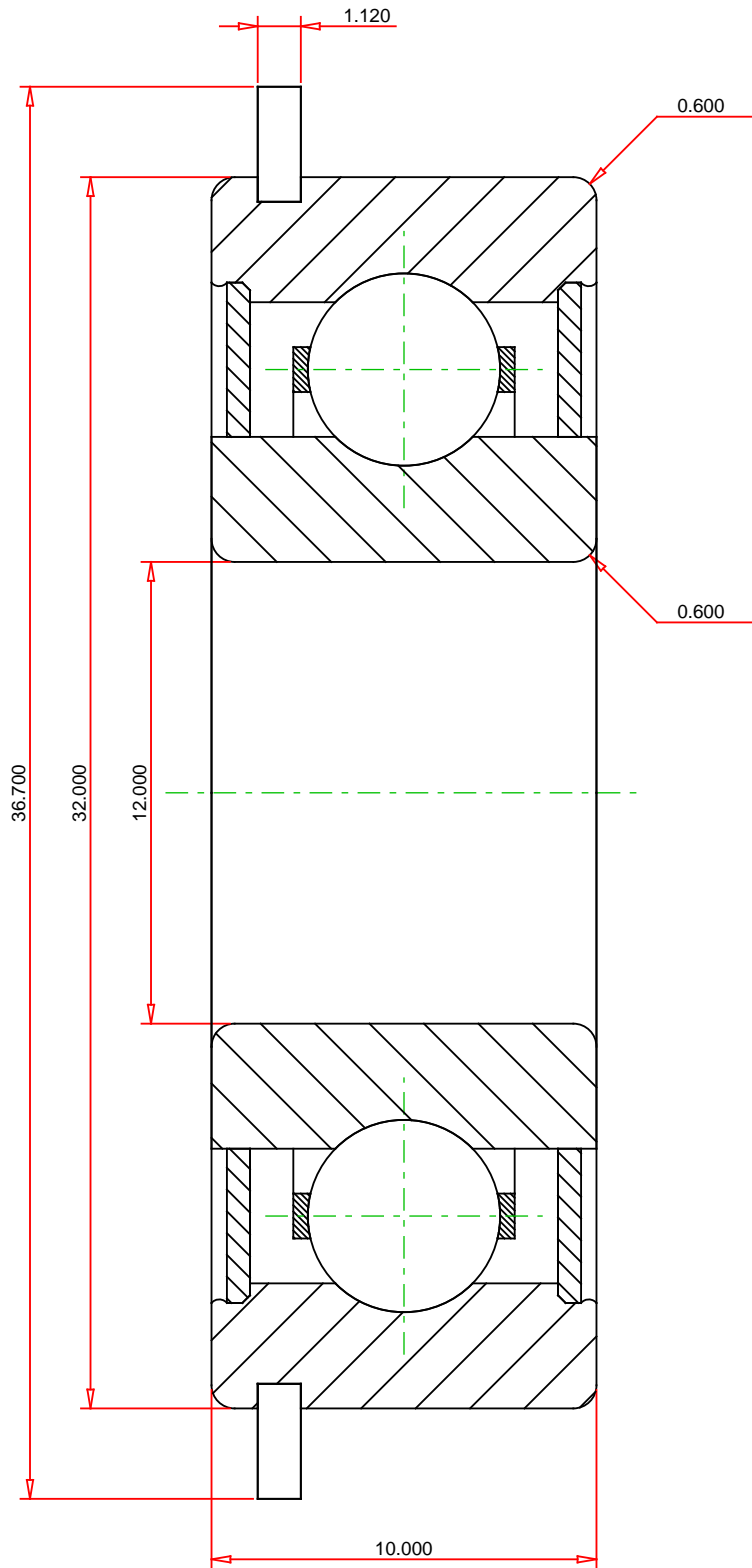

**METRIC UNITS**

Weight 0.04 kg

**TIMKEN**®

**THE TIMKEN COMPANY**  
NORTH CANTON, OHIO USA

**6201-2RS-NR**  
Deep Groove Ball Bearings (6000, 6200, 6300, 6400)

Dynamic Load Rating 6800 N  
Static Load Rating 3000 N

Every reasonable effort has been made to ensure the accuracy of the information contained in this writing, but no liability is accepted for errors, omissions or for any other reason.

**FOR DISCUSSION ONLY**