

**The Timken Company**

4500 Mt Pleasant St. NW

N. Canton, OH 44720

**Phone:** (234) 262-3000

**E-Mail:** [CustomerCAD@timken.com](mailto:CustomerCAD@timken.com) • **Web site:** [www.timken.com](http://www.timken.com)
**Part Number 6209-2RS-NR, Deep Groove Ball Bearings (6000, 6200, 6300, 6400)**

Timken's deep groove ball bearings deliver reliable performance in a wide range of applications and conditions. With super-finished raceways and controlled geometries, our premium design helps ensure consistent quality.



[Specifications](#) | [Dimensions](#) | [Basic Load Ratings](#) | [Factors](#)

**Specifications**

|                     |                              |
|---------------------|------------------------------|
| <b>Clearance</b>    | C0 (Normal)                  |
| <b>Bore Size d</b>  | 45 mm                        |
| <b>Features</b>     | Contact Seals With Snap Ring |
| <b>Bearing Type</b> | Standard DGBB                |

**Dimensions**

|                             |        |
|-----------------------------|--------|
| <b>Outside Diameter D</b>   | 85 mm  |
| <b>Outside Ring Width B</b> | 19 mm  |
| <b>Radius Rs min</b>        | 1.1 mm |



|                                  |           |
|----------------------------------|-----------|
| <b>Snap Ring Diameter D2 max</b> | 91.600 mm |
|----------------------------------|-----------|

|                              |          |
|------------------------------|----------|
| <b>Snap Ring Width f max</b> | 1.700 mm |
|------------------------------|----------|

## Basic Load Ratings

|                                 |         |
|---------------------------------|---------|
| <b>Cr - Dynamic Load Rating</b> | 31200 N |
|---------------------------------|---------|

|                                 |         |
|---------------------------------|---------|
| <b>C0r - Static Load Rating</b> | 20300 N |
|---------------------------------|---------|

## Factors

|                               |          |
|-------------------------------|----------|
| <b>Grease Reference Speed</b> | 8200 rpm |
|-------------------------------|----------|

|                            |           |
|----------------------------|-----------|
| <b>Oil Reference Speed</b> | 12000 rpm |
|----------------------------|-----------|

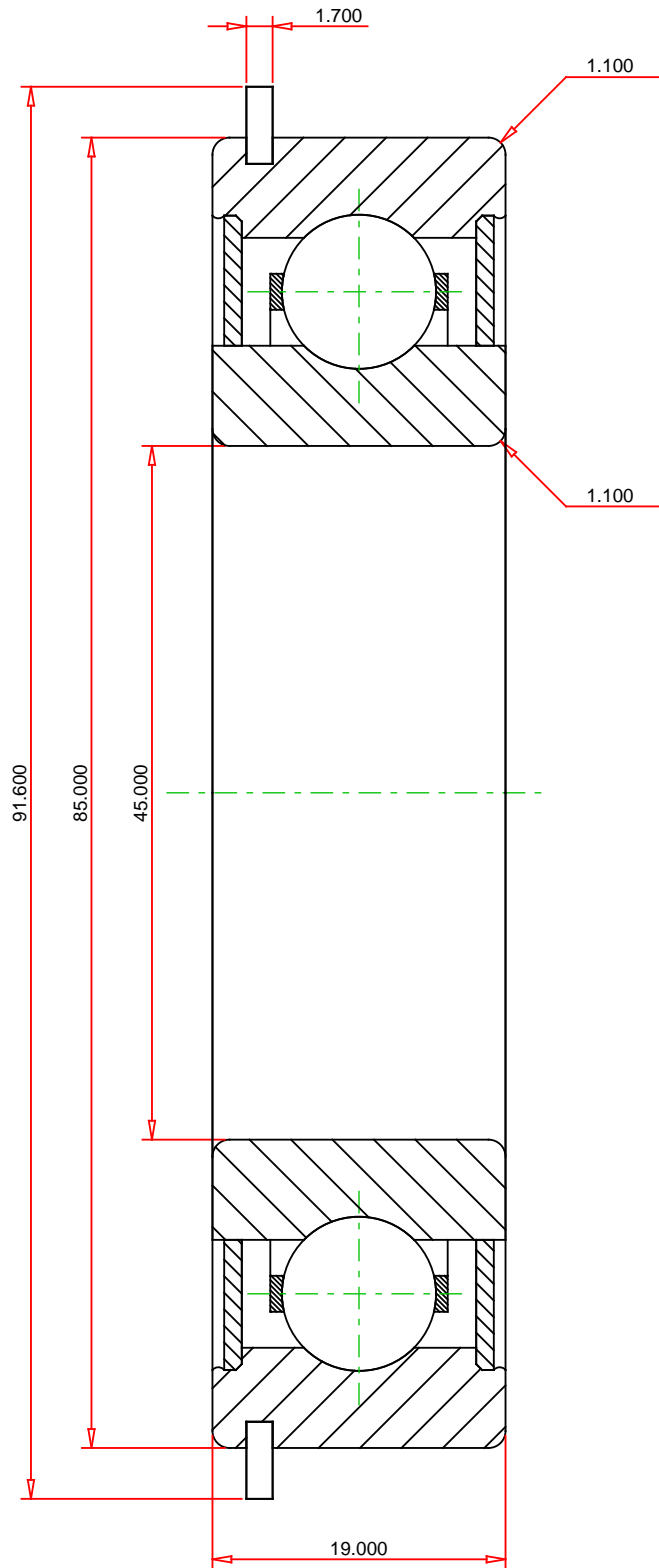

METRIC UNITS

Weight 0.42 kg

**TIMKEN**®

**6209-2RS-NR**  
 Deep Groove Ball Bearings (6000, 6200, 6300, 6400)

**THE TIMKEN COMPANY**  
 NORTH CANTON, OHIO USA

Dynamic Load Rating 31200 N  
 Static Load Rating 20300 N

Every reasonable effort has been made to ensure the accuracy of the information contained in this writing, but no liability is accepted for errors, omissions or for any other reason.

**FOR DISCUSSION ONLY**