

The Timken Company

4500 Mt Pleasant St. NW

N. Canton, OH 44720

Phone: (234) 262-3000

E-Mail: CustomerCAD@timken.com • **Web site:** www.timken.com
Part Number 23332EMBW800C4, Spherical Roller Bearings - Brass Cage

Spherical bearings are designed to manage high radial loads even when misalignment, poor lubrication, contamination, extreme speeds or critical application stresses are present.



[Specifications](#) | [Dimensions](#) | [Abutment and Fillet Dimensions](#) | [Basic Load Ratings](#) | [Factors](#)

Specifications

Design Unit	Metric
d - Bore	160 mm
Cage Type	EMB
Cage Material	Brass
Superseded Part	23332YMBW800C4

Dimensions

D - Outer Diameter	339.993 mm 13.3856 in
 - Inner Ring Width	136 mm 5.3543 in

B - Outer Ring Width	136 mm 5.3543 in
-----------------------------	---------------------

Abutment and Fillet Dimensions

R - Inner Ring "To Clear" Radius¹	3 mm 0.120 in
---	------------------

r - Outer Ring "To Clear" Radius²	3 mm 0.12 in
---	-----------------

da - Inner Ring Backing Diameter	202 mm 8.0000 in
---	---------------------

Da - Outer Ring Backing Diameter	297.000 mm 11.700 in
---	-------------------------

Basic Load Ratings

C0 - Static Radial Rating	2530000 N 568000 lbf
----------------------------------	-------------------------

C1(2) - Dynamic Radial Rating (Two-Rows)	2000000 N 449000 lbf
---	-------------------------

Factors

e - ISO Factor³	0.42
-----------------------------------	------

Y0 - ISO Factor⁴	1.58
------------------------------------	------

Y1 - ISO Factor⁵	1.62
------------------------------------	------

Y2 - ISO Factor⁶	2.41
------------------------------------	------

Reference Thermal Speed Rating (Grease)	900 rpm
--	---------

Reference Thermal Speed Rating (Oil)⁷	990 rpm
---	---------

Cg - Geometry Factor⁸	0.0914
---	--------

¹ Maximum housing fillet radius that bearing corners will clear.

² Maximum shaft fillet radius that bearing corners will clear.

³ These factors apply for both inch and metric calculations. Consult your Timken representative for instruction on use.

⁴ These factors apply for both inch and metric calculations. See engineering

⁵ These factors apply for both inch and metric calculations. Consult your Timken representative for instruction on use.

⁶ These factors apply for both inch and metric calculations. Consult your Timken representative for instruction on use.

⁷ See thermal speed ratings in the engineering section.

⁸ Geometry constant for Lubrication Life Adjustment Factor a3l.

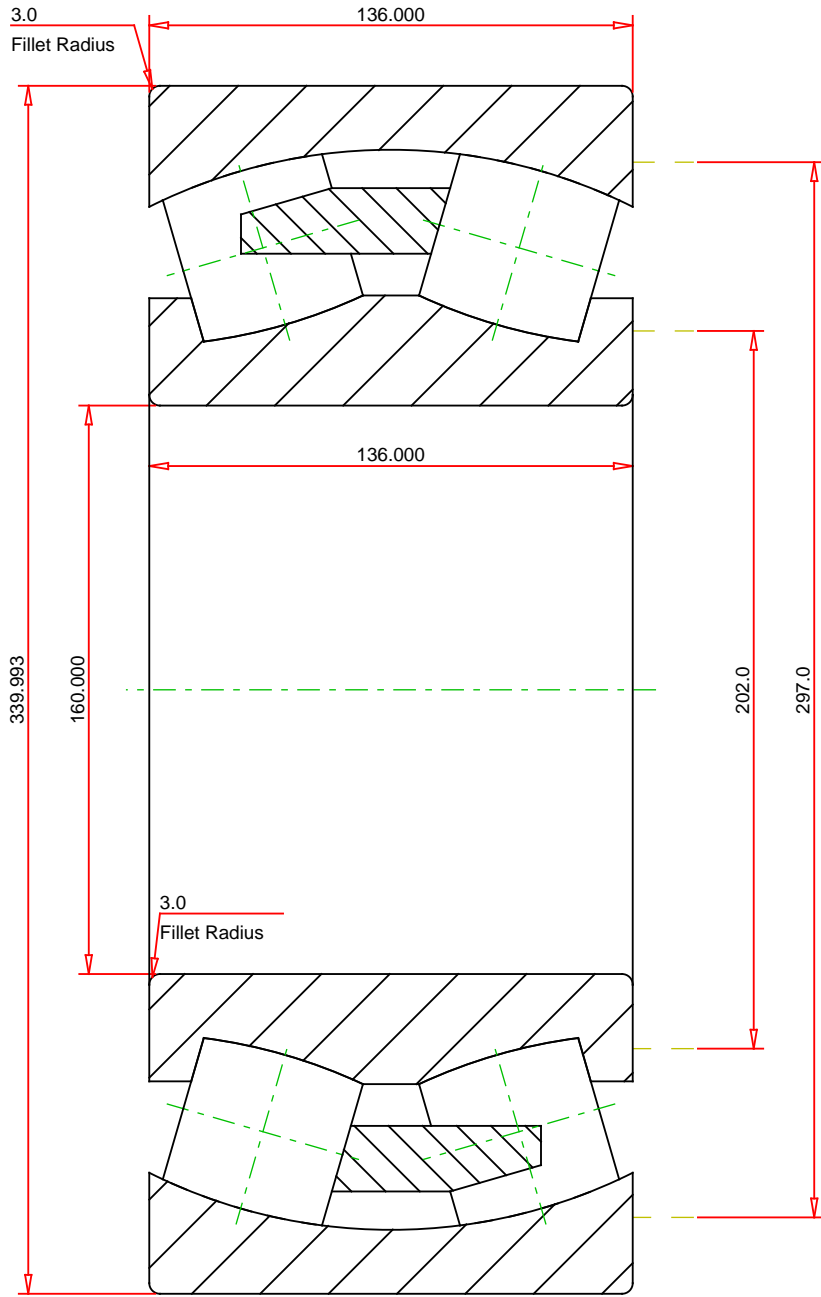

METRIC UNITS

Number of Rollers Per Row	16
ISO Factor e	0.42
ISO Factor Y0	1.58
ISO Factor Y1	1.62
ISO Factor Y2	2.41
Bearing Weight	61.2 kg
Cage Type	EMB
Cage Material	Brass



23332EMBW800C4
SRB ASSEMBLY

THE TIMKEN COMPANY
NORTH CANTON, OHIO USA

Dynamic Radial Rating (Two Rows)	200000	N
Static Radial Rating	253000	N

Every reasonable effort has been made to ensure the accuracy of the information contained in this writing, but no liability is accepted for errors, omissions or for any other reason.

FOR DISCUSSION ONLY