



The Timken Company

4500 Mt Pleasant St. NW

N. Canton, OH 44720

Phone: (234) 262-3000

E-Mail: CustomerCAD@timken.com • **Web site:** www.timken.com

Part Number 24156EMBW33W45AC3, Spherical Roller Bearings - Brass Cage

Spherical bearings are designed to manage high radial loads even when misalignment, poor lubrication, contamination, extreme speeds or critical application stresses are present.



[Specifications](#) | [Dimensions](#) | [Abutment and Fillet Dimensions](#) | [Basic Load Ratings](#) | [Factors](#)

Specifications

Design Unit	Metric
d - Bore	280 mm
Cage Type	EMB
Cage Material	Brass
Superseded Part	24156YMBW33W45AC3

Dimensions

D - Outer Diameter	460 mm 18.1100 in
B - Inner Ring Width	180 mm 7.087 in



B - Outer Ring Width	180 mm 7.087 in
-----------------------------	--------------------

Abutment and Fillet Dimensions

R - Inner Ring "To Clear" Radius¹	4 mm 0.160 in
---	------------------

r - Outer Ring "To Clear" Radius²	4 mm 0.16 in
---	-----------------

da - Inner Ring Backing Diameter	316.000 mm 12.5000 in
---	--------------------------

Da - Outer Ring Backing Diameter	419 mm 16.5000 in
---	----------------------

Basic Load Ratings

C0 - Static Radial Rating	5060000 N 1140000 lbf
----------------------------------	--------------------------

C1(2) - Dynamic Radial Rating (Two-Rows)	3210000 N 723000 lbf
---	-------------------------

Factors

e - ISO Factor³	0.36
-----------------------------------	------

Y0 - ISO Factor⁴	1.82
------------------------------------	------

Y1 - ISO Factor⁵	1.86
------------------------------------	------

Y2 - ISO Factor⁶	2.77
------------------------------------	------

Reference Thermal Speed Rating (Grease)	510 rpm
--	---------

Reference Thermal Speed Rating (Oil)⁷	540 rpm
---	---------

Cg - Geometry Factor⁸	0.1207
---	--------

¹ Maximum housing fillet radius that bearing corners will clear.

² Maximum shaft fillet radius that bearing corners will clear.

³ These factors apply for both inch and metric calculations. Consult your Timken representative for instruction on use.

⁴ These factors apply for both inch and metric calculations. See engineering

⁵ These factors apply for both inch and metric calculations. Consult your Timken representative for instruction on use.

⁶ These factors apply for both inch and metric calculations. Consult your Timken representative for instruction on use.

⁷ See thermal speed ratings in the engineering section.

⁸ Geometry constant for Lubrication Life Adjustment Factor a3l.

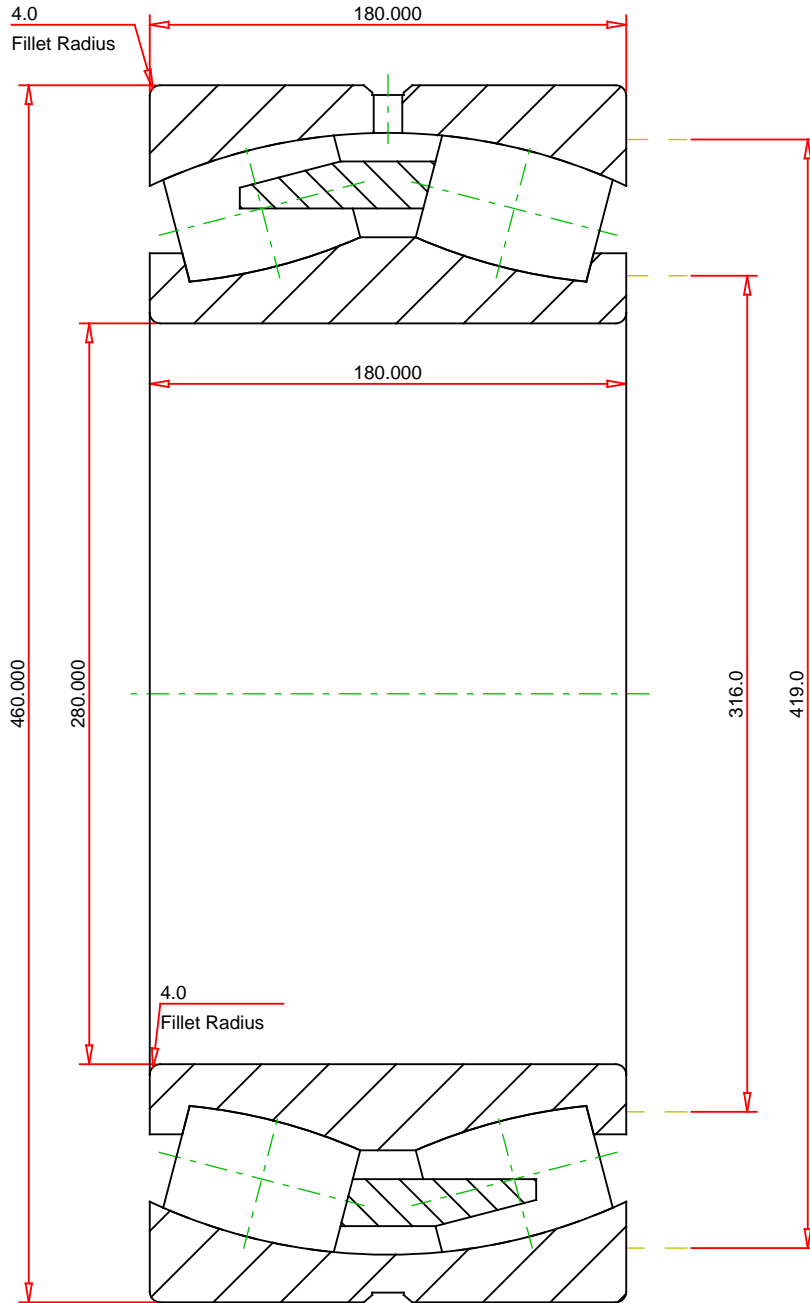

METRIC UNITS

Number of Rollers Per Row	22
ISO Factor e	0.36
ISO Factor Y0	1.82
ISO Factor Y1	1.86
ISO Factor Y2	2.77
Bearing Weight	118.0 kg
Cage Type	EMB
Cage Material	Brass

TIMKEN®

THE TIMKEN COMPANY
NORTH CANTON, OHIO USA

24156EMBW33W45AC3
SRB ASSEMBLY

Dynamic Radial Rating (Two Rows)	3210000	N
Static Radial Rating	5060000	N

Every reasonable effort has been made to ensure the accuracy of the information contained in this writing, but no liability is accepted for errors, omissions or for any other reason.

FOR DISCUSSION ONLY