

The Timken Company

4500 Mt Pleasant St. NW

N. Canton, OH 44720

Phone: (234) 262-3000

E-Mail: CustomerCAD@timken.com • **Web site:** www.timken.com
Part Number 23040EMW33C2, Spherical Roller Bearings - Brass Cage

Spherical bearings are designed to manage high radial loads even when misalignment, poor lubrication, contamination, extreme speeds or critical application stresses are present.



[Specifications](#) | [Dimensions](#) | [Abutment and Fillet Dimensions](#) | [Basic Load Ratings](#) | [Factors](#)

Specifications

Design Unit	Metric
d - Bore	200 mm
Cage Type	EM
Cage Material	Brass
Superseded Part	23040YMW33C2

Dimensions

D - Outer Diameter	310 mm 12.2047 in
 d' - Inner Ring Width	82 mm 3.2283 in

B - Outer Ring Width	82 mm 3.2283 in
-----------------------------	--------------------

Abutment and Fillet Dimensions

R - Inner Ring "To Clear" Radius¹	2 mm 0.080 in
---	------------------

r - Outer Ring "To Clear" Radius²	2 mm 0.080 in
---	------------------

da - Inner Ring Backing Diameter	225.000 mm 8.900 in
---	------------------------

Da - Outer Ring Backing Diameter	289.000 mm 11.4000 in
---	--------------------------

Basic Load Ratings

C0 - Static Radial Rating	1760000 N 395000 lbf
----------------------------------	-------------------------

C1(2) - Dynamic Radial Rating (Two-Rows)	1230000 N 276000 lbf
---	-------------------------

Factors

e - ISO Factor³	0.23
-----------------------------------	------

Y0 - ISO Factor⁴	2.89
------------------------------------	------

Y1 - ISO Factor⁵	2.95
------------------------------------	------

Y2 - ISO Factor⁶	4.4
------------------------------------	-----

Reference Thermal Speed Rating (Grease)	1500 rpm
--	----------

Reference Thermal Speed Rating (Oil)⁷	1800 rpm
---	----------

Cg - Geometry Factor⁸	0.0921
---	--------

¹ Maximum housing fillet radius that bearing corners will clear.

² Maximum shaft fillet radius that bearing corners will clear.

³ These factors apply for both inch and metric calculations. Consult your Timken representative for instruction on use.

⁴ These factors apply for both inch and metric calculations. See engineering

⁵ These factors apply for both inch and metric calculations. Consult your Timken representative for instruction on use.

⁶ These factors apply for both inch and metric calculations. Consult your Timken representative for instruction on use.

⁷ See thermal speed ratings in the engineering section.

⁸ Geometry constant for Lubrication Life Adjustment Factor a3l.

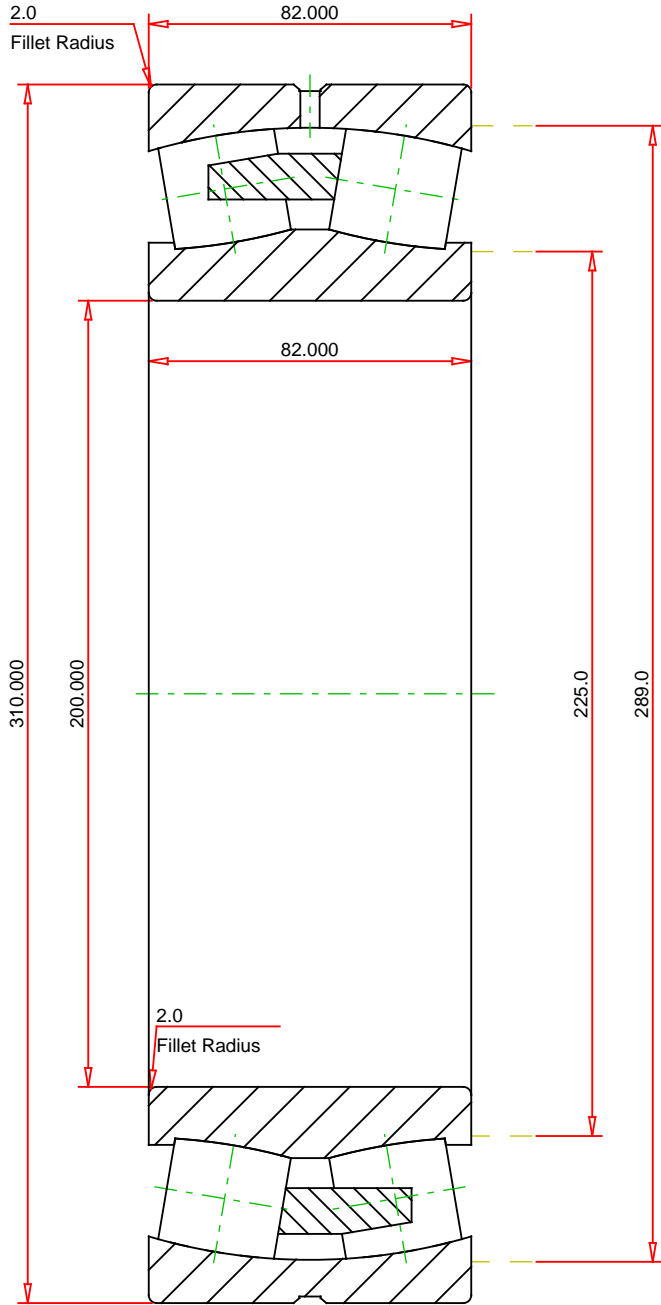

METRIC UNITS

Number of Rollers Per Row	24
ISO Factor e	0.23
ISO Factor Y0	2.89
ISO Factor Y1	2.95
ISO Factor Y2	4.40
Bearing Weight	21.9 kg
Cage Type	EM
Cage Material	Brass

TIMKEN®

23040EMW33C2
SRB ASSEMBLY

THE TIMKEN COMPANY
NORTH CANTON, OHIO USA

Dynamic Radial Rating (Two Rows)	1230000	N
Static Radial Rating	1760000	N

Every reasonable effort has been made to ensure the accuracy of the information contained in this writing, but no liability is accepted for errors, omissions or for any other reason.

FOR DISCUSSION ONLY