

The Timken Company

4500 Mt Pleasant St. NW

N. Canton, OH 44720

Phone: (234) 262-3000

E-Mail: CustomerCAD@timken.com • **Web site:** www.timken.com
Part Number 22336EMBW33C2, Spherical Roller Bearings - Brass Cage

Spherical bearings are designed to manage high radial loads even when misalignment, poor lubrication, contamination, extreme speeds or critical application stresses are present.



[Specifications](#) | [Dimensions](#) | [Abutment and Fillet Dimensions](#) | [Basic Load Ratings](#) | [Factors](#)

Specifications

Design Unit	Metric
d - Bore	180 mm
Cage Type	EMB
Cage Material	Brass
Superseded Part	22336YMBW33C2

Dimensions

D - Outer Diameter	380.000 mm 14.9606 in
 - Inner Ring Width	126 mm 4.9606 in

B - Outer Ring Width	126 mm 4.9606 in
-----------------------------	---------------------

Abutment and Fillet Dimensions

R - Inner Ring "To Clear" Radius¹	3 mm 0.120 in
---	------------------

r - Outer Ring "To Clear" Radius²	3 mm 0.12 in
---	-----------------

da - Inner Ring Backing Diameter	232 mm 9.2000 in
---	---------------------

Da - Outer Ring Backing Diameter	343 mm 13.5000 in
---	----------------------

Basic Load Ratings

C0 - Static Radial Rating	2600000 N 584000 lbf
----------------------------------	-------------------------

C1(2) - Dynamic Radial Rating (Two-Rows)	2190000 N 491000 lbf
---	-------------------------

Factors

e - ISO Factor³	0.32
-----------------------------------	------

Y0 - ISO Factor⁴	2.08
------------------------------------	------

Y1 - ISO Factor⁵	2.13
------------------------------------	------

Y2 - ISO Factor⁶	3.17
------------------------------------	------

Reference Thermal Speed Rating (Grease)	1200 rpm
--	----------

Reference Thermal Speed Rating (Oil)⁷	1300 rpm
---	----------

C_g - Geometry Factor⁸	0.0988
--	--------

¹ Maximum housing fillet radius that bearing corners will clear.

² Maximum shaft fillet radius that bearing corners will clear.

³ These factors apply for both inch and metric calculations. Consult your Timken representative for instruction on use.

⁴ These factors apply for both inch and metric calculations. See engineering

⁵ These factors apply for both inch and metric calculations. Consult your Timken representative for instruction on use.

⁶ These factors apply for both inch and metric calculations. Consult your Timken representative for instruction on use.

⁷ See thermal speed ratings in the engineering section.

⁸ Geometry constant for Lubrication Life Adjustment Factor a_{3l}.

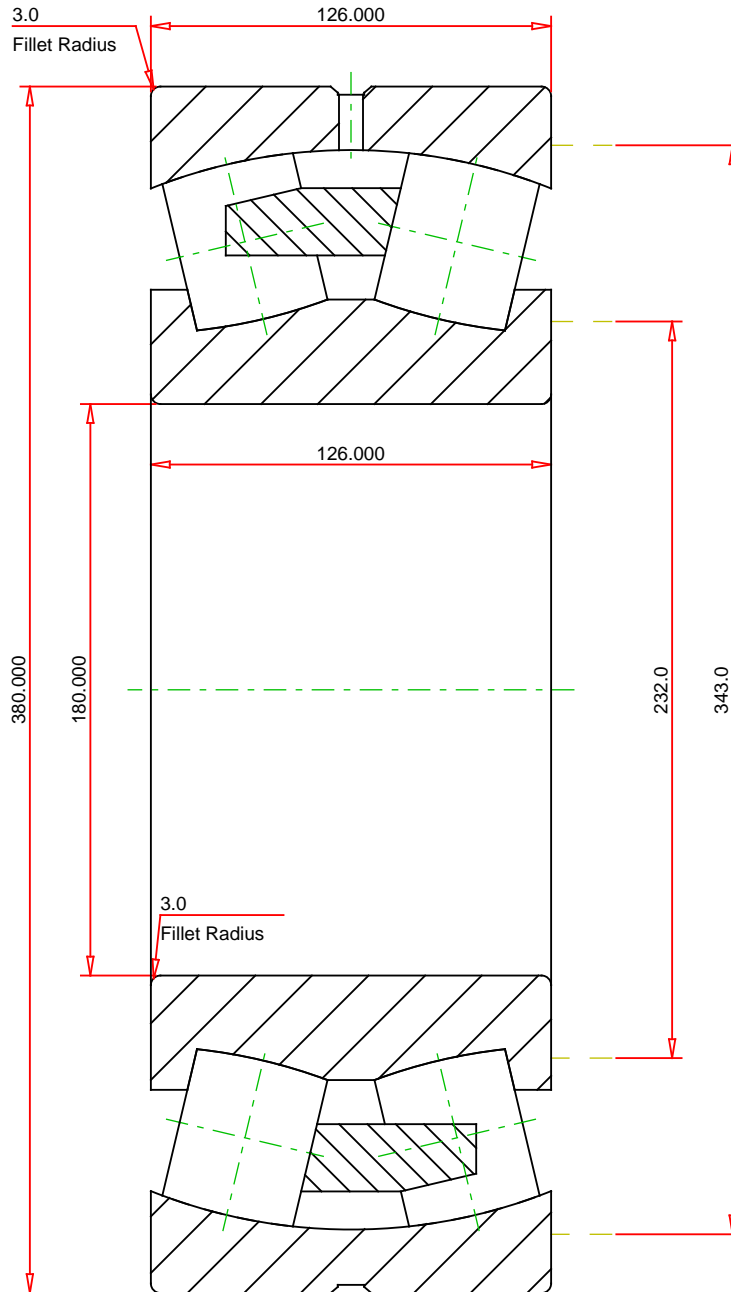

METRIC UNITS

Number of Rollers Per Row	15
ISO Factor e	0.32
ISO Factor Y0	2.08
ISO Factor Y1	2.13
ISO Factor Y2	3.17
Bearing Weight	69.0 kg
Cage Type	EMB
Cage Material	Brass

TIMKEN®

THE TIMKEN COMPANY
NORTH CANTON, OHIO USA

22336EMBW33C2 SRB ASSEMBLY		
Dynamic Radial Rating (Two Rows)	2190000	N
Static Radial Rating	2600000	N

Every reasonable effort has been made to ensure the accuracy of the information contained in this writing, but no liability is accepted for errors, omissions or for any other reason.

FOR DISCUSSION ONLY