

The Timken Company

4500 Mt Pleasant St. NW

N. Canton, OH 44720

Phone: (234) 262-3000

E-Mail: CustomerCAD@timken.com • **Web site:** www.timken.com
Part Number 23340EMBW33W45AW800, Spherical Roller Bearings - Brass Cage

Spherical bearings are designed to manage high radial loads even when misalignment, poor lubrication, contamination, extreme speeds or critical application stresses are present.



[Specifications](#) | [Dimensions](#) | [Abutment and Fillet Dimensions](#) | [Basic Load Ratings](#) | [Factors](#)

Specifications

Design Unit	Metric
d - Bore	200 mm
Cage Type	EMB
Cage Material	Brass
Superseded Part	23340YMBW33W45AW800

Dimensions

D - Outer Diameter	419.993 mm 16.5352 in
 - Inner Ring Width	165 mm 6.4960 in

B - Outer Ring Width	165 mm 6.4960 in
-----------------------------	---------------------

Abutment and Fillet Dimensions

R - Inner Ring "To Clear" Radius¹	4 mm 0.160 in
---	------------------

r - Outer Ring "To Clear" Radius²	4 mm 0.16 in
---	-----------------

da - Inner Ring Backing Diameter	246.000 mm 9.700 in
---	------------------------

Da - Outer Ring Backing Diameter	366.000 mm 14.4000 in
---	--------------------------

Basic Load Ratings

C0 - Static Radial Rating	3730000 N 838000 lbf
----------------------------------	-------------------------

C1(2) - Dynamic Radial Rating (Two-Rows)	2940000 N 660000 lbf
---	-------------------------

Factors

e - ISO Factor³	0.41
-----------------------------------	------

Y0 - ISO Factor⁴	1.62
------------------------------------	------

Y1 - ISO Factor⁵	1.66
------------------------------------	------

Y2 - ISO Factor⁶	2.47
------------------------------------	------

Reference Thermal Speed Rating (Grease)	670 rpm
--	---------

Reference Thermal Speed Rating (Oil)⁷	720 rpm
---	---------

Cg - Geometry Factor⁸	0.1043
---	--------

¹ Maximum housing fillet radius that bearing corners will clear.

² Maximum shaft fillet radius that bearing corners will clear.

³ These factors apply for both inch and metric calculations. Consult your Timken representative for instruction on use.

⁴ These factors apply for both inch and metric calculations. See engineering

⁵ These factors apply for both inch and metric calculations. Consult your Timken representative for instruction on use.

⁶ These factors apply for both inch and metric calculations. Consult your Timken representative for instruction on use.

⁷ See thermal speed ratings in the engineering section.

⁸ Geometry constant for Lubrication Life Adjustment Factor a3l.

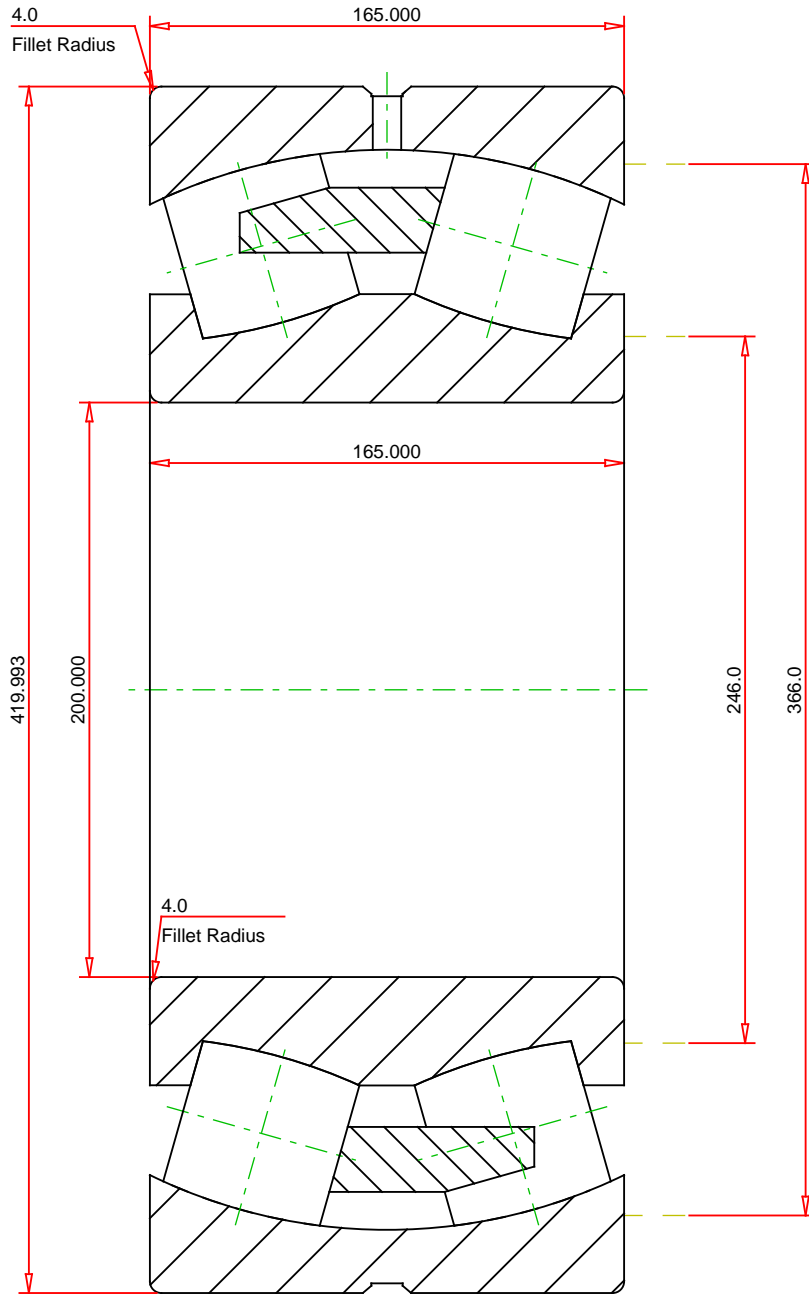

METRIC UNITS

Number of Rollers Per Row	16
ISO Factor e	0.41
ISO Factor Y0	1.62
ISO Factor Y1	1.66
ISO Factor Y2	2.47
Bearing Weight	112.6 kg
Cage Type	EMB
Cage Material	Brass

TIMKEN®

23340EMBW33W45AW800
SRB ASSEMBLY

THE TIMKEN COMPANY
NORTH CANTON, OHIO USA

Dynamic Radial Rating (Two Rows)	2940000	N
Static Radial Rating	3730000	N

Every reasonable effort has been made to ensure the accuracy of the information contained in this writing, but no liability is accepted for errors, omissions or for any other reason.

FOR DISCUSSION ONLY