



The Timken Company

4500 Mt Pleasant St. NW

N. Canton, OH 44720

Phone: (234) 262-3000

E-Mail: CustomerCAD@timken.com • **Web site:** www.timken.com

Part Number 29438EJ, Thrust Spherical Roller Bearings-Type TSR

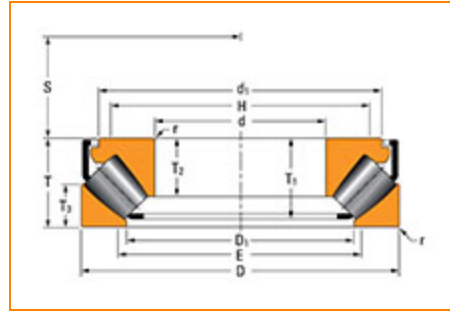
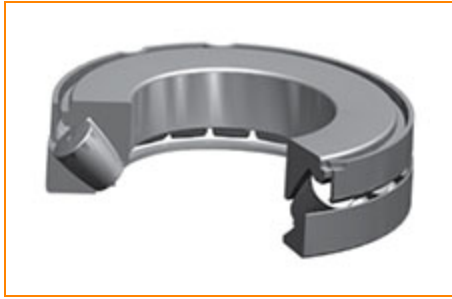

[Specifications](#) | [Dimensions](#) | [Basic Load Ratings](#)

Specifications

d - Bore	190 mm
Bearing Type	Thrust Spherical Roller Bearings - TSR
UPC Code	87796018648

Dimensions

D - Outside Diameter	380.000 mm 14.9610 in
d1 - Cone Outside Diameter	332.9 mm 13.106 in
D1 - Cup Bore	264.5 mm 10.413 in
E - Shoulder Diameter - Housing (Max)	281 mm 11.063 in
D - Shoulder Diameter - Shaft (Min)	303 mm 11.929 in



r - Fillet Radius	4 mm 0.16 in
S - Dimension	117 mm 4.606 in
T - Total Width	115 mm 4.528 in
T1 - Cage Position	100.3 mm 3.95 in
T3 - Cup Width	55.5 mm 2.185 in
T4 - Cone Width	73 mm 2.874 in

Basic Load Ratings

Static Load Rating	7910000 N 1780000 lbf
Dynamic Load Rating	3040000 N 683000 lbf
Thermal Speed Rating	930 rpm

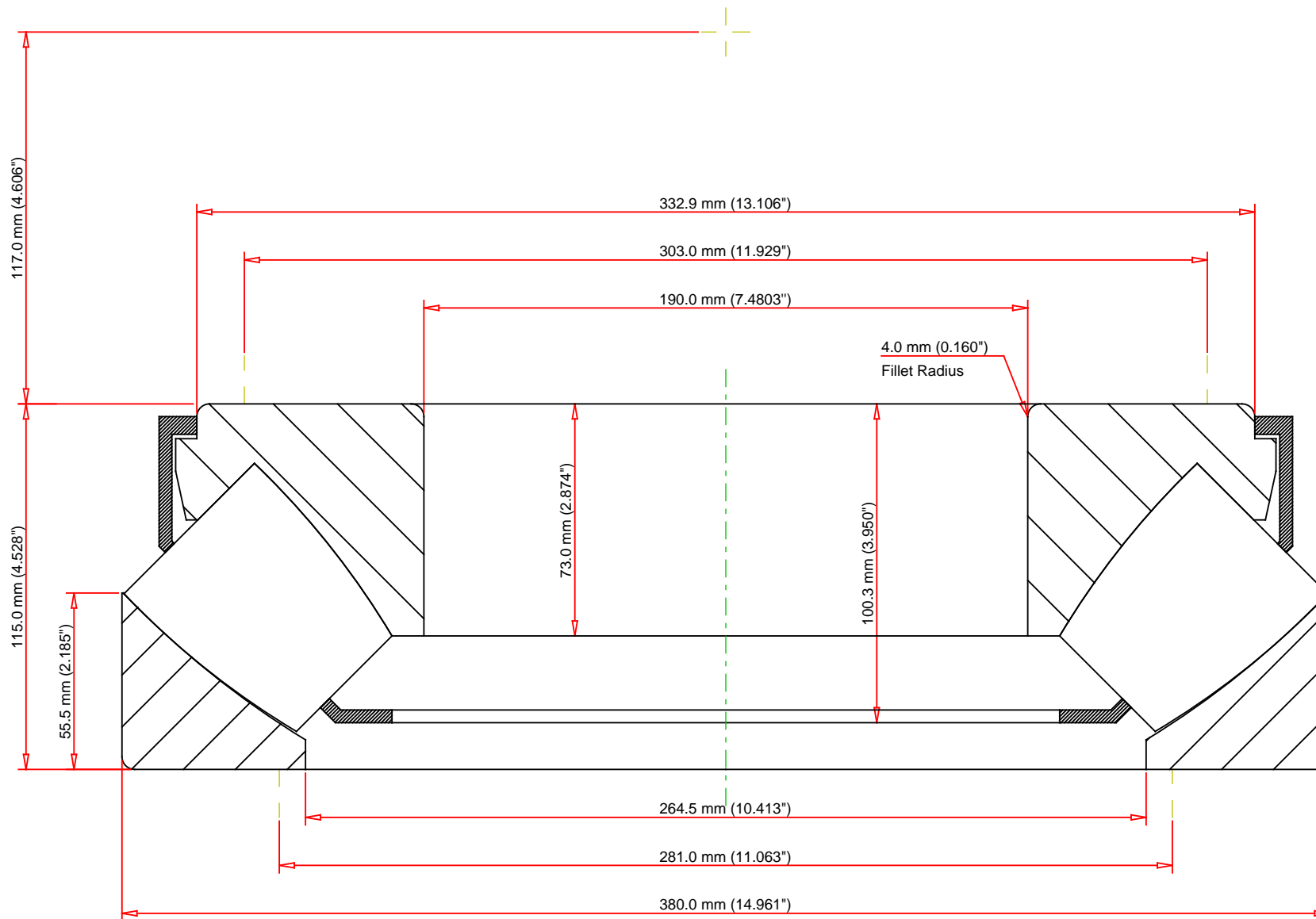

METRIC UNITS

Static Load Rating - C_{0a}	1780000	lbf	7910000	N
Dynamic Load Rating - C_a	683000	lbf	3040000	N
Weight	122.9	lb	55.7	kg

TIMKEN

THE TIMKEN COMPANY
NORTH CANTON, OHIO USA

29438EJ

Thrust Spherical Roller
Bearings-Type TSR

Every reasonable effort has been made to ensure the accuracy of the information contained in this writing, but no liability is accepted for errors, omissions or for any other reason.

FOR DISCUSSION ONLY