



The Timken Company

4500 Mt Pleasant St. NW

N. Canton, OH 44720

Phone: (234) 262-3000

E-Mail: CustomerCAD@timken.com • **Web site:** www.timken.com

Part Number 22326KEJW33C3, Spherical Roller Bearings - Steel Cage

Spherical bearings are designed to manage high radial loads even when misalignment, poor lubrication, contamination, extreme speeds or critical application stresses are present.



[Specifications](#) | [Factors](#) | [Dimensions](#) | [Abutment and Fillet Dimensions](#) | [Basic Load Ratings](#)

Specifications

UPC Code 087796027442

Design Unit Metric

d - Bore 130 mm

Lubrication Type Standard Grease

Bore_Taper 1/12

Cage Type EJ

Cage Material Steel

Superseded Part 22326KYMW22



e - ISO Factor¹	0.32
Y0 - ISO Factor²	2.06
Y1 - ISO Factor³	2.11
Y2 - ISO Factor⁴	3.14
Reference Thermal Speed Rating (Grease)	1800 rpm
Reference Thermal Speed Rating (Oil)⁵	2000 rpm
Cg - Geometry Factor⁶	0.0874

Dimensions

D - Outer Diameter	279.993 mm 11.0233 in
B' - Inner Ring Width	93 mm 3.6614 in
B - Outer Ring Width	93 mm 3.6614 in

Abutment and Fillet Dimensions

R - Inner Ring "To Clear" Radius⁷	3 mm 0.120 in
r - Outer Ring "To Clear" Radius⁸	3 mm 0.12 in
da - Inner Ring Backing Diameter	169.000 mm 6.7000 in
Da - Outer Ring Backing Diameter	252 mm 9.9000 in

Basic Load Ratings

C0 - Static Radial Rating	1410000 N 318000 lbf
----------------------------------	-------------------------

C1(2) - Dynamic Radial Rating (Two-Rows)	1250000 N 281000 lbf
---	-------------------------

¹ These factors apply for both inch and metric calculations. Consult your Timken representative for instruction on use.

² These factors apply for both inch and metric calculations. See engineering

³ These factors apply for both inch and metric calculations. Consult your Timken representative for instruction on use.

⁴ These factors apply for both inch and metric calculations. Consult your Timken representative for instruction on use.

⁵ See thermal speed ratings in the engineering section.

⁶ Geometry constant for Lubrication Life Adjustment Factor a3l.

⁷ Maximum housing fillet radius that bearing corners will clear.

⁸ These maximum fillet radii will be cleared by the bearing corners.

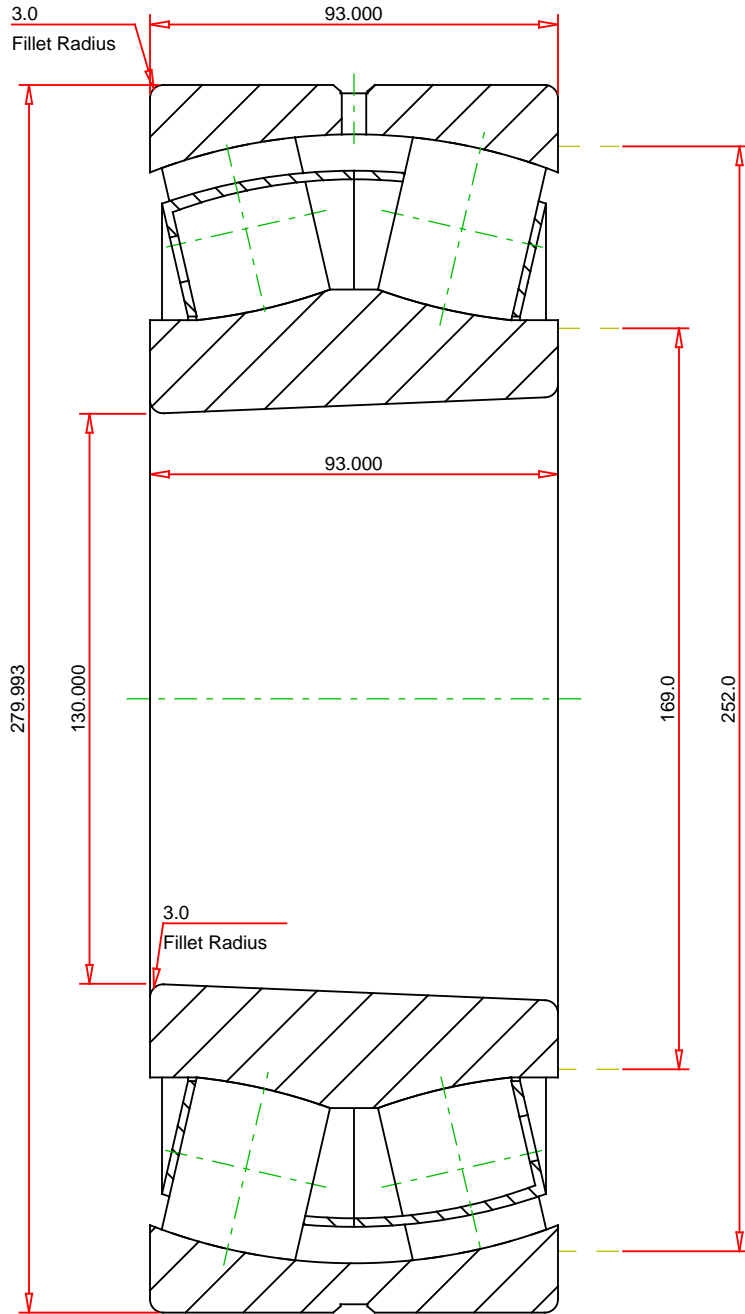

METRIC UNITS

Number of Rollers Per Row	15
ISO Factor e	0.32
ISO Factor Y0	2.06
ISO Factor Y1	2.11
ISO Factor Y2	3.14
Bearing Weight	kg
Cage Type	EJ
Cage Material	Steel
Bore Taper	1/12

TIMKEN®

THE TIMKEN COMPANY
NORTH CANTON, OHIO USA

22326KEJW33C3
SRB ASSEMBLY

Dynamic Radial Rating (Two Rows)	1250000	N
Static Radial Rating	1410000	N

Every reasonable effort has been made to ensure the accuracy of the information contained in this writing, but no liability is accepted for errors, omissions or for any other reason.

FOR DISCUSSION ONLY