

The Timken Company

4500 Mt Pleasant St. NW

N. Canton, OH 44720

Phone: (234) 262-3000

E-Mail: CustomerCAD@timken.com • **Web site:** www.timken.com
Part Number 26348EMBW33W45AC3, Spherical Roller Bearings - Brass Cage

Spherical bearings are designed to manage high radial loads even when misalignment, poor lubrication, contamination, extreme speeds or critical application stresses are present.



[Specifications](#) | [Dimensions](#) | [Abutment and Fillet Dimensions](#) | [Basic Load Ratings](#) | [Factors](#)

Specifications

Design Unit	Metric
d - Bore	240 mm
Cage Type	EMB
Cage Material	Brass
Superseded Part	26348YMBW33W45AC3

Dimensions

D - Outer Diameter	460 mm 18.1100 in
 d - Inner Ring Width	147 mm 5.787 in

B - Outer Ring Width	147 mm 5.7870 in
-----------------------------	---------------------

Abutment and Fillet Dimensions

R - Inner Ring "To Clear" Radius¹	4 mm 0.160 in
-----------------------------------------------------	------------------

r - Outer Ring "To Clear" Radius²	4 mm 0.16 in
-----------------------------------------------------	-----------------

da - Inner Ring Backing Diameter	286 mm 11.270 in
-----------------------------------------	---------------------

Da - Outer Ring Backing Diameter	410.000 mm 16.150 in
-----------------------------------------	-------------------------

Basic Load Ratings

C0 - Static Radial Rating	3690000 N 829000 lbf
----------------------------------	-------------------------

C1(2) - Dynamic Radial Rating (Two-Rows)	2910000 N 653000 lbf
-------------------------------------------------	-------------------------

Factors

e - ISO Factor³	0.32
-----------------------------------	------

Y0 - ISO Factor⁴	2.04
------------------------------------	------

Y1 - ISO Factor⁵	2.08
------------------------------------	------

Y2 - ISO Factor⁶	3.1
------------------------------------	-----

Reference Thermal Speed Rating (Grease)	580 rpm
------------------------------------------------	---------

Reference Thermal Speed Rating (Oil)⁷	690 rpm
---------------------------------------------------------	---------

Cg - Geometry Factor⁸	0.1133
-----------------------------------------	--------

¹ Maximum housing fillet radius that bearing corners will clear.

² Maximum shaft fillet radius that bearing corners will clear.

³ These factors apply for both inch and metric calculations. Consult your Timken representative for instruction on use.

⁴ These factors apply for both inch and metric calculations. See engineering

⁵ These factors apply for both inch and metric calculations. Consult your Timken representative for instruction on use.

⁶ These factors apply for both inch and metric calculations. Consult your Timken representative for instruction on use.

⁷ See thermal speed ratings in the engineering section.

⁸ Geometry constant for Lubrication Life Adjustment Factor a3l.

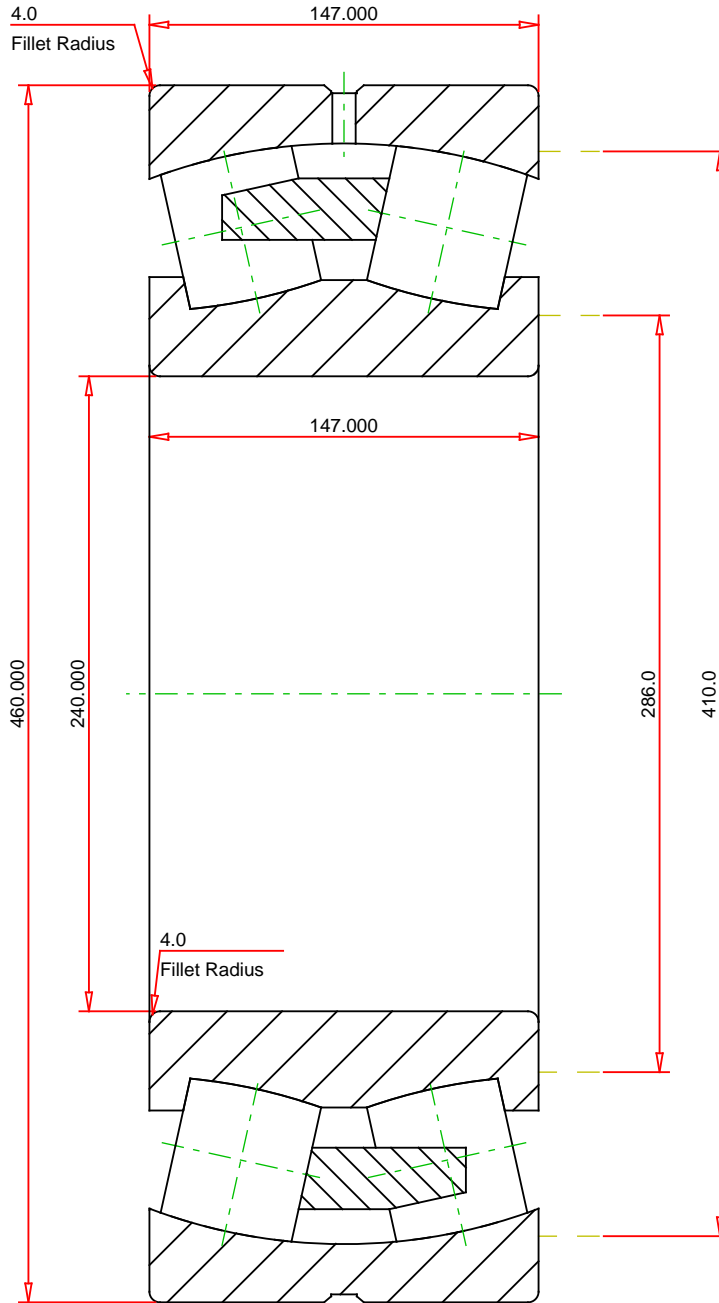

METRIC UNITS

Number of Rollers Per Row	17
ISO Factor e	0.32
ISO Factor Y0	2.04
ISO Factor Y1	2.08
ISO Factor Y2	3.10
Bearing Weight	113.0 kg
Cage Type	EMB
Cage Material	Brass

TIMKEN®

26348EMBW33W45AC3
SRB ASSEMBLY

THE TIMKEN COMPANY
NORTH CANTON, OHIO USA

Dynamic Radial Rating (Two Rows)	2910000	N
Static Radial Rating	3690000	N

Every reasonable effort has been made to ensure the accuracy of the information contained in this writing, but no liability is accepted for errors, omissions or for any other reason.

FOR DISCUSSION ONLY