

**The Timken Company**

4500 Mt Pleasant St. NW

N. Canton, OH 44720

**Phone:** (234) 262-3000

**E-Mail:** [CustomerCAD@timken.com](mailto:CustomerCAD@timken.com) • **Web site:** [www.timken.com](http://www.timken.com)
**Part Number 22344EJW33W45AC6, Spherical Roller Bearings - Steel Cage**

Spherical bearings are designed to manage high radial loads even when misalignment, poor lubrication, contamination, extreme speeds or critical application stresses are present.



[Specifications](#) | [Factors](#) | [Dimensions](#) | [Abutment and Fillet Dimensions](#) | [Basic Load Ratings](#)

**Specifications**

|                         |                  |
|-------------------------|------------------|
| <b>UPC Code</b>         | 087796166349     |
| <b>Design Unit</b>      | Metric           |
| <b>d - Bore</b>         | 220 mm           |
| <b>Lubrication Type</b> | Standard Grease  |
| <b>Cage Type</b>        | EJ               |
| <b>Cage Material</b>    | Steel            |
| <b>Superseded Part</b>  | 22344CJW33W45AC6 |

**Factors**

e - ISO Factor<sup>1</sup> 0.32

|   |          |
|---|----------|
| <b>Y0 - ISO Factor<sup>2</sup></b>                      | 2.04     |
| <b>Y1 - ISO Factor<sup>3</sup></b>                      | 2.08     |
| <b>Y2 - ISO Factor<sup>4</sup></b>                      | 3.1      |
| <b>Reference Thermal Speed Rating (Grease)</b>          | 940 rpm  |
| <b>Reference Thermal Speed Rating (Oil)<sup>5</sup></b> | 1100 rpm |
| <b>Cg - Geometry Factor<sup>6</sup></b>                 | 0.1096   |

## Dimensions

|                              |                      |
|------------------------------|----------------------|
| <b>D - Outer Diameter</b>    | 460 mm<br>18.1100 in |
| <b>B' - Inner Ring Width</b> | 145 mm<br>5.709 in   |
| <b>B - Outer Ring Width</b>  | 145 mm<br>5.7090 in  |

## Abutment and Fillet Dimensions

|   |                         |
|---|-------------------------|
| <b>R - Inner Ring "To Clear" Radius<sup>7</sup></b> | 4 mm<br>0.160 in        |
| <b>r - Outer Ring "To Clear" Radius<sup>8</sup></b> | 4 mm<br>0.16 in         |
| <b>da - Inner Ring Backing Diameter</b>             | 273.000 mm<br>10.700 in |
| <b>Da - Outer Ring Backing Diameter</b>             | 404 mm<br>15.9000 in    |

## Basic Load Ratings

|   |                         |
|---|-------------------------|
| <b>C0 - Static Radial Rating</b>                    | 3240000 N<br>729000 lbf |
| <b>C1(2) - Dynamic Radial Rating<br/>(Two-Rows)</b> | 2740000 N<br>615000 lbf |

<sup>1</sup> These factors apply for both inch and metric calculations. Consult your Timken representative for instruction on use.

<sup>2</sup> These factors apply for both inch and metric calculations. See engineering

<sup>3</sup> These factors apply for both inch and metric calculations. Consult your Timken representative for instruction on use.

<sup>4</sup> These factors apply for both inch and metric calculations. Consult your Timken representative for instruction on use.

<sup>5</sup> See thermal speed ratings in the engineering section.

<sup>6</sup> Geometry constant for Lubrication Life Adjustment Factor a3l.

<sup>7</sup> Maximum housing fillet radius that bearing corners will clear.

<sup>8</sup> These maximum fillet radii will be cleared by the bearing corners.

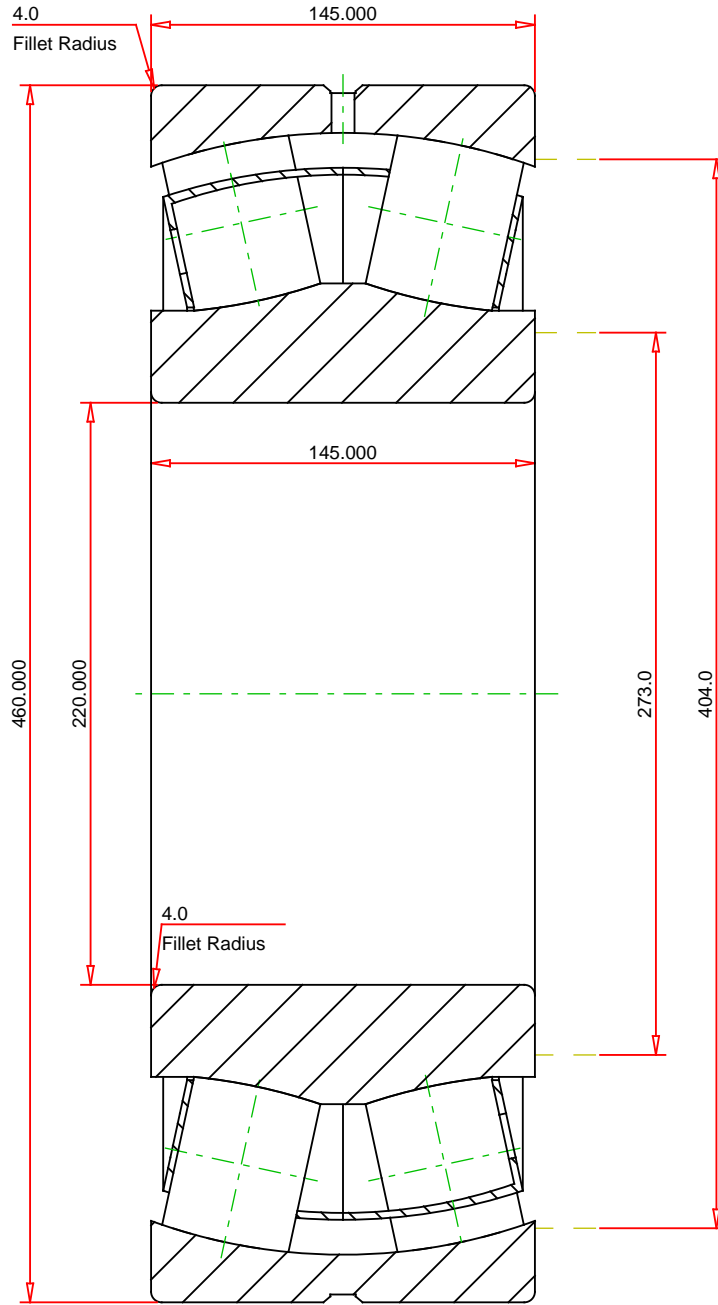

METRIC UNITS

|                           |       |
|---------------------------|-------|
| Number of Rollers Per Row | 16    |
| ISO Factor e              | 0.32  |
| ISO Factor Y0             | 2.04  |
| ISO Factor Y1             | 2.08  |
| ISO Factor Y2             | 3.10  |
| Bearing Weight            | kg    |
| Cage Type                 | EJ    |
| Cage Material             | Steel |

**TIMKEN**®

**22344EJW33W45AC6**  
SRB ASSEMBLY

**THE TIMKEN COMPANY**  
NORTH CANTON, OHIO USA

|                                  |         |   |
|----------------------------------|---------|---|
| Dynamic Radial Rating (Two Rows) | 2740000 | N |
| Static Radial Rating             | 3240000 | N |

Every reasonable effort has been made to ensure the accuracy of the information contained in this writing, but no liability is accepted for errors, omissions or for any other reason.

**FOR DISCUSSION ONLY**