

The Timken Company

4500 Mt Pleasant St. NW

N. Canton, OH 44720

Phone: (234) 262-3000

E-Mail: CustomerCAD@timken.com • **Web site:** www.timken.com
Part Number 61830-C3, Thin Section Ball Bearings (61800, 61900)

Timken's deep groove ball bearings deliver reliable performance in a wide range of applications and conditions. With super-finished raceways and controlled geometries, our premium design helps ensure consistent quality.

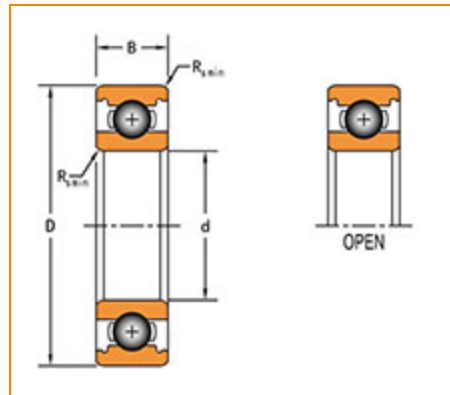

[Specifications](#) | [Dimensions](#) | [Basic Load Ratings](#) | [Factors](#)

Specifications

Clearance	C3
Bore Size d	150 mm
Features	Open

Dimensions

Outside Diameter D	190 mm
Outside Ring Width B	20 mm
Fillet Radius/Chamfer	1.1 mm



Basic Load Ratings**Cr - Dynamic Load Rating** 49100 N**C0r - Static Load Rating** 57100 N**Factors****Grease Reference Speed** 3000 rpm**Grease Limiting Speed** 3000 rpm**Oil Reference Speed** 4500 rpm

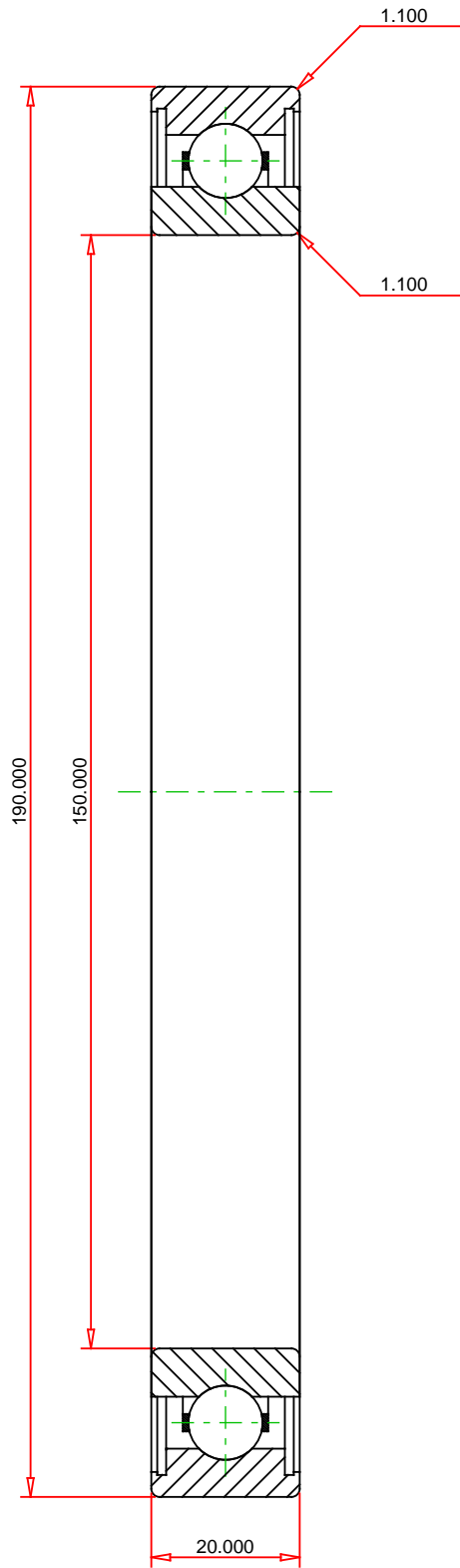

METRIC UNITS

Weight 1.17 kg

TIMKEN®

THE TIMKEN COMPANY
NORTH CANTON, OHIO USA

61830-C3
Thin Section Ball Bearings (61800, 61900)

Dynamic Load Rating 49100 N
Static Load Rating 57100 N

Every reasonable effort has been made to ensure the accuracy of the information contained in this writing, but no liability is accepted for errors, omissions or for any other reason.

FOR DISCUSSION ONLY