

The Timken Company

4500 Mt Pleasant St. NW

N. Canton, OH 44720

Phone: (234) 262-3000

E-Mail: CustomerCAD@timken.com • **Web site:** www.timken.com

Part Number IR-606832, Inner Ring (IR)

- Ideal choice where the shaft is not practical to use as inner raceway.
- Designed to meet established inch tolerances.
- Maximum shaft fillet radius cannot exceed inner-ring bore chamfer as shown.
- Optional centralized lubrication groove (bore) or through hole available – specify when ordering.
- Designed to be axially clamped against shoulder for loose transition fit on shaft.
- After mounting, for tight transition fit (keeping inner ring from rotating relative to shaft), inner-ring O.D. must not

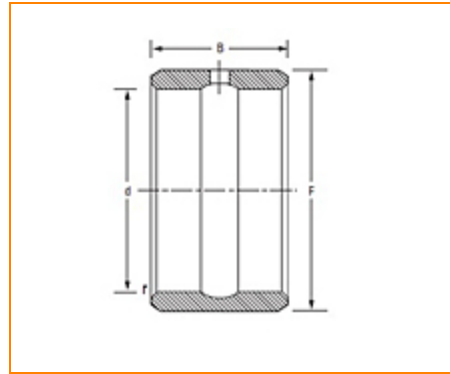
[more](#)

[Specifications](#) | [Dimensions](#) | [Sub Assembly Part Numbers](#)

Specifications

Shaft Diameter	3.750 in
Max. Loose Transition Fit S	3.7495 in 95.237 mm
Min. Loose Transition Fit S	3.7487 in 95.217 mm



Max. Interference Fit 3.7511 in
95.278 mm

Min. Interference Fit 3.7505 in
95.263 mm

Dimensions

Dimension D 3.750 in
95.25 mm

Dimension F 4.25 in
107.95 mm

Dimension B 2 in
50.8 mm

Chamfer r_{min} 0.10 in
2.54 mm

Sub Assembly Part Numbers

Used with Bearing Designation HJ-688432

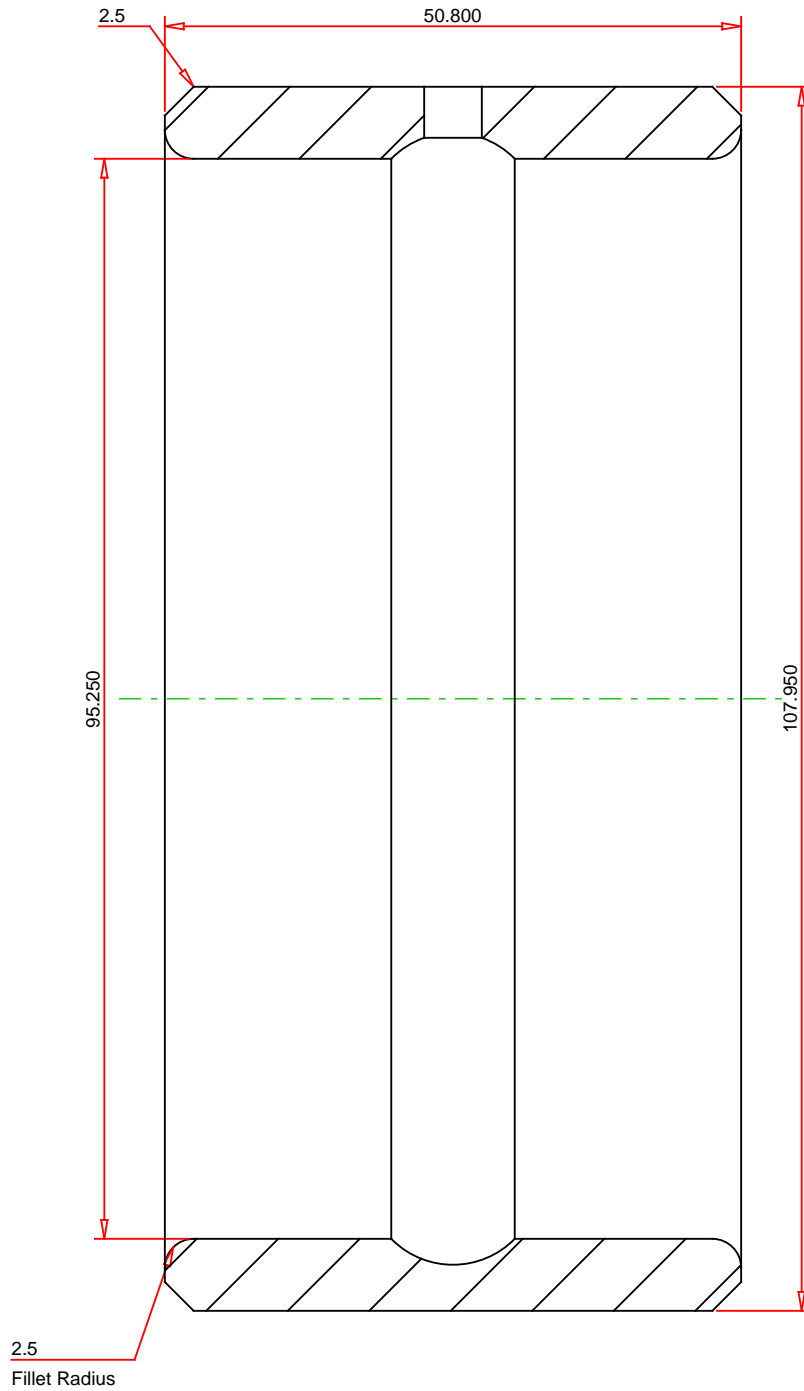

METRIC UNITS

Bearing Weight 1.0 kg

TIMKEN[®]

IR-606832
CYLINDRICAL ROLLER BEARING

THE TIMKEN COMPANY
NORTH CANTON, OHIO USA

Every reasonable effort has been made to ensure the accuracy of the information contained in this writing, but no liability is accepted for errors, omissions or for any other reason.

FOR DISCUSSION ONLY