

The Timken Company

4500 Mt Pleasant St. NW

N. Canton, OH 44720

Phone: (234) 262-3000

E-Mail: CustomerCAD@timken.com • **Web site:** www.timken.com

Part Number IR-648036, Inner Ring (IR)

- Ideal choice where the shaft is not practical to use as inner raceway.
- Designed to meet established inch tolerances.
- Maximum shaft fillet radius cannot exceed inner-ring bore chamfer as shown.
- Optional centralized lubrication groove (bore) or through hole available – specify when ordering.
- Designed to be axially clamped against shoulder for loose transition fit on shaft.
- After mounting, for tight transition fit (keeping inner ring from rotating relative to shaft), inner-ring O.D. must not

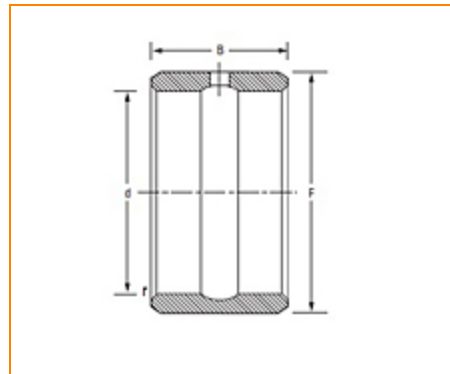
[more](#)

[Specifications](#) | [Dimensions](#) | [Sub Assembly Part Numbers](#)

Specifications

Shaft Diameter	4 in
Max. Loose Transition Fit S	3.9995 in 101.587 mm
Min. Loose Transition Fit S	3.9987 in 101.567 mm



Max. Interference Fit 4.0011 in
101.628 mm

Min. Interference Fit 4.0005 in
101.613 mm

Dimensions

Dimension D 4.000 in
101.6 mm

Dimension F 5 in
127 mm

Dimension B 2.2500 in
57.150 mm

Chamfer r_{min} 0.10 in
2.54 mm

Sub Assembly Part Numbers

Used with Bearing Designation HJ-8010436

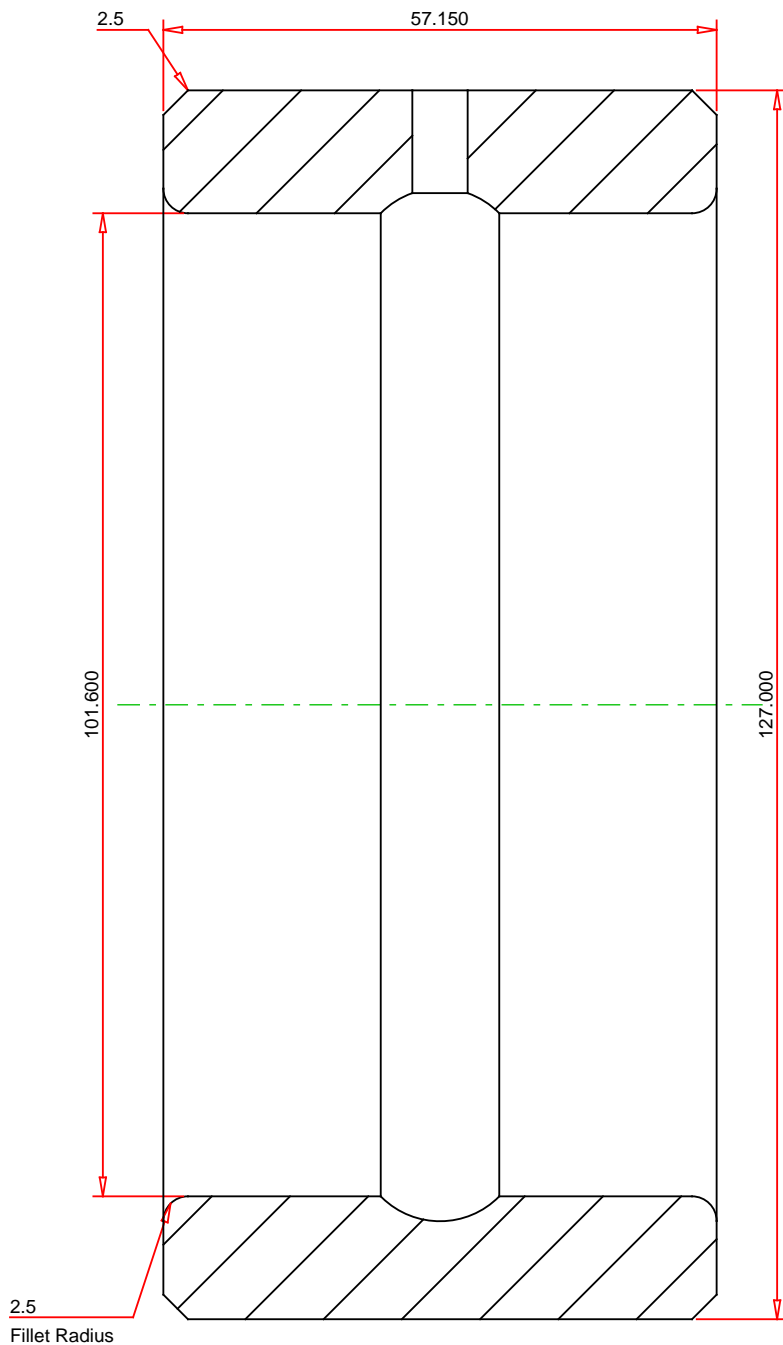

METRIC UNITS

Bearing Weight 2.0 kg

TIMKEN®

IR-648036
CYLINDRICAL ROLLER BEARING

THE TIMKEN COMPANY
NORTH CANTON, OHIO USA

Every reasonable effort has been made to ensure the accuracy of the information contained in this writing, but no liability is accepted for errors, omissions or for any other reason.

FOR DISCUSSION ONLY