

S530-COVER
 Replacement Brass
 Frame with Glass Lens

LED S530

- Composite
- 12 Volts
- PAR36 Lamp Not Included (50W Max.)
- Stainless Steel Components
- 36" 18/2 SPT1 Wire



*Stainless Steel
 Gimbel Included*

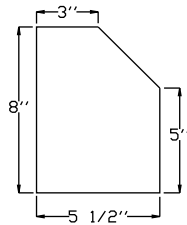

*Optional
 53L Louver*

LED 5300S

- Composite
- 12 Volts
- PAR36 Lamp Not Included (50W Max.)
- Reversible PVC Fixture
- 36" 18/2 SPT1 Wire

53L

- Optional Louver for 5300S
- Bronze Finish



Shown installed on 5300S

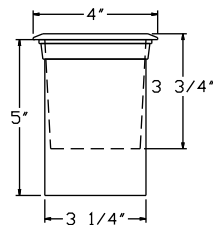

LED 5010S

- 12 Volts
- MR16 20W Lamp Included (35W Max.)
- Square Stainless Steel Cover on PVC Sleeve
- 24" SJT Cord

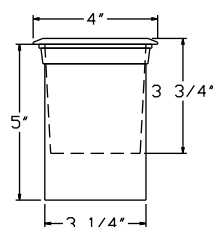

LED 5010R

- 12 Volts
- MR16 20W Lamp Included (35W Max.)
- Round Stainless Steel Cover on PVC Sleeve
- 24" SJT Cord