

# ADJUSTABLE STEEL GANTRY CRANE - KNOCKDOWN - AHSN-2-10-14

APPROX WEIGHT: 797.05 lbs.  
DOES NOT INCLUDE WEIGHT OF POWER OR PACKAGING!!!

\*\*\* ANY ADDITIONS, DELETIONS, OR OMISSIONS MUST BE CORRECTED ON THIS DRAWING AS THIS DRAWING WILL BE CONSIDERED ALL INCLUSIVE \*\*\*

ALL GRAPHICS PROVIDED ARE FOR REFERENCE ONLY. IF CERTAIN DIMENSIONS ARE CRITICAL PLEASE VERIFY THOSE DIMENSIONS WITH YOUR SALESPERSON

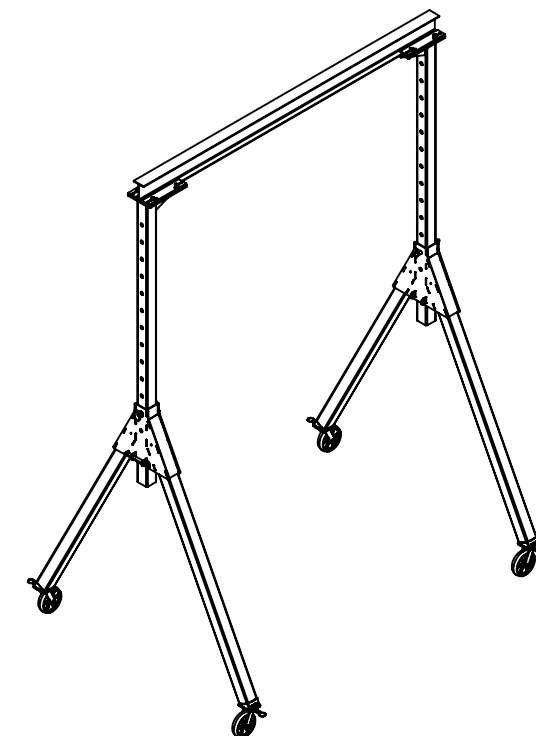
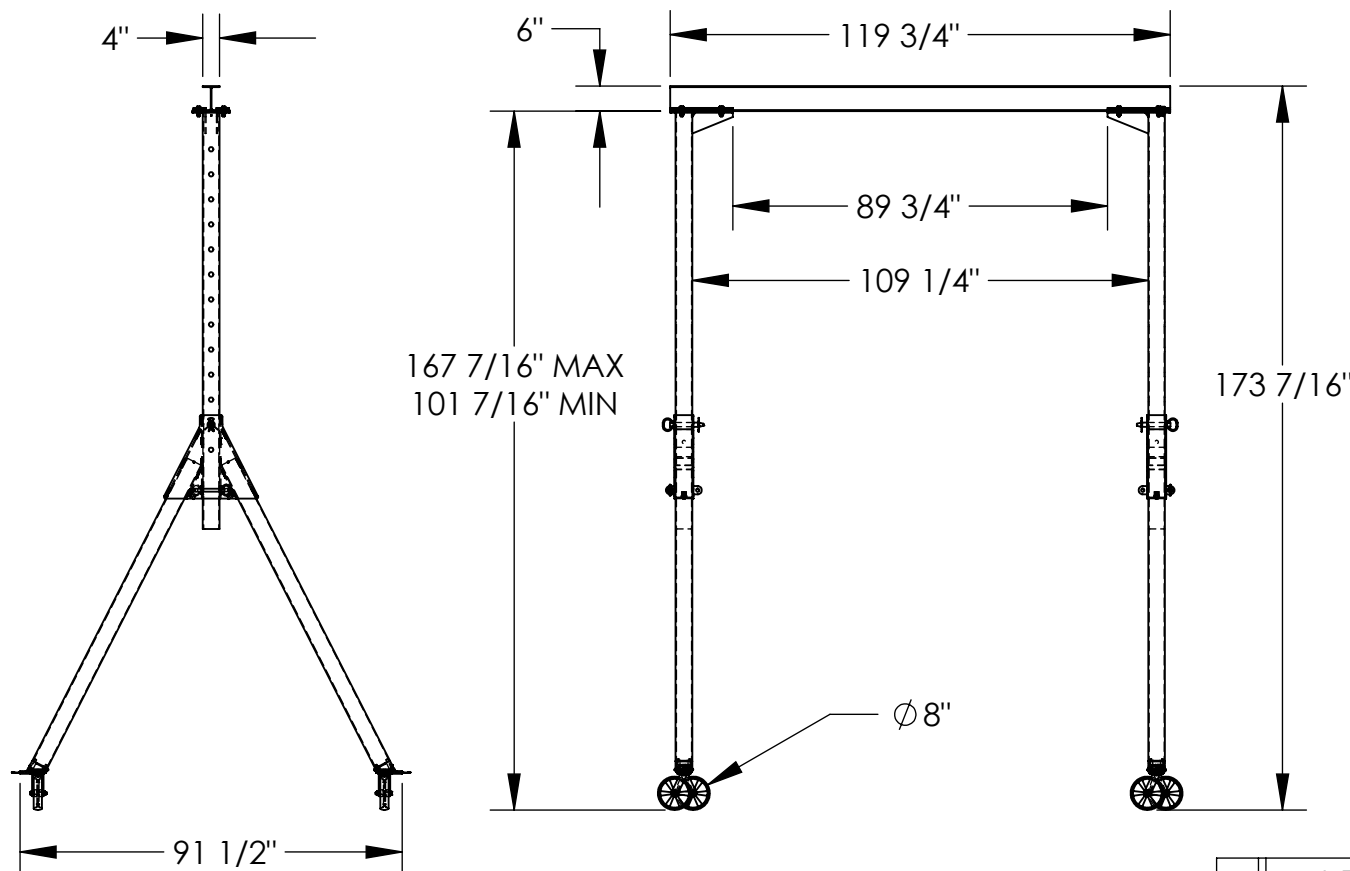

3D VIEW FOR REFERENCE ONLY  
DIMENSION TOLERANCE  $\pm 1/4"$

## STANDARD FEATURES

MODEL NUMBER IS AHSN-2-10-14  
CAPACITY IS 2,000 LBS.  
BASE WIDTH IS 91 1/2"  
MAX OVERALL HEIGHT IS 173 7/16"  
I-BEAM HEIGHT IS 6"  
I-BEAM FLANGE WIDTH IS 4"  
OVERALL I-BEAM LENGTH IS 119 3/4"  
USABLE I-BEAM LENGTH IS 89 3/4"  
ADJUSTABLE UNDER I-BEAM HEIGHT  
167 7/16" MAX  
101 7/16" MIN  
HEIGHT IS ADJUSTABLE IN 6" INCREMENTS  
CASTERS: (4) Ø8" X 2" WIDE GLASS FILLED  
NYLON SWIVEL CASTERS WITH FOUR LOCKING POSITIONS  
DURABLE LIQUID PAINT BLUE FINISH

## SPECIAL FEATURES

NONE

APPROVAL

I, THE UNDERSIGNED, AGREE THAT THE PRODUCT AS REPRESENTED SATISFIES DESIGN AND DIMENSION REQUIREMENTS. I ALSO ACKNOWLEDGE MY DUTY TO CONFIRM PRODUCT AND INSTALLATION COMPLIANCE WITH ALL APPLICABLE FEDERAL, STATE AND LOCAL REGULATIONS AND STANDARDS.  
**UNITS REQUIRING APPROVAL DRAWINGS OR MODIFIED ARE NON-RETURNABLE**  
[ ] As drawn [ ] As marked

Signed: \_\_\_\_\_ Date: \_\_\_\_\_

Printed Name: \_\_\_\_\_

LEAD TIME WILL START UPON RECEIPT OF SIGNED APPROVAL DRAWING

DISTRIBUTOR'S NAME:		P.O.#	
VESTIL MANUFACTURING		X	
DRAWN BY: MTS		W.O.#	
DATE: 06/30/2014		X	
REFERENCE: X		SALES: X	
SCALE: 1:46		FILE NAME:	
QUOTED LEAD TIME: X		28-007-299	
QUOTE #		X	