

FIXED ALUMINUM GANTRY CRANE - FHA-4-12-10

APPROX WEIGHT: 366 lbs.
DOES NOT INCLUDE WEIGHT OF POWER OR PACKAGING!!!

*** ANY ADDITIONS, DELETIONS, OR OMISSIONS MUST BE CORRECTED ON THIS DRAWING AS THIS DRAWING WILL BE CONSIDERED ALL INCLUSIVE ***

ALL GRAPHICS PROVIDED ARE FOR REFERENCE ONLY. IF CERTAIN DIMENSIONS ARE CRITICAL PLEASE VERIFY THOSE DIMENSIONS WITH YOUR SALESPERSON

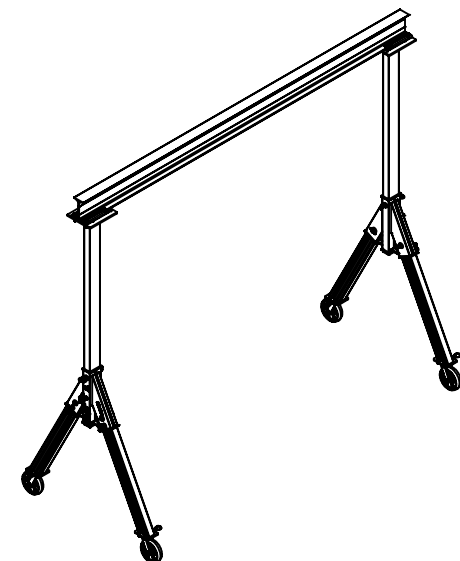
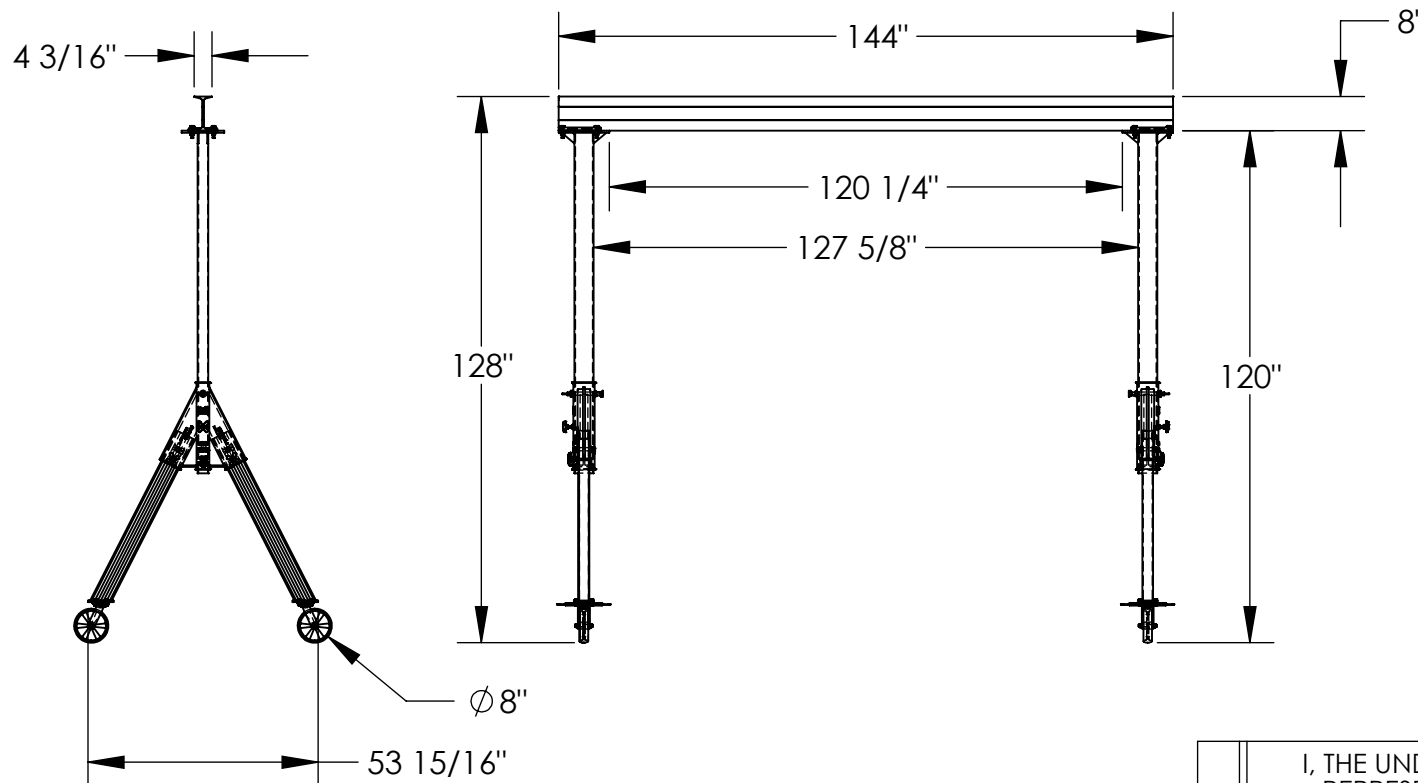

3D VIEW FOR REFERENCE ONLY

DIMENSION TOLERANCE $\pm 1/4"$

APPROVAL

I, THE UNDERSIGNED, AGREE THAT THE PRODUCT AS REPRESENTED SATISFIES DESIGN AND DIMENSION REQUIREMENTS. I ALSO ACKNOWLEDGE MY DUTY TO CONFIRM PRODUCT AND INSTALLATION COMPLIANCE WITH ALL APPLICABLE FEDERAL, STATE AND LOCAL REGULATIONS AND STANDARDS.

UNITS REQUIRING APPROVAL DRAWINGS OR MODIFIED ARE NON-RETURNABLE

[] As drawn [] As marked

Signed: _____ Date: _____

Printed Name: _____

LEAD TIME WILL START UPON RECEIPT OF SIGNED APPROVAL DRAWING

STANDARD FEATURES

MODEL NUMBER IS FHA-4-12-10

CAPACITY IS 4,000 LBS.

BASE WIDTH IS 53 15/16"

OVERALL HEIGHT IS 128"

I-BEAM HEIGHT IS 8"

I-BEAM FLANGE WIDTH IS 4 3/16"

OVERALL I-BEAM LENGTH IS 144"

USABLE I-BEAM LENGTH IS 120 1/4"

UNDER I-BEAM HEIGHT IS 120"

CASTERS: (4) Ø8" X 2" WIDE GLASS

FILLED NYLON SWIVEL CASTERS

WITH FOUR LOCKING POSITIONS

CRANE MAY BE TAKEN APART AND BUNDLED WITH

(2) INCLUDED STRAPS FOR EASY TRANSPORT

ALUMINUM CONSTRUCTION

SPECIAL FEATURES

NONE

DISTRIBUTOR'S NAME:

VESTIL MANUFACTURING

DRAWN BY: MTS

DATE: 08/18/2014

REFERENCE: X

SCALE: 1:45

QUOTED LEAD TIME: X

QUOTE # X

P.O.# X

W.O.# X

SALES: X

FILE NAME:

28-007-406