

SPECIALTY DOLLIES - KNEE-D

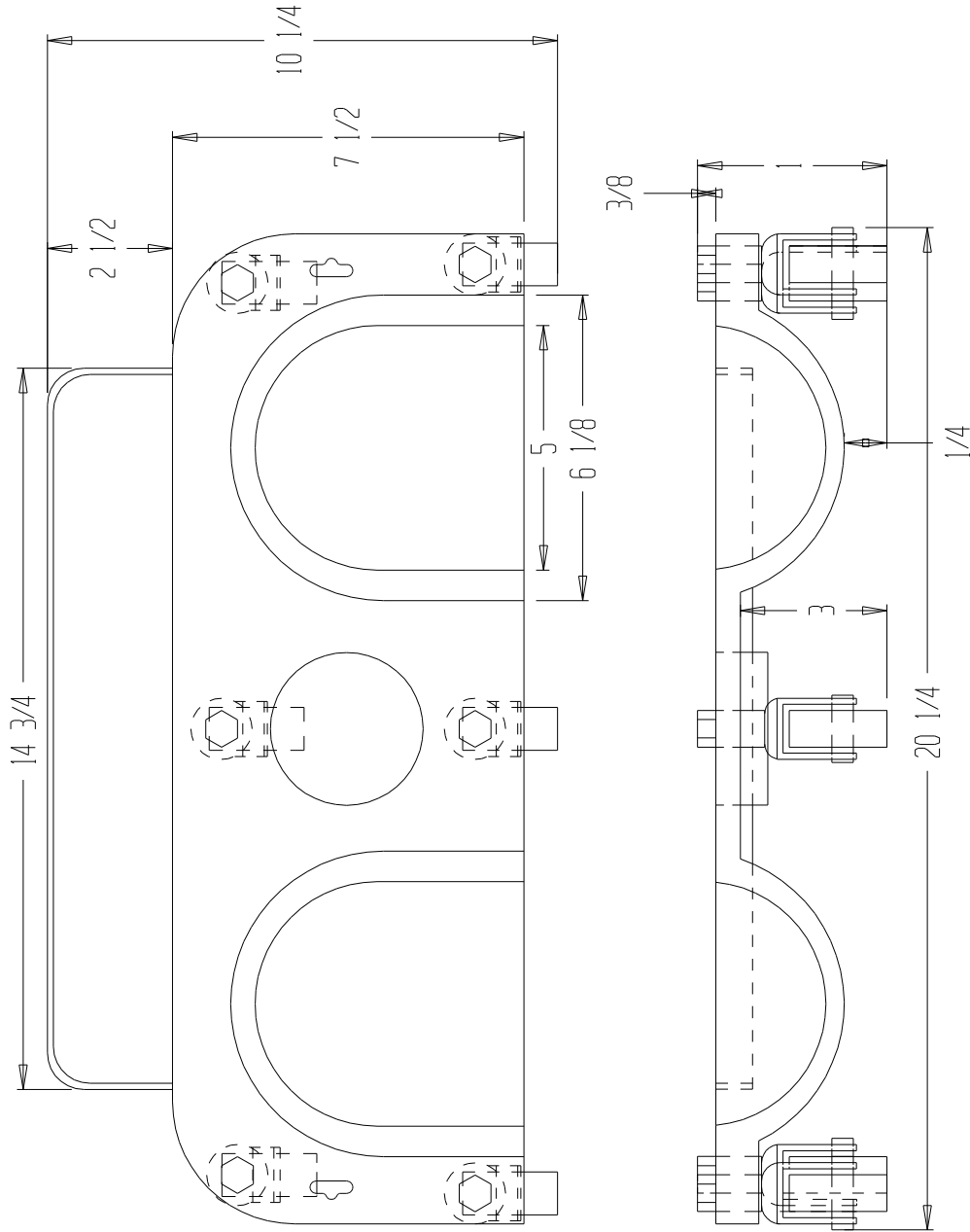

PRODUCTION WILL START UPON
RECEIPT OF SIGNED APPROVAL
DRAWING

APPROVAL

I, the undersigned, hereby approve this print
 As drawn As marked
 This includes my approval of design & dimensions.
 Signed: _____
 Date: _____

DISTRIBUTOR'S NAME: VESTIL MANUFACTURING CORP.		P.O.#:
DRAWN BY: CJD		W.O.#:
DATE: 11/08/07	SALES:	
REFERENCE:	SCALE 1 : 4	
		DRWG./FILE NAME: KNEE-D

STANDARD FEATURES

MODEL NUMBER: KNEE-D
 OVERALL SIZE: 20 1/4"W x 10"L
 MATERIALS: HARD PLASTIC, FOAM PADDING FOR KNEE'S
 COLOR: RED

SPECIAL FEATURES
 NONE

**SPECIAL UNITS ARE NON-RETURNABLE
 *AVAILABLE AT ADDITIONAL COSTS