

Repair Parts Sheet	Revision	Revision Date	Product Code Beginning
L3014	Rev. F	10/22	E

Fig. 1, Cylinder Assembly

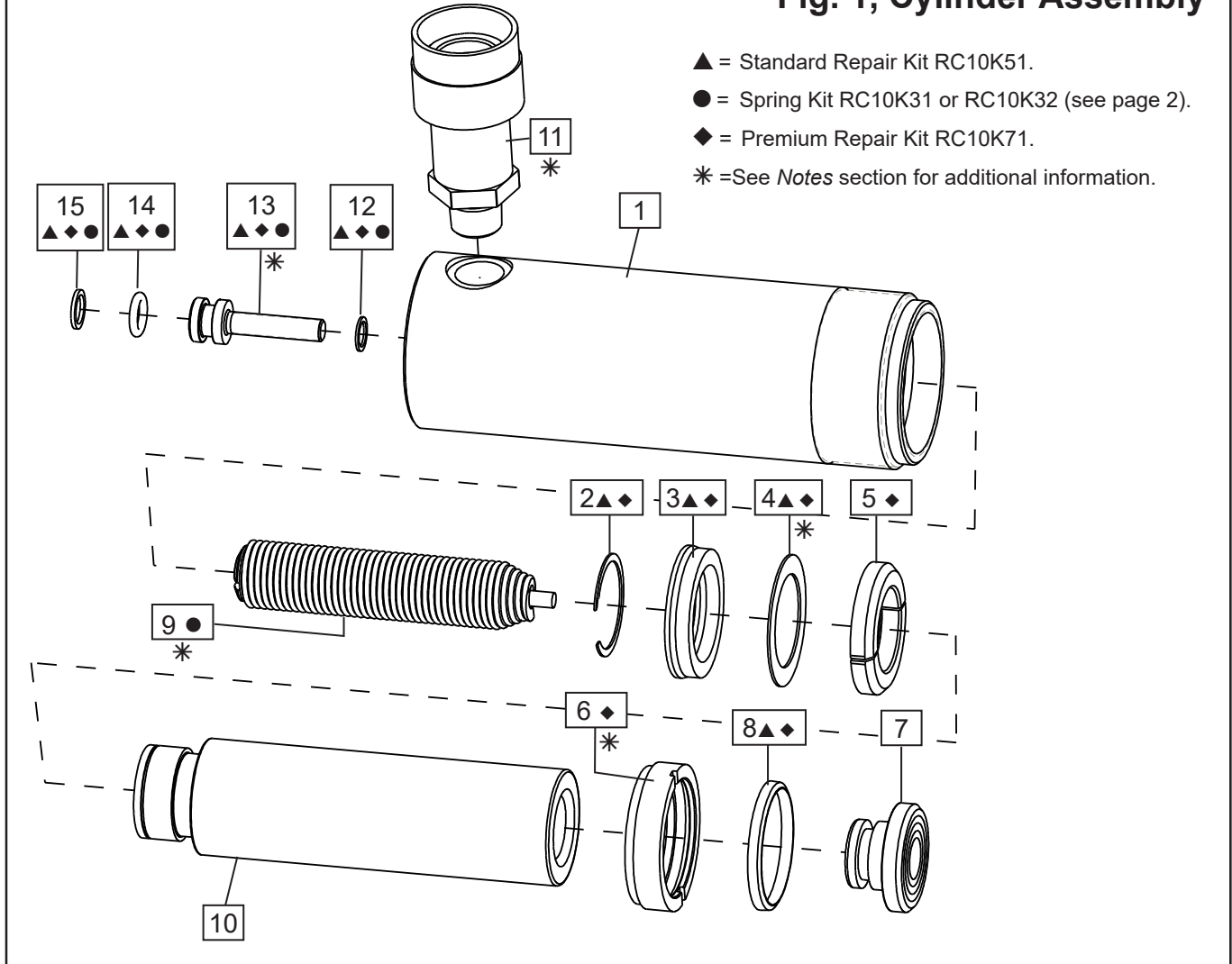

**Note: See Page 2
for parts list.**

(*) Notes	
Item	Torque / notes
4	Washer to be placed with the sharp edge towards U-Cup.
6	7.9 - 10.2 Nm, 70 - 90 In - Lbs
6	Use Loctite 222.
9	Firmly tighten spring screw to assure secure contact with the plunger.
9	5.4 - 6.8 Nm, 4 - 6 Ft - Lbs
11	54 - 81 Nm, 40 - 60 Ft - Lbs
11	Use Loctite 545 or Teflon tape.
13	10.2 - 12.4 Nm, 90 - 110 In - Lbs

Repair Parts List, Figure 1

L3014

Item	Description	Qty.	Part Number		
			RC-101	RC-102	RC-104
1	Base	1	(Not Available)	(Not Available)	(Not Available)
2	Retaining Ring ▲◆	1	C611049	C611049	C611049
3	U-Cup ▲◆	1	CB663041	CB663041	CB663041
4	Washer ▲◆	1	G384108	G384108	G384108
5	Rod Bearing ◆	1	G382107	G382107	G382107
6	Stop Ring ◆	1	G385044	G385044	G385044
7	Saddle, Grooved	1	---	A102G	A102G
8	Wiper Ring ▲◆	1	G416044	G416044	G416044
9	Spring ●	1	DD2254110	DD2254110	DD2264110
10	Plunger	1	(Not Available)	(Not Available)	(Not Available)
11	Coupler	1	CR-400	CR-400	CR-400
12	Gasket ▲◆●	2	C846037	C846037	C846037
13	Spring Retainer ▲◆●	2	DD2065160	DD2065160	DD2065160
14	O-Ring ▲◆●	2	B1110903	B1110903	B1110903
15	Ring, Back-up ▲◆●	2	B1110564	B1110564	B1110564
N/S	Dust Cap ▲◆	1	DD1782020	DD1782020	DD1782020
N/S	Thread Protector ▲◆	1	DD1774271	DD1774271	DD1774271
N/S	O-Ring Coupler ▲◆	1	B1116803	B1116803	B1116803
N/S	Enerpac Decal ▲◆	1	DD2214026	DD2214026	DD2214026
N/S	Warning Decal ▲◆	1	CH272026	CH272026	CH272026
N/S	O-Ring Saddle ▲◆	1	---	B1208503	B1208503
▲	Repair Kit, Standard	-	RC10K51	RC10K51	RC10K51
◆	Repair Kit, Premium	-	RC10K71	RC10K71	RC10K71
●	Spring Kit	-	RC10K31	RC10K31	RC10K32

Notes:

Premium repair kit includes all standard (▲) repair kit items plus additional premium (◆) items.

N/S = Item not shown.

IMPORTANT: Shaded items are available only in kits (not sold separately).

Cylinders with Viton components only: Order Repair Kit RC102KV in addition to Repair Kit RC10K51 or RC10K71. Repair Kit RC102KV includes Viton components for items 3 and 8. Standard components are used in other locations.



To maintain your warranty:

- Use only Enerpac Oil
- Have your products inspected and repaired by an Enerpac Authorized Service Center



Visit www.enerpac.com for the location of the Enerpac Authorized Service Center nearest you.